

SERVICE MANUAL

CR6.80 / CR6.90 / CR7.90 /

CR8.90 / CR9.90

Tier 4B (final)

Combine

Part number 47865347

1st edition English

April 2015



Link Product / Engine

Product	Market Product	Engine
CR6.80 TIER 4B	North America	F2CFE613C*B006
CR6.90 TIER 4B	North America	F2CFE613C*B006
CR7.90 TIER 4B	North America	F2CFE613A*B
CR8.90 TIER 4B	North America	F3GFE613B*B001
CR9.90 TIER 4B	North America	F3HFE613A*B003

Contents

INTRODUCTION

Engine	10
[10.001] Engine and crankcase	10.1
[10.202] Air cleaners and lines	10.2
[10.304] Engine lubrication system.....	10.3
[10.310] Aftercooler.....	10.4
[10.400] Engine cooling system	10.5
[10.414] Fan and drive	10.6
[10.418] Rotary screen	10.7
[10.500] Selective Catalytic Reduction (SCR) exhaust treatment.....	10.8
Main gearbox and drive	14
[14.100] Main gearbox and drive	14.1
Transmission	21
[21.114] Mechanical transmission	21.1
[21.130] Mechanical transmission external controls.....	21.2
[21.145] Gearbox internal components.....	21.3
[21.182] Differential.....	21.4
Front axle system	25
[25.100] Powered front axle	25.1
[25.108] Final drive hub, steering knuckles, and shafts	25.2
[25.310] Final drives	25.3
Rear axle system	27
[27.100] Powered rear axle.....	27.1
[27.124] Final drive hub, steering knuckles, and shafts	27.2
Hydrostatic drive	29
[29.100] Transmission and steering hydrostatic control	29.1

[29.134] Two-speed assembly	29.2
[29.202] Hydrostatic transmission	29.3
[29.204] Reservoir, cooler, and lines	29.4
[29.218] Pump and motor components.....	29.5
[29.300] Rear hydrostatic transmission.....	29.6
Brakes and controls	33
[33.110] Parking brake or parking lock	33.1
[33.202] Hydraulic service brakes	33.2
Hydraulic systems.....	35
[35.000] Hydraulic systems.....	35.1
[35.102] Pump control valves.....	35.2
[35.106] Variable displacement pump	35.3
[35.220] Auxiliary hydraulic pump and lines	35.4
[35.300] Reservoir, cooler, and filters.....	35.5
[35.359] Main control valve.....	35.6
[35.410] Header or attachment height system	35.7
[35.440] Grain tank unload system	35.8
[35.450] Traction variator system.....	35.9
[35.518] Reel control system	35.10
[35.536] Crop processor system	35.11
[35.602] Header or attachment leveling system	35.12
[35.760] Header reverser drive	35.13
[35.796] Chaff spreader control	35.14
Pneumatic system	36
[36.100] Pneumatic system.....	36.1
Steering.....	41
[41.101] Steering control	41.1
[41.200] Hydraulic control components.....	41.2

[41.206] Pump	41.3
[41.216] Cylinders	41.4
[41.432] Autoguidance steering	41.5
Tracks and track suspension	48
[48.100] Tracks	48.1
[48.130] Track frame and driving wheels	48.2
[48.134] Track tension units	48.3
[48.138] Track rollers	48.4
Cab climate control	50
[50.100] Heating	50.1
[50.104] Ventilation	50.2
[50.200] Air conditioning	50.3
Electrical systems	55
[55.000] Electrical system	55.1
[55.050] Heating, Ventilation, and Air-Conditioning (HVAC) control system.....	55.2
[55.100] Harnesses and connectors.....	55.3
[55.201] Engine starting system	55.4
[55.301] Alternator	55.5
[55.302] Battery.....	55.6
[55.408] Warning indicators, alarms, and instruments	55.7
[55.421] Feeding control system	55.8
[55.423] Cleaning control system.....	55.9
[55.426] Harvest material flow control system.....	55.10
[55.610] Ground speed control	55.11
[55.624] Residue handling control.....	55.12
[55.640] Electronic modules	55.13
[55.662] Header height control	55.14
[55.675] Reel speed and position control.....	55.15

[55.780] Shaker shoe leveling system control.....	55.16
[55.785] Precision farming system	55.17
[55.988] Selective Catalytic Reduction (SCR) electrical system	55.18
[55.DTC] FAULT CODES.....	55.19
Product feeding	60
[60.105] Floating roll, feed chain, and drive	60.1
[60.110] Feeder housing	60.2
[60.112] Stone trapping system	60.3
[60.130] Feeder housing shafts	60.4
[60.150] Feeder drive system	60.5
Threshing	66
[66.000] Threshing	66.1
[66.101] Concave conveyor plate	66.2
[66.105] Concave.....	66.3
[66.110] Concave control system.....	66.4
[66.260] Threshing mechanism drive system	66.5
[66.321] Drum/Rotor variator with electrical control	66.6
[66.331] Rotor	66.7
[66.360] Drum/Rotor housing.....	66.8
Separation	72
[72.101] Straw walkers and shafts	72.1
[72.110] Straw walker drive system	72.2
[72.220] Discharge beater.....	72.3
[72.350] Beater	72.4
[72.420] Rotary separator	72.5
Residue handling.....	73
[73.210] Straw chopper drive system.....	73.1
[73.220] Straw chopper frame	73.2

[73.230] Straw chopper.....	73.3
[73.300] Positive Straw Discharge (PSD)	73.4
[73.335] Chaff spreader	73.5
[73.410] Opti-Spread™ system.....	73.6
Cleaning	74
[74.000] Cleaning.....	74.1
[74.100] Self-leveling frame	74.2
[74.101] Cleaning drive systems	74.3
[74.110] Grain pan.....	74.4
[74.114] Upper shaker shoe	74.5
[74.118] Lower shaker shoe	74.6
[74.130] Fan housing	74.7
[74.136] Fan drive system	74.8
[74.140] Tailings return system	74.9
Crop storage / Unloading	80
[80.101] Clean grain elevator.....	80.1
[80.150] Grain tank	80.2
[80.175] Grain tank unload drive system	80.3
[80.180] Grain tank unload	80.4
Platform, cab, bodywork, and decals	90
[90.100] Engine hood and panels	90.1
[90.105] Machine shields and guards	90.2
[90.118] Protections and footboards.....	90.3
[90.124] Pneumatically-adjusted operator seat.....	90.4
[90.150] Cab.....	90.5
[90.151] Cab interior.....	90.6



INTRODUCTION

Contents

INTRODUCTION

Foreword - Important notice regarding equipment servicing	3
Foreword - Note to the dealer	4
Safety rules (*)	5
Header or attachment height system - Personal safety	6
Personal safety – Emergency exit	7
Safety rules - Ecology and the environment	8
Personal safety - Do not operate tag	9
Torque - Minimum tightening torques for normal assembly	10
Torque - Standard torque data for hydraulics	15
Basic instructions - Shop and assembly	17
Basic instructions – Hydraulic contamination	19
General specification	20
Dimension	28
Product identification	31
Product identification – Machine orientation	32

(*) See content for specific models

Foreword - Important notice regarding equipment servicing

All repair and maintenance work listed in this manual must be carried out only by qualified dealership personnel, strictly complying with the instructions given, and using, whenever possible, the special tools.

Anyone who performs repair and maintenance operations without complying with the procedures provided herein shall be responsible for any subsequent damages.

The manufacturer and all the organizations of its distribution chain, including - without limitation - national, regional, or local dealers, reject any responsibility for damages caused by parts and/or components not approved by the manufacturer, including those used for the servicing or repair of the product manufactured or marketed by the manufacturer. In any case, no warranty is given or attributed on the product manufactured or marketed by the manufacturer in case of damages caused by parts and/or components not approved by the manufacturer.

The manufacturer reserves the right to make improvements in design and changes in specifications at any time without notice and without incurring any obligation to install them on units previously sold. Specifications, descriptions, and illustrative material herein are as accurate as known at time of publication but are subject to change without notice.

In case of questions, refer to your NEW HOLLAND Sales and Service Networks.

Foreword - Note to the dealer

Company policy

Company policy, which is one of continuous improvement, reserves the right to make changes in design and specifications at any time without notice and without obligation to modify units previously built.

All data given in this book is subject to production variations. Dimensions and weights are approximate only and the illustrations do not necessarily show windrowers in standard condition.

Parts and accessories

Genuine NEW HOLLAND parts and accessories have been specifically designed for NEW HOLLAND MACHINES.

We would like to point out those "NON-GENUINE" parts and accessories have not been examined and released by NEW HOLLAND. The installation and or use of such products could have negative effects upon the design characteristics of your machine and thereby affect its safety. NEW HOLLAND is not liable for any damage caused by the use of "NON-GENUINE" NEW HOLLAND parts and accessories.

Lubrication

Adequate lubrication and maintenance on a regular schedule is vital to maintaining your equipment. To ensure long service and efficient operation, follow the lubrication and maintenance schedules outlined in this manual. The use of proper fuels, oils, grease and filters, as well as keeping the systems clean, will also extend machine and component life.

NOTICE: Always use genuine NEW HOLLAND replacement parts, oils and filters to ensure proper operation, filtration of engine and hydraulic systems. See your NEW HOLLAND dealer for additional oil quantities.

Safety rules

CR6.80	NA
CR6.90	NA
CR7.90	NA
CR8.90	NA
CR9.90	NA

Personal safety





This is the safety alert symbol. It is used to alert you to potential personal injury hazards. Obey all safety messages that follow this symbol to avoid possible death or injury.

Throughout this manual you will find the signal words DANGER, WARNING, and CAUTION followed by special instructions. These precautions are intended for the personal safety of you and those working with you.

Read and understand all the safety messages in this manual before you operate or service the machine.

 DANGER indicates a hazardous situation that, if not avoided, will result in death or serious injury.

 WARNING indicates a hazardous situation that, if not avoided, could result in death or serious injury.

 CAUTION indicates a hazardous situation that, if not avoided, could result in minor or moderate injury.

FAILURE TO FOLLOW DANGER, WARNING, AND CAUTION MESSAGES COULD RESULT IN DEATH OR SERIOUS INJURY.

Machine safety

NOTICE: Notice indicates a situation that, if not avoided, could result in machine or property damage.

Throughout this manual you will find the signal word Notice followed by special instructions to prevent machine or property damage. The word Notice is used to address practices not related to personal safety.

Information

NOTE: Note indicates additional information that clarifies steps, procedures, or other information in this manual.

Throughout this manual you will find the word Note followed by additional information about a step, procedure, or other information in the manual. The word Note is not intended to address personal safety or property damage.

Header or attachment height system - Personal safety

⚠ DANGER

Crushing hazard!

Always do the following before you enter the area below the header and/or feeder:

- Disengage the threshing mechanism.
 - Lift the header to its maximum height.
 - Apply the parking brake.
 - Stop the engine.
 - Place the lift cylinder lockout over the cylinder rod.
- Failure to comply will result in death or serious injury.**

D0158B

The left-hand cylinder is fitted with a lift cylinder lockout which must be lowered onto the cylinder rod to prevent accidental lowering of the header/feeder.

Whenever work is carried out underneath the header/feeder, the lockout must be lowered onto the cylinder rod as shown at (1).

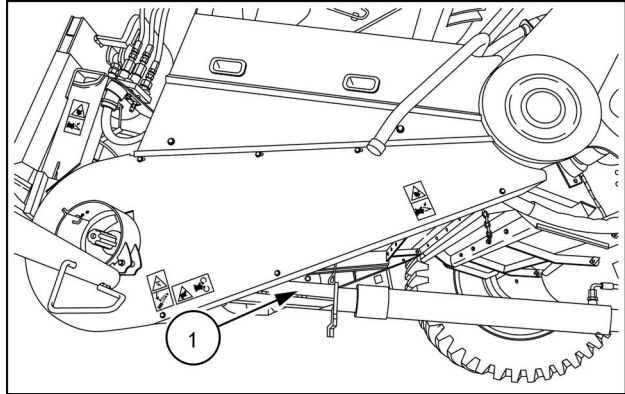

ZEIL14CR00308AA 1

Engage the lift cylinder lockout (1) by unhooking the lift cylinder lockout (1) from the hook (2) as shown.

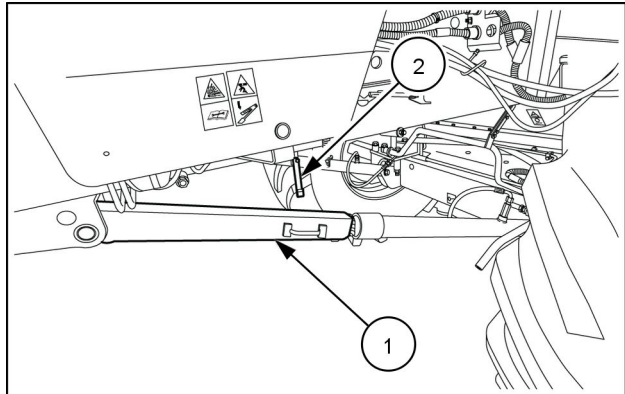

ZEIL13II00122AB 2

To engage or disengage the lift cylinder lockout it is necessary to lift the feeder to its maximum height.

1. Select field mode using the field/road mode selector switch.
2. Move the feeder up by pressing on the top of the header height rocker switch (2) on the multifunction handle until the header stops near its maximum height.
3. Release the switch and press again for a minimum of 1.5 s. The header will now move quickly until its maximum height.

NOTICE: Make sure you lower the reel on grain headers BEFORE raising the header/feeder all the way to its maximum height.

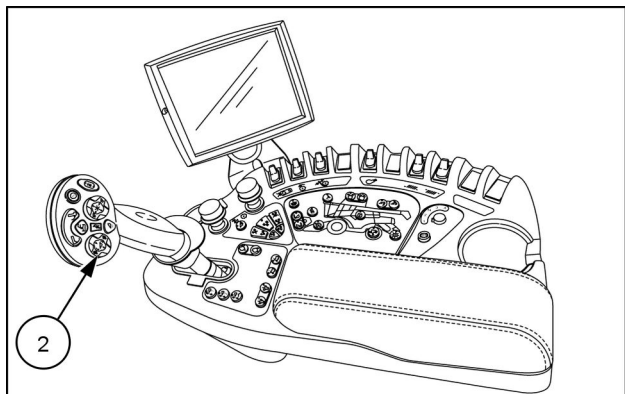

ZEIL14CR00105AA 3

4. Place the lift cylinder lockout over the cylinder rod.

NOTICE: Never use lift cylinder lockout (1) as a support for the header when travelling along public roads otherwise damage may occur to the cylinder.

Personal safety – Emergency exit

The emergency exit is to be found on the right-hand side of the operator's seat, opposite to the door that gives access to the cab.

To escape from the cab through the emergency exit, proceed as follows:

- Unlock the emergency exit door handle **(1)** in three steps.
 1. Flip down the handle **(1)** until it is in horizontal position.
 2. Push the door slightly open until the metal pin that is attached to the cab frame is visible through the notch in the handle.
 3. Flip up the handle in order to release the handle from the pin.
- Open the emergency exit door completely.
- Step over or around the right-hand console and leave the cab.
- Use the handrail **(1)** as hand hold.

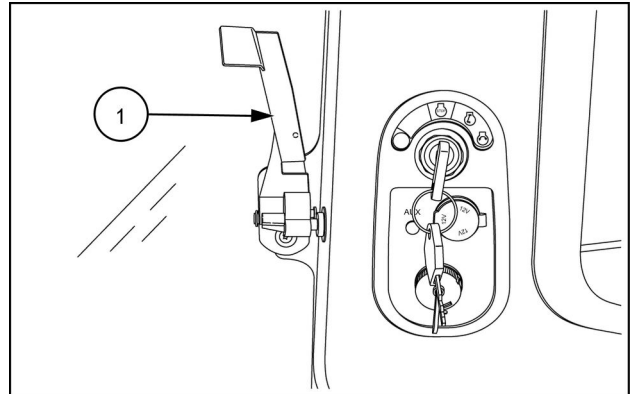

ZEIL14CR00059AA 1

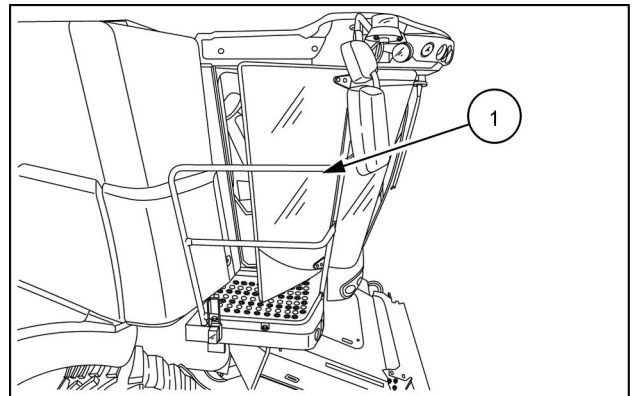

ZEIL14CR00085AA 2

An additional notch **(2)** is provided in the emergency exit door handle **(1)** to set the door in a fixed partially open position.

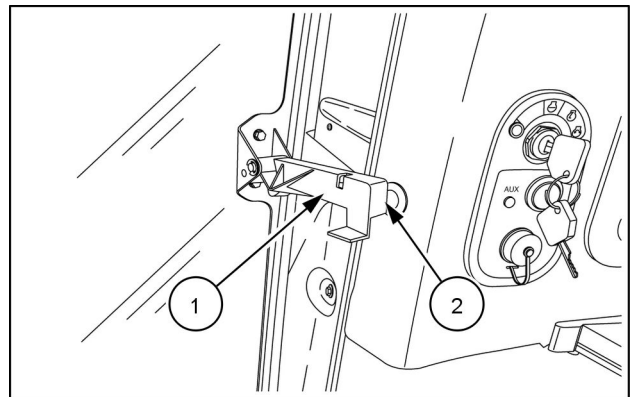

ZEIL14CR00104AA 3

Safety rules - Ecology and the environment

Soil, air, and water quality is important for all industries and life in general. When legislation does not yet rule the treatment of some of the substances that advanced technology requires, sound judgment should govern the use and disposal of products of a chemical and petrochemical nature.

Familiarize yourself with the relative legislation applicable to your country, and make sure that you understand this legislation. Where no legislation exists, obtain information from suppliers of oils, filters, batteries, fuels, anti-freeze, cleaning agents, etc., with regard to the effect of these substances on man and nature and how to safely store, use, and dispose of these substances.

Helpful hints

- Avoid the use of cans or other inappropriate pressurized fuel delivery systems to fill tanks. Such delivery systems may cause considerable spillage.
- In general, avoid skin contact with all fuels, oils, acids, solvents, etc. Most of these products contain substances that may be harmful to your health.
- Modern oils contain additives. Do not burn contaminated fuels and or waste oils in ordinary heating systems.
- Avoid spillage when you drain fluids such as used engine coolant mixtures, engine oil, hydraulic fluid, brake fluid, etc. Do not mix drained brake fluids or fuels with lubricants. Store all drained fluids safely until you can dispose of the fluids in a proper way that complies with all local legislation and available resources.
- Do not allow coolant mixtures to get into the soil. Collect and dispose of coolant mixtures properly.
- The air-conditioning system contains gases that should not be released into the atmosphere. Consult an air-conditioning specialist or use a special extractor to recharge the system properly.
- Repair any leaks or defects in the engine cooling system or hydraulic system immediately.
- Do not increase the pressure in a pressurized circuit as this may lead to a component failure.
- Protect hoses during welding. Penetrating weld splatter may burn a hole or weaken hoses, allowing the loss of oils, coolant, etc.

Battery recycling

Batteries and electric accumulators contain several substances that can have a harmful effect on the environment if the batteries are not properly recycled after use. Improper disposal of batteries can contaminate the soil, groundwater, and waterways. NEW HOLLAND strongly recommends that you return all used batteries to a NEW HOLLAND dealer, who will dispose of the used batteries or recycle the used batteries properly. In some countries, this is a legal requirement.



Mandatory battery recycling

NOTE: *The following requirements are mandatory in Brazil.*

Batteries are made of lead plates and a sulfuric acid solution. Because batteries contain heavy metals such as lead, CONAMA Resolution 401/2008 requires you to return all used batteries to the battery dealer when you replace any batteries. Do not dispose of batteries in your household garbage.

Points of sale are obliged to:

- Accept the return of your used batteries
- Store the returned batteries in a suitable location
- Send the returned batteries to the battery manufacturer for recycling

Personal safety - Do not operate tag

▲ WARNING

Avoid injury! Always do the following before lubricating, maintaining, or servicing the machine.

1. Disengage all drives.
2. Engage parking brake.
3. Lower all attachments to the ground, or raise and engage all safety locks.
4. Shut off engine.
5. Remove key from key switch.
6. Switch off battery key, if installed.
7. Wait for all machine movement to stop.

Failure to comply could result in death or serious injury.

W0047A

Before you service the machine, put a DO NOT OPERATE tag on the instrument panel.

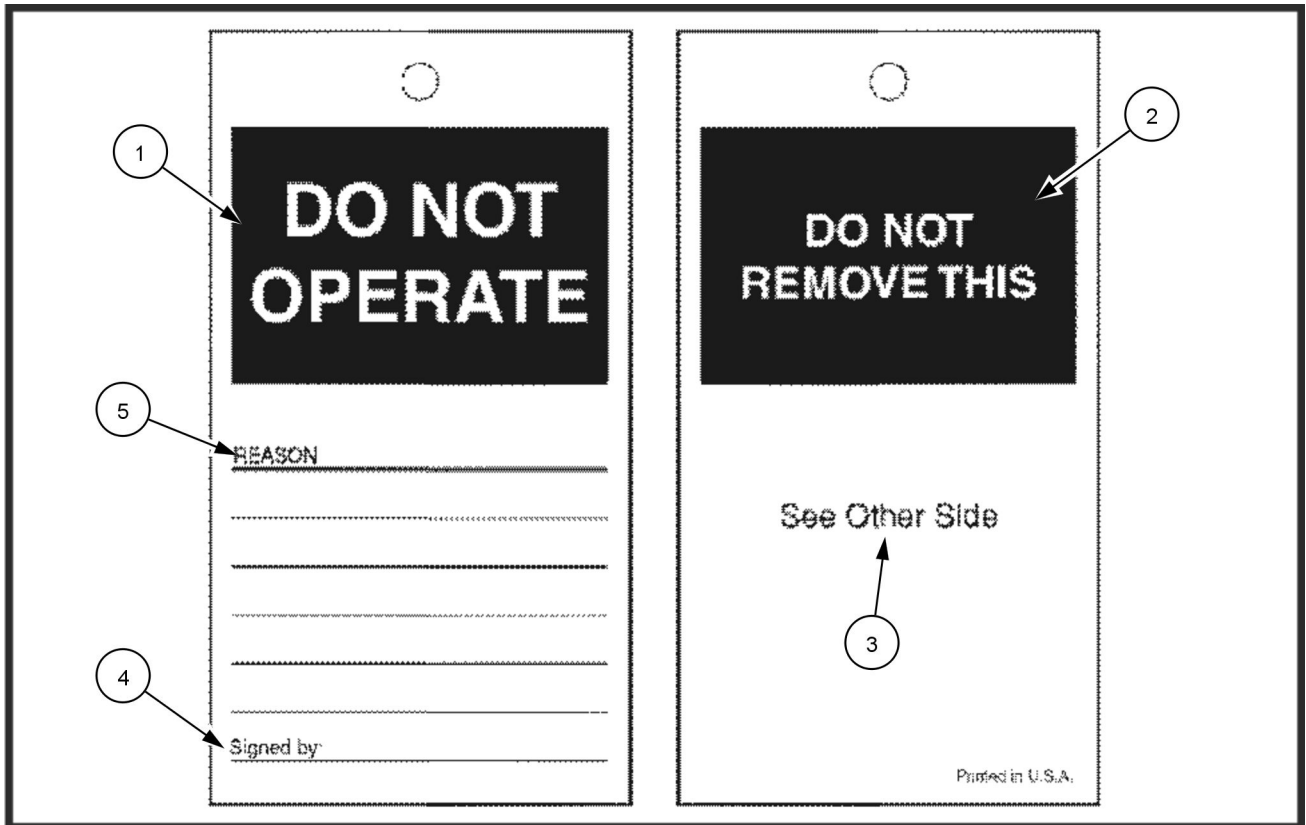

321_4614 1

DO NOT OPERATE TAG

- A. (1) Do not operate.
- B. (2) Do not remove this.
- C. (3) See other side.
- D. (4) Signed by.
- E. (5) Reason

The DO NOT OPERATE tag can be obtained from your NEW HOLLAND dealer.

Torque - Minimum tightening torques for normal assembly

METRIC NON-FLANGED HARDWARE

NOM. SIZE	CLASS 8.8 BOLT and CLASS 8 NUT		CLASS 10.9 BOLT and CLASS 10 NUT		LOCKNUT CL.8 W/CL8.8 BOLT	LOCKNUT CL.10 W/CL10.9 BOLT
	UNPLATED	PLATED W/ZnCr	UNPLATED	PLATED W/ZnCr		
M4	2.2 N·m (19 lb in)	2.9 N·m (26 lb in)	3.2 N·m (28 lb in)	4.2 N·m (37 lb in)	2 N·m (18 lb in)	2.9 N·m (26 lb in)
M5	4.5 N·m (40 lb in)	5.9 N·m (52 lb in)	6.4 N·m (57 lb in)	8.5 N·m (75 lb in)	4 N·m (36 lb in)	5.8 N·m (51 lb in)
M6	7.5 N·m (66 lb in)	10 N·m (89 lb in)	11 N·m (96 lb in)	15 N·m (128 lb in)	6.8 N·m (60 lb in)	10 N·m (89 lb in)
M8	18 N·m (163 lb in)	25 N·m (217 lb in)	26 N·m (234 lb in)	35 N·m (311 lb in)	17 N·m (151 lb in)	24 N·m (212 lb in)
M10	37 N·m (27 lb ft)	49 N·m (36 lb ft)	52 N·m (38 lb ft)	70 N·m (51 lb ft)	33 N·m (25 lb ft)	48 N·m (35 lb ft)
M12	64 N·m (47 lb ft)	85 N·m (63 lb ft)	91 N·m (67 lb ft)	121 N·m (90 lb ft)	58 N·m (43 lb ft)	83 N·m (61 lb ft)
M16	158 N·m (116 lb ft)	210 N·m (155 lb ft)	225 N·m (166 lb ft)	301 N·m (222 lb ft)	143 N·m (106 lb ft)	205 N·m (151 lb ft)
M20	319 N·m (235 lb ft)	425 N·m (313 lb ft)	440 N·m (325 lb ft)	587 N·m (433 lb ft)	290 N·m (214 lb ft)	400 N·m (295 lb ft)
M24	551 N·m (410 lb ft)	735 N·m (500 lb ft)	762 N·m (560 lb ft)	1016 N·m (750 lb ft)	501 N·m (370 lb ft)	693 N·m (510 lb ft)

NOTE: M4 through M8 hardware torque specifications are shown in pound-inches. M10 through M24 hardware torque specifications are shown in pound-feet.

METRIC FLANGED HARDWARE

NOM. SIZE	CLASS 8.8 BOLT and CLASS 8 NUT		CLASS 10.9 BOLT and CLASS 10 NUT		LOCKNUT CL.8 W/CL8.8 BOLT	LOCKNUT CL.10 W/CL10.9 BOLT
	UNPLATED	PLATED W/ZnCr	UNPLATED	PLATED W/ZnCr		
M4	2.4 N·m (21 lb in)	3.2 N·m (28 lb in)	3.5 N·m (31 lb in)	4.6 N·m (41 lb in)	2.2 N·m (19 lb in)	3.1 N·m (27 lb in)
M5	4.9 N·m (43 lb in)	6.5 N·m (58 lb in)	7.0 N·m (62 lb in)	9.4 N·m (83 lb in)	4.4 N·m (39 lb in)	6.4 N·m (57 lb in)
M6	8.3 N·m (73 lb in)	11 N·m (96 lb in)	12 N·m (105 lb in)	16 N·m (141 lb in)	7.5 N·m (66 lb in)	11 N·m (96 lb in)
M8	20 N·m (179 lb in)	27 N·m (240 lb in)	29 N·m (257 lb in)	39 N·m (343 lb in)	18 N·m (163 lb in)	27 N·m (240 lb in)
M10	40 N·m (30 lb ft)	54 N·m (40 lb ft)	57 N·m (42 lb ft)	77 N·m (56 lb ft)	37 N·m (27 lb ft)	53 N·m (39 lb ft)
M12	70 N·m (52 lb ft)	93 N·m (69 lb ft)	100 N·m (74 lb ft)	134 N·m (98 lb ft)	63 N·m (47 lb ft)	91 N·m (67 lb ft)
M16	174 N·m (128 lb ft)	231 N·m (171 lb ft)	248 N·m (183 lb ft)	331 N·m (244 lb ft)	158 N·m (116 lb ft)	226 N·m (167 lb ft)
M20	350 N·m (259 lb ft)	467 N·m (345 lb ft)	484 N·m (357 lb ft)	645 N·m (476 lb ft)	318 N·m (235 lb ft)	440 N·m (325 lb ft)
M24	607 N·m (447 lb ft)	809 N·m (597 lb ft)	838 N·m (618 lb ft)	1118 N·m (824 lb ft)	552 N·m (407 lb ft)	

IDENTIFICATION

Metric Hex head and carriage bolts, classes 5.6 and up

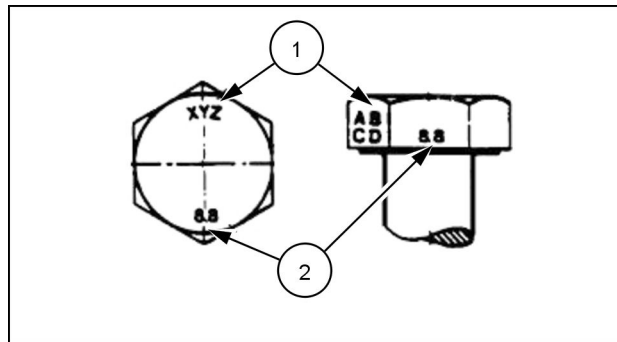

20083680 1

1. Manufacturer's Identification
2. Property Class

Metric Hex nuts and locknuts, classes 05 and up

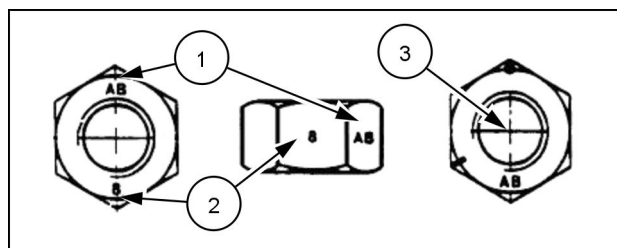

20083681 2

1. Manufacturer's Identification
2. Property Class
3. Clock Marking of Property Class and Manufacturer's Identification (Optional), i.e. marks **60 °** apart indicate Class 10 properties, and marks **120 °** apart indicate Class 8.

INCH NON-FLANGED HARDWARE

NOMINAL SIZE	SAE GRADE 5 BOLT and NUT		SAE GRADE 8 BOLT and NUT		LOCKNUT GrB W/ Gr5 BOLT	LOCKNUT GrC W/ Gr8 BOLT
	UN-PLATED or PLATED SILVER	PLATED W/ZnCr GOLD	UN-PLATED or PLATED SILVER	PLATED W/ZnCr GOLD		
1/4	8 N·m (71 lb in)	11 N·m (97 lb in)	12 N·m (106 lb in)	16 N·m (142 lb in)	8.5 N·m (75 lb in)	12.2 N·m (109 lb in)
5/16	17 N·m (150 lb in)	23 N·m (204 lb in)	24 N·m (212 lb in)	32 N·m (283 lb in)	17.5 N·m (155 lb in)	25 N·m (220 lb in)
3/8	30 N·m (22 lb ft)	40 N·m (30 lb ft)	43 N·m (31 lb ft)	57 N·m (42 lb ft)	31 N·m (23 lb ft)	44 N·m (33 lb ft)
7/16	48 N·m (36 lb ft)	65 N·m (48 lb ft)	68 N·m (50 lb ft)	91 N·m (67 lb ft)	50 N·m (37 lb ft)	71 N·m (53 lb ft)
1/2	74 N·m (54 lb ft)	98 N·m (73 lb ft)	104 N·m (77 lb ft)	139 N·m (103 lb ft)	76 N·m (56 lb ft)	108 N·m (80 lb ft)
9/16	107 N·m (79 lb ft)	142 N·m (105 lb ft)	150 N·m (111 lb ft)	201 N·m (148 lb ft)	111 N·m (82 lb ft)	156 N·m (115 lb ft)
5/8	147 N·m (108 lb ft)	196 N·m (145 lb ft)	208 N·m (153 lb ft)	277 N·m (204 lb ft)	153 N·m (113 lb ft)	215 N·m (159 lb ft)
3/4	261 N·m (193 lb ft)	348 N·m (257 lb ft)	369 N·m (272 lb ft)	491 N·m (362 lb ft)	271 N·m (200 lb ft)	383 N·m (282 lb ft)
7/8	420 N·m (310 lb ft)	561 N·m (413 lb ft)	594 N·m (438 lb ft)	791 N·m (584 lb ft)	437 N·m (323 lb ft)	617 N·m (455 lb ft)
1	630 N·m (465 lb ft)	841 N·m (620 lb ft)	890 N·m (656 lb ft)	1187 N·m (875 lb ft)	654 N·m (483 lb ft)	924 N·m (681 lb ft)

NOTE: For Imperial Units, *1/4 in* and *5/16 in* hardware torque specifications are shown in pound-inches. *3/8 in* through *1 in* hardware torque specifications are shown in pound-feet.

**Thanks very much for your reading,
Want to get more information,
Please click here, Then get the complete
manual**

JustClickHere 

NOTE:

**If there is no response to click on the link above,
please download the PDF document first, and then
click on it.**

**Have any questions please write to me:
admin@servicemanualperfect.com**