

**4720 SPRAYER**



**JOHN DEERE**

**PARTS CATALOG**

**4720 SPRAYER**

**PC9325 (MAR-06) English**

**John Deere Des Moines Works**

North American Edition

Litho in U.S.A. (Revised)

COPYRIGHT © 2006

DEERE & COMPANY

Moline, Illinois

All rights reserved



NP13985

-UN-18MAY04



*JOHN DEERE 4720 SELF-PROPELLED SPRAYER  
(MANUFACTURED 2004- )*

*(SPECIFICATIONS AND DESIGN ARE SUBJECT TO CHANGE WITHOUT NOTICE)*

## PRODUCT IDENTIFICATION NUMBER LISTING INFORMATION

THE SPRAYER PRODUCT IDENTIFICATION NUMBER PLATE IS LOCATED ON THE LEFT SIDE OF THE FRAME, BEHIND THE CAB SUPPORT.

THE ENGINE SERIAL NUMBER IS ON THE RIGHT SIDE OF THE ENGINE BLOCK.

THE CAB SERIAL NUMBER IS ON THE INSIDE LEFT REAR CORNER OF THE CAB.

PRODUCT IDENTIFICATION NUMBER (PIN) INFORMATION IS LISTED TO SHOW ON WHICH MACHINES EACH PART CAN BE USED; FOR EXAMPLE:

-	THE PART CAN BE USED ON ALL MACHINES.
000000-	THE PART CAN BE USED ON ALL MACHINES BEGINNING WITH THE PIN OR YEAR.
-000000	THE PART CAN BE USED ON ALL MACHINES UP TO AND INCLUDING THE PIN OR YEAR LISTED.
000000-000000	THE PART CAN BE USED ON ALL MACHINES BETWEEN AND INCLUDING THE PRODUCT IDENTIFICATION NUMBERS OR YEARS LISTED.

WHEN XXXXXX'S ARE LISTED IN PLACE OF A PRODUCT IDENTIFICATION NUMBER, A CHANGE WAS MADE BUT THE EXACT PIN WAS NOT AVAILABLE WHEN THE CATALOG WAS PRODUCED.

## DIRECTION ARROW

ARROWS ARE USED WITH ILLUSTRATIONS TO INDICATE THE FRONT OF THE UNIT. "RIGHT-HAND" AND "LEFT-HAND" SIDES ARE DETERMINED BY FACING IN THE DIRECTION OF MACHINE FORWARD TRAVEL.

## BOX-ENCLOSED ILLUSTRATIONS

A KEY NUMBER, SHOWN IN THE PARTS LIST, IS ASSIGNED TO A BOX ENCLOSING ALL PARTS SOLD AS A SERVICE ASSEMBLY.

## BOLT AND CAP SCREW STRENGTH IDENTIFICATION

BOLTS AND CAP SCREWS REQUIRED TO HAVE HIGH-STRENGTH QUALITIES EQUIVALENT TO SAE GRADE 8 ARE IDENTIFIED THROUGHOUT THIS CATALOG BY THE DESCRIPTION HS SAE 8. ALL STANDARD BOLTS AND CAP SCREWS ARE SAE GRADE 5 OR LOWER.

## COMPLETE GOODS LISTINGS

COMPLETE GOODS ARE LISTED IN BOLD FACE TYPE. ORDER SEPARATELY. DO NOT INCLUDE ON REPLACEMENT PARTS ORDER.

## SI UNITS OF MEASURE

METRIC DIMENSIONS ARE GIVEN, WHERE APPLICABLE, THROUGHOUT THIS PARTS CATALOG. HOSE DIMENSIONS LISTED ARE EITHER FITTING SIZE X LENGTH X FITTING SIZE OR I.D. X LENGTH.

**Thanks very much for your reading,  
Want to get more information,  
Please click here, Then get the complete  
manual**

**JustClickHere** 

**NOTE:**

**If there is no response to click on the link above,  
please download the PDF document first, and then  
click on it.**

**Have any questions please write to me:  
[admin@servicemanualperfect.com](mailto:admin@servicemanualperfect.com)**

## ENGINE SERIAL NUMBER PLATE

RGP3513 -UN-01JAN94



RGP3513

### FIRST LINE

PE - JOHN DEERE TORREON ENGINE WORKS

6

068 (6.8 LITERS)

H (AIR-TO-AIR)

N - JOHN DEERE DES MOINES WORKS

XXXXXX

### SECOND LINE

6068HN051

### DEFINES

DESIGNATES ENGINE MANUFACTURER

DESIGNATES NUMBER OF CYLINDERS

DESIGNATES LITER DISPLACEMENT

DESIGNATES TYPE OF AIR INTAKE SYSTEM

DESIGNATES USER FACTORY

DESIGNATES ENGINE SERIAL NUMBER

### APPLICATION

4720 SPRAYER

## SECTION INDEX

GENERAL INFORMATION.....	10
ENGINE.....	20
FUEL SYSTEM.....	30
ELECTRICAL SYSTEM.....	40
POWER TRAIN .....	50
STEERING AND BRAKES.....	60
60' BOOM.....	65
HYDRAULIC SYSTEM .....	70
80/90' BOOM.....	75
SOLUTION CONTROLS .....	80
OPERATOR'S PLATFORM AND CAB.....	90
AUTOTRAC OPTION.....	93
SPECIAL EXPORT PARTS FOR HUNGARY .....	95
MAIN FRAME AND CHASSIS.....	100
COMPRESSED AIR.....	105
DECALS .....	110
NUMERICAL INDEX .....	120

## ALPHABETICAL INDEX

	PAGE		PAGE
<b>A</b>		<b>B</b>	
A/C / HEATER COMPARTMENT COVER.....	90-11	BACKREST, INSTRUCTIONAL SEAT.....	90-24
A/C COMPRESSOR CLUTCH, STATOR.....	90-4	BATTERIES AND CABLES.....	40-3
A/C LINES (6.8L).....	100-44	BEACON LIGHT, BRAKE LIGHT WIRING HARNESS (EXPORT).....	95-6
A/C RECEIVER DRYER AND MOUNTING PARTS.....	90-72	BEARINGS, CONNECTING ROD.....	20-40
ACCUMULATOR (80/90' BOOM).....	75-17	BEARINGS, MAIN.....	20-39
ACCUMULATOR HOSE, LIFT CYLINDER HOSES.....	65-16	BELT, FAN.....	20-4
ACCUMULATOR,HOSES,FITTING, TO LIFT CYL. (80/90' BOOM).....	75-17	BEZEL BRACKET, RADIO.....	40-24
ADAPTER, ENGINE OIL COOLER.....	20-50	BEZEL, RADIO.....	40-24
ADAPTER, ENGINE OIL FILTER.....	20-52	BEZEL, ROTARY BEACON LIGHT (EXPORT).....	40-66
ADAPTER, FUEL FILTER LINES.....	30-18	BEZEL, ROTARY BEACON LIGHT (EXPORT).....	95-4
ADAPTER, FUEL INJECTION PUMP.....	30-14	BLOCK ASSEMBLY, ENGINE SHORT.....	20-32
ADAPTER, HYDROSTATIC PUMP MOUNTING.....	50-26	BLOCK, CYLINDER.....	20-34
ADJUST, OPERATOR'S SEAT.....	90-26	BLOWER AND FILTER, CAB PRESSURIZER.....	90-14
ADJUSTING SCREWS, HEADLIGHT.....	40-54	BOOK, SPRAY MANAGEMENT GUIDE.....	80-91
AFTERCOOLER AND HOSES.....	20-20	BOOM FOLD CYLINDER, 60' BOOM.....	65-11
AGITATION VALVE.....	80-94	BOOM FOLD SWITCH, FOOT CONTROL.....	40-8
AIR CIRCULATION DUCT.....	90-18	BOOM FOLD, INNER, HYDRAULIC CYLINDER.....	75-5
AIR COMPRESSOR (ON BOARD AIR).....	105-2	BOOM HARDWARE, 60' BOOM.....	65-4
AIR CONDITIONING COMPRESSOR.....	90-1	BOOM HOSE STRAINER.....	75-53
AIR FILTER, CAB PRESSURIZER.....	90-14	BOOM LEVELING CYLINDER, 60' BOOM.....	65-10
AIR FILTER, COMPRESSOR (ON BOARD AIR).....	105-2	BOOM LIFT CYLINDER.....	75-6
AIR INTAKE.....	30-12	BOOM PLUMBING CLEANOUT.....	80-84
AIR INTAKE SYSTEM.....	20-14	BOOM SOLUTION VALVE ( - 5000).....	80-28
AIR RESTRICTION SENSOR.....	20-14	BOOM SOLUTION VALVE (5001 - ).....	80-30
AIR SPRING, FRONT SUSPENSION.....	100-18	BOOM TILT CYLINDER (80/90' BOOM).....	75-3
AIR SPRING, REAR SUSPENSION.....	100-24	BOOM VALVE (60' BOOM).....	65-20
AIR SUSPENSION, OPERATOR'S SEAT WEAR PARTS KIT.....	90-34	BOOM VALVE (80/90' BOOM, BASIC).....	75-14
AIR SUSPENSION, OPERATOR'S SEAT, LOWER.....	90-30	BOOM WIRING HARNESS (60' BOOM).....	65-24
AIR SUSPENSION, OPERATOR'S SEAT, UPPER.....	90-32	BOOM WIRING HARNESS (80/90' BOOM).....	75-10
AIR TANK AND DRYER.....	105-4	BOOM WIRING HARNESS (80/90' BOOM).....	75-12
ALTERNATOR AND BRACKET.....	40-2	BOOM, 80' AND 90' HOSE DROPS.....	75-56
ANGLE, BUMPER, WING (80/90' BOOM).....	75-28	BOWL, FUEL FILTER SEDIMENT.....	30-20
ANGLE, JACK.....	100-41	BRACKET, ALTERNATOR.....	40-2
ANTENNA CABLE AND RADIO BRACKET (MOBILE RADIO).....	90-5	BRACKET, AUXILIARY POWER STRIP.....	40-29
APERTURE, ROTARY BEACON LIGHT (EXPORT).....	40-66	BRACKET, EDUCTOR.....	80-40
APERTURE, ROTARY BEACON LIGHT (EXPORT).....	95-4	BRACKET, FIRE EXTINGUISHER.....	100-42
ARM, LIFT (60' BOOM).....	65-18	BRACKET, FUEL FILTER LINES.....	30-18
ARM, LIFT (80/90' BOOM).....	75-24	BRACKET, GREENSTAR RECEIVER.....	40-44
ARM, ROCKER.....	20-30	BRACKET, GREENSTAR™ DISPLAY MONITOR.....	40-4
ARMREST ADJUSTMENT FRAME.....	90-20	BRACKET, JACK POINT.....	100-41
ARMREST AND CONSOLE DECALS.....	110-6	BRACKET, MOUNTING, 60' BOOM.....	65-4
ARMREST AND CONSOLE DECALS (PORTUGUESE).....	110-8	BRACKET, RADAR SENSOR.....	40-30
ARMREST ASSEMBLY.....	90-66	BRACKET, RINSE TANK.....	80-38
ARMREST WIRING HARNESS.....	40-14	BRACKET, ROTARY BEACON LIGHT (EXPORT).....	40-66
ARMREST, OPERATOR'S SEAT.....	90-28	BRACKET, ROTARY BEACON LIGHT (EXPORT).....	95-4
ATTACHMENT HARDWARE (80/90' BOOM).....	75-40	BRACKET, SMV EMBLEM.....	100-37
AUTO AIR SPRING LEVELING SYSTEM.....	100-54	BRACKET, STEERING VALVE.....	60-9
AUTOTRAC HARNESS AND SWITCH.....	93-2	BRACKET, TOE CONTROL VALVE.....	70-30
AUTOTRAC PRIORITY VALVE.....	93-4	BRACKET, TRANSPORT (60' BOOM).....	65-23
AUTOTRAC STEERING AND EH VALVES.....	93-8	BRACKET, TRIPLET NOZZLE.....	65-26
AUTOTRAC STEERING CONTROLLER.....	93-10	BRACKET, 60' FOAM DROP.....	65-17
AUTOTRAC WHEEL ANGLE SENSOR.....	93-6	BRACKET, 60' FOAM DROP.....	80-72
AUXILIARY DRIVE COVER.....	20-47	BRACKET, 90' FOAM DROP.....	75-58
AUXILIARY HYDRAULIC PUMP.....	70-20	BRACKETS AND WIRING HARNESS, GREENSTAR_t..... m	040-4
AUXILIARY HYDRAULIC PUMP HOSES AND FITTINGS.....	70-8	BRACKETS, DEAERATION TANK.....	20-24
AUXILIARY POWER STRIP.....	40-29	BRACKETS, END MOUNTING (80/90' BOOM).....	75-36
AXLE, FRONT.....	100-14	BRACKETS, FOAM MARKER TANK (50 GALLON).....	80-64
AXLE, REAR.....	100-22	BRACKETS, FOAM MARKER TANK (50 GALLON).....	80-66
		BRACKETS, RADIATOR.....	20-18



## ALPHABETICAL INDEX - CONTINUED

	PAGE		PAGE
BRACKETS, SPRAYMASTER CUSTOM PLUMBING (80/90' BOOM) .....	75-46	CENTER PIPE (80/90') 20"SS .....	75-78
BRACKETS, TRANSPORT .....	100-38	CENTER PIPE (80/90')(15" SS).....	75-68
BRACKETS, SPRAYMASTER CUSTOM PLUMBING (80/90' BOOM) .....	75-54	CENTER PIPE ASSEMBLY (80/90')(15" SS) (LH/RH) .....	75-66
BRAKE DISK AND CALIPER .....	60-14	CENTERFRAME SOLUTION HOSES AND FITTINGS .....	80-16
BRAKE LIGHT, BEACON LIGHT WIRING HARNESS (EXPORT) .....	95-6	CHAIN, 60' BOOM .....	65-4
BRAKE PEDAL .....	60-16	CHAINS, BREAKAWAY WING (80/90' BOOM).....	75-30
BRAKE VALVE, PARK.....	50-20	CHANNEL, FRAME, 60' BOOM.....	65-8
BRAKE VALVE, SERVICE .....	60-19	CHANNELS, RADIATOR.....	20-18
BREAK PIPE (LH/RH)(80/90') 20"SS .....	75-84	CHARGE PUMP, HYDROSTATIC .....	50-26
BREAK PIPE (80' ONLY)(15" SS) (LH/RH) .....	75-72	CHART, CALIBRATION.....	80-91
BREAK PIPE (90' ONLY)(15" SS) (LH/RH) .....	75-74	CHASSIS CONTROL UNIT.....	40-12
BREAKAWAY STOP, WING (80/90' BOOM).....	75-28	CHASSIS WIRING HARNESS.....	40-6
BREAKAWAY WING (80/90' BOOM).....	75-30	CLAMP, FUEL INJECTOR .....	30-16
BREAKAWAY WING, 60' BOOM .....	65-6	CLAMP, HEATER HOSE (6.8L).....	100-46
BREATHER, FUEL.....	30-2	CLAMPS, SPRAYMASTER CUSTOM PLUMBING (80/90' BOOM) .....	75-46
BREATHER, VALVE COVER .....	20-28	CLAMPS, SPRAYMASTER CUSTOM PLUMBING (80/90' BOOM) .....	75-54
BRUSH, NOZZLE TIP .....	80-91	CLEAN WATER RINSE TANK.....	80-79
BUMPER (80/90' BOOM) .....	75-34	CLEANER, TANK .....	80-92
BUMPER ANGLE, WING (80/90' BOOM).....	75-28	CLEANOUT, BOOM PLUMBING .....	80-84
BUMPER, TRANSPORT BRACKETS .....	100-38	CLOTHES HOOK.....	90-45
BUMPER, 60' BOOM.....	65-4	COLLECTOR ASSEMBLY, FOAM HEAD EXT. ....	80-73
BUSHINGS AND SEALS, FRONT SUSPENSION .....	100-16	COMBINATION VALVE .....	70-10
BUSHINGS AND SEALS, REAR SUSPENSION.....	100-20	COMFORT SEAT SUSPENSION, SUPER .....	90-78
BY-PASS TUBE (WATER PUMP).....	20-61	COMFORT SEAT, SUPER, MSG85/MSG95.....	90-76
		COMPARTMENT, STORAGE, LH PLATFORM.....	100-8
		COMPENSATOR, AUXILIARY HYDRAULIC PUMP .....	70-20
		COMPRESSOR CLUTCH (A/C).....	90-4
		COMPRESSOR HARDWARE KIT (A/C).....	90-3
		COMPRESSOR PARTS (A/C) .....	90-2
		COMPRESSOR, A/C .....	90-1
		COMPRESSOR, AIR (ON BOARD AIR).....	105-2
		COMPRESSOR, 12 VOLT FOAM MARKER.....	80-74
		CONDENSOR, OIL COOLER.....	20-64
		CONDITIONER, COOLANT.....	20-63
		CONNECTING ROD .....	20-40
		CONNECTING ROD BEARINGS.....	20-40
		CONNECTORS AND TERMINALS, SUPPLEMENTARY .....	40-64
		CONNECTORS, ELECTRICAL, WEATHERPACK .....	40-56
		CONSOLE AND ARMREST DECALS .....	110-6
		CONSOLE AND ARMREST DECALS (PORTUGUESE) .....	110-8
		CONSOLE SWITCHES AND CONTROLS, R.H. ....	40-26
		CONSOLE, CONTROL .....	90-62
		CONTAINER, CALIBRATED .....	80-91
		CONTROL CABLE, HYDROSTATIC .....	90-60
		CONTROL CONSOLE .....	90-62
		CONTROL HANDLE, HYDRO.....	90-56
		CONTROL UNIT, CHASSIS/SPRAY RATE .....	40-12
		CONTROL UNIT, ON-BOARD AIR FOAM MARKER.....	80-54
		CONTROL UNIT, PROPULSION .....	90-56
		CONTROL UNIT, 12 VOLT FOAM MARKER .....	80-56
		CONTROL VALVE, STEERING .....	60-12
		CONTROL, HYDROSTATIC PUMP DISPLACEMENT.....	50-32
		CONTROL, THROTTLE.....	40-22
		CONTROLLER, ENGINE.....	30-14
		CONTROLS, R.H. CONSOLE.....	40-26
		COOLANT CONDITIONER.....	20-63
		COOLANT HEATER, ENGINE.....	20-54
		COOLER, ENGINE OIL .....	20-50
		COOLER, HYDRAULIC OIL.....	70-4
		CORE, EVAPORATOR/HEATER.....	90-12
		COURTESY LIGHT, EXTERIOR.....	40-68
		COVER, AIR INTAKE .....	30-12
		COVER, AUXILIARY DRIVE .....	20-47

### C

CAB (BASIC UNIT OR FULLY TRIMMED) .....	90-59
CAB DECALS .....	110-22
CAB ELECTRICAL CABLES .....	40-13
CAB FLOOR .....	90-22
CAB HEADLINER .....	90-42
CAB MOUNTS .....	90-16
CAB PRESSURE INDICATOR.....	90-10
CAB RECIRCULATING FILTER.....	90-12
CAB SIDE COVERS .....	100-40
CAB WIRING HARNESS .....	40-18
CAB WIRING HARNESS.....	40-20
CABLE, BATTERY .....	40-3
CABLE, CENTER FRAME, 60' BOOM .....	65-8
CABLE, HYDROSTATIC CONTROL.....	90-60
CABLE, TEMPERATURE CONTROL .....	90-12
CABLE, 60' BOOM .....	65-4
CALIBRATION KIT.....	80-91
CALIPER AND DISK, BRAKE .....	60-14
CALIPER, BRAKE ASSEMBLY.....	60-18
CAMSHAFT .....	20-34
CAMSHAFT PLATE .....	20-34
CAP, FOAM MARKER TANK (50 GALLON) .....	80-64
CAP, FOAM MARKER TANK (50 GALLON) .....	80-66
CAP, FUEL TANK .....	30-2
CAP, HYDRAULIC/HYDROSTATIC OIL RESERVOIR .....	70-1
CAP, OIL FILL INLET .....	20-49
CAP, RADIATOR .....	20-22
CAUTION AND SAFETY DECALS .....	110-18
CAUTION AND SAFETY DECALS (PORTUGUESE).....	110-20
CENTER FRAME, MOUNTED, SUSPENDED (80/90' BOOM) .....	75-32
CENTER FRAME, 60' BOOM.....	65-8

## ALPHABETICAL INDEX - CONTINUED

	PAGE		PAGE
COVER, FEEDER PIPES, HOSES (80/90' BOOM)	75-42	DOOR HINGE, LEFT HAND	90-54
COVER, HEATER / A/C COMPARTMENT	90-11	DOOR LIGHT SWITCH	40-43
COVER, RINSE TANK	80-36	DOOR, LEFT-HAND	90-54
COVER, THERMOSTAT	20-62	DOOR, RIGHT-HAND	90-69
COVER, TIMING GEAR	20-44	DRAIN PLUG, ENGINE OIL PAN	20-36
COVER, VALVE	20-29	DRAIN PLUG, FUEL TANK	30-2
COWL ASSEMBLY	90-64	DRAWER	90-68
CRANKSHAFT AND BEARINGS	20-39	DRIVE GEAR, FUEL INJECTION PUMP	30-14
CRANKSHAFT DAMPENER	20-38	DRIVE SHAFT	50-33
CRANKSHAFT GEAR	20-39	DROP NOZZLES	80-70
CRANKSHAFT PULLEY	20-38	DROPS, HOSE, 80' AND 90' BOOM	75-56
CRANKSHAFT REAR OIL SEAL	20-43	DRYER, AND AIR TANK	105-4
CROP SHIELDS	100-26	DUAL FLOWMETER HIGH FLOW WIRING HARNESS	40-55
CUSHION, INSTRUCTIONAL SEAT	90-24	DUAL OPTION (12 VOLT) FOAM MARKER WIRING HARNESS	80-78
CUSHION, OPERATOR'S SEAT	90-28	DUCT, AIR CIRCULATION	90-18
CUSTOM PLUMBING, SPRAYMASTER (80/90' BOOM) CENTER WING	75-46	DUCT, CAB PRESSURIZER BLOWER	90-14
CUSTOM PLUMBING, SPRAYMASTER (80/90' BOOM) INNER, BREAKAWAY, OUTER WINGS	75-54	DYES	80-92
CYLINDER BLOCK	20-34		
CYLINDER BLOCK, HYDROSTATIC PUMP	50-30	<b>E</b>	
CYLINDER HEAD	20-26	ECU	30-14
CYLINDER LIMIT SWITCH	75-38	EDUCTOR BRACKET	80-40
CYLINDER LINER	20-40	EDUCTOR HOPPER (LARGE)	80-44
CYLINDER POSITION SENSOR	75-38	EDUCTOR HOPPER (STANDARD)	80-42
CYLINDER, BOOM LIFT	75-6	EH VALVE, AUTOTRAC	93-8
CYLINDER, BOOM TILT (80/90' BOOM)	75-3	ELECTRICAL CABLES, CAB	40-13
CYLINDER, FOLD, 60' BOOM	65-4	ELECTRICAL CONNECTOR SERVICE KIT	40-58
CYLINDER, FOLD, 60' BOOM	65-11	ELECTRICAL CONNECTOR SERVICE KIT	40-60
CYLINDER, HYDRAULIC (FRONT AXLE)	100-14	ELECTRICAL TERMINALS AND CONNECTORS, WEATHERPACK	40-56
CYLINDER, LEVELING, 60' BOOM	65-10	ELEMENT, ENGINE OIL FILTER	20-52
CYLINDER, LIFT	65-16	ELEMENT, FUEL FILTER	30-20
CYLINDER, OUTER FOLD (80/90' BOOM)	75-7	EMBLEM, LEAPING DEERE	40-54
CYLINDER, OUTER WING (80/90' BOOM)	75-22	END MOUNTING BRACKETS (80/90' BOOM)	75-36
CYLINDER, ROLL BIAS (80/90' BOOM)	75-4	END PLATE, VALVE (60' BOOM)	65-20
CYLINDER, STANDARD TILT (80/90' BOOM)	75-2	END PLATE, VALVE (80/90' BOOM, BASIC)	75-14
CYLINDER, STEERING	60-13	ENGINE CONTROLLER	30-14
CYLINDER, TREAD ADJUST	70-26	ENGINE COOLANT HEATER	20-54
CYLINDERS, CENTER FRAME (80/90' BOOM)	75-38	ENGINE MOUNTINGS	20-6
		ENGINE OIL PAN	20-36
<b>D</b>		ENGINE OIL PRESSURE SENSOR	40-4
DAMPENER, CRANKSHAFT	20-38	ENGINE PISTON	20-40
DEAERATION TANK BRACKETS	20-24	ENGINE SHORT BLOCK ASSEMBLY	20-32
DECALS, CONSOLE AND ARMREST	110-6	ENGINE SPEED CONTROL (THROTTLE CONTROL)	40-22
DECALS, CONSOLE AND ARMREST (PORTUGUESE)	110-8	ENGINE SPEED SENSOR	40-50
DECALS, MISCELLANEOUS	110-10	ENGINE WIRING HARNESS	40-4
DECALS, MISCELLANEOUS (PORTUGUESE)	110-12	EQUIPMENT PROTECTANT	80-92
DECALS, SAFETY	110-2	EVAPORATOR/HEATER CORE	90-12
DECALS, SAFETY (PORTUGUESE)	110-4	EXHAUST MANIFOLD	30-13
DIAPHRAGM, NOZZLE ASSEMBLY FOR 1" PIPE	75-48	EXHAUST PIPE	20-10
DIAPHRAGM, NOZZLE ASSEMBLY FOR 1" PIPE (80/90' BOOM)	75-47	EXHAUST VALVE	20-26
DIAPHRAGM, NOZZLE ASSEMBLY FOR 3/4" PIPE (60' BOOM)	65-22	EXPANSION VALVE, HEATER AND A/C	90-12
DIPSTICK GUIDE	20-12	EXTENDED RANGE SPRAY TIPS	80-86
DIPSTICK, OIL	20-12	EXTENSION SPRING, BREAKAWAY WING (80/90' BOOM)	75-30
DISK AND CALIPER, BRAKE	60-14	EXTERIOR COURTESY LIGHT	40-68
DISPLACEMENT CONTROL, HYDROSTATIC PUMP	50-32	EXTINGUISHER, FIRE	100-42
DISPLAY MONITOR, GREENSTAR_tm	40-4		
DOME LIGHT AND SWITCH	40-42	<b>F</b>	
DOOR HANDLE AND LOCK	90-70	FAN DRIVE	20-4
DOOR HANDLE, INNER	90-54	FAN SHIELD	20-1
DOOR HANDLE, LEFT HAND	90-54	FAN SHROUD	20-16
		FEEDER PIPES, HOSES (80/90' BOOM)	75-42

## ALPHABETICAL INDEX - CONTINUED

	PAGE		PAGE
FENCE ROW NOZZLES.....	80-76	FLOW METER, SOLUTION	
FENDER AND SUPPORTS.....	100-30	(5001- ).....	80-14
FENDER AND SUPPORTS.....	100-32	FLOWMETER (SINGLE) WITH STANDARD PUMP.....	65-28
FENDER UPHOLSTERY, (CAB).....	90-36	FLOWMETER ASSEMBLY.....	80-90
FIELD OFFICE.....	90-38	FLUSH TUBE, EDUCTOR , UPPER.....	80-46
FILL STATION LIGHT.....	40-37	FLYWHEEL AND RING GEAR.....	20-42
FILLER NECK, OIL.....	20-49	FLYWHEEL HOUSING.....	20-43
FILTER HEAD, ENGINE OIL.....	20-52	FLYWHEEL SHIELDS.....	20-2
FILTER LINES, PRIMARY AND FINAL FUEL.....	30-18	FOAM DROP BRACKET, 60'.....	65-17
FILTER, AIR.....	20-14	FOAM DROP BRACKET, 60'.....	80-72
FILTER, CAB FRESH AIR.....	90-14	FOAM DROP BRACKET, 90'.....	75-58
FILTER, CAB RECIRCULATING.....	90-12	FOAM HEAD EXTENSION, COLLECTOR ASSY.....	80-73
FILTER, ENGINE OIL.....	20-52	FOAM MARKER CONTROL UNIT (12 VOLT).....	80-56
FILTER, FINAL FUEL.....	30-20	FOAM MARKER QUICK FILL.....	80-75
FILTER, HYDRAULIC.....	70-14	FOAM MARKER TANK (12 VOLT AND OBA)	
FILTER, HYDROSTATIC PUMP.....	50-24	(35 GALLON).....	80-62
FILTER, PRIMARY FUEL (PRE-FILTER).....	30-20	FOAM MARKER TANK AND BRACKETS	
FILTERS, HYDRAULIC RESERVOIR.....	70-1	(50 GALLON).....	80-64
FINAL FUEL FILTER LINES.....	30-18	FOAM MARKER TANK AND BRACKETS	
FIRE EXTINGUISHER AND BRACKET.....	100-42	(50 GALLON).....	80-66
FITTINGS AND HOSES, COMBO VALVE.....	70-10	FOAM MIXING CHAMBER (ON-BOARD AIR).....	80-60
FITTINGS AND HOSES, SERVICE BRAKE VALVE.....	50-4	FOAM MIXING CHAMBER (12 VOLT).....	80-58
FITTINGS AND HOSES, SOLUTION TANK (TOP).....	80-2	FOAMS.....	80-92
FITTINGS AND HOSES, TOE CONTROL VALVE.....	70-30	FOLD CYLINDER, 60' BOOM.....	65-4
FITTINGS AND HOSES, WHEEL DRIVE.....	50-6	FOLD CYLINDER, 60' BOOM.....	65-11
FITTINGS, FEEDER PIPES, HOSES		FOOT CONTROL SWITCH, BOOM FOLD.....	40-8
(80/90' BOOM).....	75-42	FOOTREST, CAB FLOOR.....	90-22
FITTINGS, HOSES, BOOM VALVE		FRAME, ARMREST ADJUSTMENT.....	90-20
(-5000).....	80-12	FRAME, CENTER, MOUNTED, SUSPENDED	
FITTINGS, HOSES, BOOM VALVE		(80/90' BOOM).....	75-32
(5001- ).....	80-14	FRAME, CENTER, 60' BOOM.....	65-8
FITTINGS, HOSES, END PORT, VALVE		FRAME, FRONT HOOD.....	100-43
(80/90' BOOM).....	75-16	FRAME, LIFT ARM (80/90' BOOM).....	75-24
FITTINGS, HOSES, FOLDING CYLINDERS		FRAME, LIFT, 60' BOOM.....	65-8
(80/90' BOOM).....	75-20	FRAME, MAIN.....	100-2
FITTINGS, HOSES, HYDROSTATIC PUMP.....	50-2	FRAME, OUTER (80/90' BOOM).....	75-45
FITTINGS, HOSES, LEFT FRONT WHEEL MOTOR.....	50-14	FRAME, OUTER WING (80/90' BOOM).....	75-22
FITTINGS, HOSES, LEFT REAR WHEEL MOTOR.....	50-16	FRONT AXLE.....	100-14
FITTINGS, HOSES, LEVELING CYLINDER		FRONT GRILLE.....	100-43
60' BOOM.....	65-14	FRONT HOOD FRAME.....	100-43
FITTINGS, HOSES, LEVELING CYLINDERS		FRONT HUB (23.5:1 RATIO).....	50-34
(80/90' BOOM).....	75-8	FRONT PLATE.....	20-41
FITTINGS, HOSES, LIFT CYLINDER		FRONT PLATE & IDLER GEARS.....	20-41
(80/90' BOOM).....	75-17	FRONT SEAL.....	20-44
FITTINGS, HOSES, LIFT CYLINDER (60' BOOM).....	65-16	FRONT STEERING LIGHTS.....	40-41
FITTINGS, HOSES, LOWER EDUCTOR.....	80-48	FRONT SUNSHADE KIT.....	90-73
FITTINGS, HOSES, OUTER FOLD CYLINDERS		FRONT SUSPENSION.....	100-18
(80/90' BOOM).....	75-18	FRONT WHEEL SHIELDS.....	100-28
FITTINGS, HOSES, PARK BRAKE.....	50-20	FRONT WINDOW.....	90-50
FITTINGS, HOSES, PRESSURE VALVE.....	80-32	FUEL FILTER LINES, PRIMARY AND FINAL.....	30-18
FITTINGS, HOSES, PRIORITY VALVE.....	70-12	FUEL FILTER, FINAL.....	30-20
FITTINGS, HOSES, RIGHT FRONT WHEEL MOTOR.....	50-10	FUEL FILTER, PRIMARY (PRE-FILTER).....	30-20
FITTINGS, HOSES, RIGHT REAR WHEEL MOTOR.....	50-12	FUEL INJECTION LINE RAIL.....	30-14
FITTINGS, HOSES, SOLUTION PRESSURE.....	80-10	FUEL INJECTION LINES.....	30-14
FITTINGS, HOSES, SOLUTION TANK BOTTOM.....	80-8	FUEL INJECTION NOZZLE.....	30-16
FITTINGS, HOSES, STEERING.....	60-10	FUEL INJECTION PUMP.....	30-14
FITTINGS, HOSES, TREAD ADJUSTING VALVE.....	70-16	FUEL INJECTION PUMP ADAPTER.....	30-14
FITTINGS, HOSES, VALVE, FOLD CYLINDER		FUEL INJECTION PUMP DRIVE GEAR.....	30-14
60' BOOM.....	65-12	FUEL INJECTION PUMP SENSOR.....	30-14
FITTINGS, HYDROSTATIC PUMP.....	50-24	FUEL INJECTION SYSTEM.....	30-14
FITTINGS, VALVE, ROLL BIAS CYLINDER		FUEL INJECTOR FEED TUBE.....	30-16
(80/90' BOOM).....	75-26	FUEL INJECTOR WIRE HARNESS.....	30-14
FLEXIBLE EXHAUST PIPE.....	20-10	FUEL INJECTOR GLOW PLUG.....	40-52
FLOOR MAT.....	90-21	FUEL LINES (CAB FORWARD).....	30-6
FLOOR, CAB.....	90-22	FUEL LINES, FUEL FILTER.....	30-18
FLOW METER, SOLUTION		FUEL TANK.....	30-2
(-5000).....	80-12	FUEL TANK SUPPORTS.....	30-4

## ALPHABETICAL INDEX - CONTINUED

	PAGE		PAGE
FUEL TRANSFER PUMP		HEAD, CYLINDER .....	20-26
W/STRAIGHT FLEX FITTINGS .....	30-17	HEAD, FUEL FILTER .....	30-20
FUSES .....	40-18	HEADLAMP WIRING HARNESS .....	40-32
FUSES .....	40-20	HEADLIGHT ADJUSTING SCREWS .....	40-54
		HEADLIGHTS .....	40-54
<b>G</b>		HEADLIGHTS AND SIDE LIGHT .....	40-38
GASKET KIT, ENGINE CYLINDER HEAD REMOVAL .....	20-55	HEADLINER, CAB .....	90-42
GASKET KIT, ENGINE IN-CHASSIS OVERHAUL .....	20-55	HEAT SHIELD, VALVE COVER .....	20-29
GASKET KIT, ENGINE MAJOR OVERHAUL .....	20-56	HEATER / REFRIGERANT LINES .....	90-6
GASKET, AIR INLET .....	30-12	HEATER AND A/C BLOWER MOTOR .....	90-12
GASKET, CYLINDER HEAD .....	20-26	HEATER AND A/C EXPANSION VALVE .....	90-12
GASKET, ENGINE OIL COOLER .....	20-50	HEATER AND A/C HOUSING .....	90-12
GASKET, ENGINE OIL PAN .....	20-36	HEATER HOSE (6.8L) .....	100-46
GASKET, EXHAUST MANIFOLD .....	30-13	HEATER HOSE CLAMP (6.8L) .....	100-46
GASKET, HYDROSTATIC PUMP .....	50-24	HEATER/A/C COMPARTMENT COVER .....	90-11
GASKET, OIL FILL INLET .....	20-49	HEATER, ENGINE COOLANT .....	20-54
GASKET, THERMOSTAT COVER .....	20-62	HIGH FLOW NOZZLE, 5 POSITION .....	75-50
GASKET, TIMING GEAR COVER .....	20-44	HIGH FLOW SOLUTION PLUMBING .....	80-10
GASKET, TURBOCHARGER .....	30-9	HIGH FLOW SPRAY TIPS .....	80-86
GASKET, VALVE COVER .....	20-29	HIGH FLOW WIRING HARNESS(DUAL FLOWMETER) .....	40-55
GEAR, CRANKSHAFT .....	20-39	HINGE, HOOD .....	100-48
GEAR, ENGINE OIL PUMP .....	20-48	HINGE, 60' BOOM .....	65-2
GEAR, FUEL INJECTION PUMP DRIVE .....	30-14	HOLDER, NOZZLE, 1" PIPE .....	75-50
GEAR, HUB, FRONT (23.5:1 RATIO) .....	50-34	HOLLOW CONE SPRAY TIPS .....	80-87
GEAR, HUB, REAR (30.1:1 RATIO) .....	50-36	HOOD .....	100-50
GEAR, IDLER .....	20-41	HOOD LATCH .....	100-52
GLASS, CAB FRONT .....	90-50	HOOD PIVOT SPRING .....	100-48
GLOW PLUG AND WIRING HARNESS, FUEL INJ .....	40-52	HOOD SUPPORT .....	100-48
GLOW PLUG RELAY, JUMPER AND HARNESS .....	40-17	HOOD SUPPORT, REAR .....	100-34
GREENSTAR RECEIVER BRACKET .....	40-44	HOOD, SIDE LH .....	100-50
GREENSTAR_tm DISPLAY MONITOR .....	40-4	HOOD, SIDE RH .....	100-50
GREENSTAR_tm WIRING HARNESS AND BRACKETS .....	40-4	HOOK, CLOTHES .....	90-45
GRILL, FRONT .....	100-43	15HOPPER, EDUCTOR (STANDARD) .....	80-4
GRILLE SCREEN .....	100-43	12HORN .....	40-2
GRILLE SEALS .....	100-53	HOSE DROPS, 80' AND 90' BOOM .....	75-56
GROUND CABLE, STARTER .....	40-3	HOSE STRAINER, BOOM .....	75-53
GUARD, DRIVE SHAFT .....	50-33	HOSE, AUXILIARY HYDRAULIC PUMP .....	70-8
GUARD, FAN SHIELD .....	20-1	HOSE, EDUCTOR, UPPER .....	80-46
GUIDE, DIPSTICK .....	20-12	HOSE, HEATER (6.8L) .....	100-46
		HOSE, 7-SECTION VALVE(EXPORT) .....	95-2
<b>H</b>		HOSES AND FITTINGS, COMBO VALVE .....	70-10
HAND OPERATED VALVE, 2" QUICK FILL .....	80-26	HOSES AND FITTINGS, PRESSURE VALVE .....	80-32
HAND OPERATED VALVE, 3" QUICK FILL .....	80-24	HOSES AND FITTINGS, SERVICE BRAKE .....	50-4
HANDLE AND LOCK, DOOR .....	90-70	HOSES AND FITTINGS, SOLUTION TANK (TOP) .....	80-2
HANDLE, HYDRO .....	90-56	HOSES AND FITTINGS, TOE CONTROL VALVE .....	70-30
HANDRAIL, LH (60' BOOM) .....	100-10	HOSES AND FITTINGS, WHEEL DRIVE .....	50-6
HANDRAILS, L.H. (80/90' BOOM) .....	100-11	HOSES, AFTERCOOLER .....	20-20
HANDRAILS, PLATFORM, RIGHT HAND .....	100-12	HOSES, BYPASS, OIL COOLER .....	70-4
HARDWARE, ATTACHMENT (80/90' BOOM) .....	75-40	HOSES, COMPRESSOR (ON BOARD AIR) .....	105-2
HARDWARE, 60' BOOM .....	65-4	HOSES, FITTINGS, END PORT, VALVE (80/90' BOOM) .....	75-16
HARNESS, ARMREST WIRING .....	40-14	HOSES, FITTINGS, FOLDING CYLINDERS (80/90' BOOM) .....	75-20
HARNESS, BOOM WIRING (60' BOOM) .....	65-24	HOSES, FITTINGS, HYDROSTATIC PUMP .....	50-2
HARNESS, BOOM WIRING (80/90' BOOM) .....	75-10	HOSES, FITTINGS, LEFT FRONT WHEEL MOTOR .....	50-14
HARNESS, BOOM WIRING (80/90' BOOM) .....	75-12	HOSES, FITTINGS, LEFT REAR WHEEL MOTOR .....	50-16
HARNESS, CAB WIRING .....	40-18	HOSES, FITTINGS, LEVELING CYLINDER 60' BOOM .....	65-14
HARNESS, CAB WIRING .....	40-20	HOSES, FITTINGS, LEVELING CYLINDERS (80/90' BOOM) .....	75-8
HARNESS, CHASSIS WIRING .....	40-6	HOSES, FITTINGS, LIFT CYLINDER (80/90' BOOM) .....	75-17
HARNESS, GLOW PLUG WIRING .....	40-52	HOSES, FITTINGS, LIFT CYLINDER (60' BOOM) .....	65-16
HARNESS, HEADLAMP WIRING .....	40-32	HOSES, FITTINGS, LOWER EDUCTOR .....	80-48
HARNESS, PROPULSION CONTROL WIRING .....	90-56	HOSES, FITTINGS, OUTER FOLD CYLINDERS (80/90' BOOM) .....	75-18
HARNESS, ROOF WIRING .....	40-16	HOSES, FITTINGS, PARK BRAKE VALVE .....	50-20
HARNESS, WHEEL SPEED SENSOR WIRING .....	40-10		
HARNESS, WIRING, ENGINE .....	40-4		

## ALPHABETICAL INDEX - CONTINUED

	PAGE		PAGE
HOSES, FITTINGS, PRIORITY VALVE .....	70-12	INNER PIPE (2ND)(80/90')(15" SS )	
HOSES, FITTINGS, RIGHT FRONT WHEEL MOTOR .....	50-10	(LH/RH) .....	75-64
HOSES, FITTINGS, RIGHT REAR WHEEL MOTOR .....	50-12	INNER PIPE, 2ND (80/90') 20"SS .....	75-80
HOSES, FITTINGS, SOLUTION FILTER		INNER ROOF .....	90-8
(-5000) .....	80-12	INNER WING SECTION VALVE .....	80-96
HOSES, FITTINGS, SOLUTION FILTER		INSERT, VALVE SEAT .....	20-26
(5001- ) .....	80-14	INSTRUCTIONAL SEAT .....	90-24
HOSES, FITTINGS, SOLUTION PRESSURE .....	80-10	INTAKE MANIFOLD .....	30-12
HOSES, FITTINGS, SOLUTION TANK BOTTOM .....	80-8	INTAKE VALVE .....	20-26
HOSES, FITTINGS, STEERING .....	60-10	INTAKE, ENGINE OIL PUMP .....	20-36
HOSES, FITTINGS, TREAD ADJUSTING VALVE .....	70-16	INTAKE, ENGINE OIL PUMP .....	20-48
HOSES, FITTINGS, VALVE, FOLD CYLINDER		INTERIOR CAB COURTESY LIGHT .....	40-35
60' BOOM .....	65-12	INTERMEDIATE WING, 60' BOOM .....	65-2
HOSES, HYDRAULIC FILTER .....	70-14		
HOSES, HYDRAULIC PUMP SUCTION AND RETURN .....	70-2	J	
HOSES, PIPES, FEEDER (80/90' BOOM) .....	75-42	JACK ANGLE .....	100-41
HOSES, RADIATOR .....	20-22	JUMPER, CAB ELECTRICAL CABLES .....	40-13
HOSES, VALVE, ROLL BIAS CYLINDER		JUMPER, RELAY AND HARNESS .....	40-17
(80/90' BOOM) .....	75-26		
HOUSING, ENGINE OIL COOLER .....	20-50	K	
HOUSING, FLYWHEEL .....	20-43	KEY AND START AID SWITCHES .....	40-1
HOUSING, FOAM MARKER COMPRESSOR		KIT, CUSTOM, TRIPLET NOZZLE ASSEMBLY	
(12 VOLT) .....	80-74	(60' BOOM) .....	65-22
HOUSING, HEATER AND A/C .....	90-12	KIT, CUSTOM, TRIPLET NOZZLE ASSEMBLY	
HOUSING, HYDROSTATIC PUMP .....	50-30	(80/90' BOOM) .....	75-47
HOUSING, THERMOSTAT .....	20-61	KIT, ELECTRICAL CONNECTOR SERVICE .....	40-58
HUB WHEEL, FRONT (23.5:1 RATIO) .....	50-34	KIT, ELECTRICAL CONNECTOR SERVICE .....	40-60
HUB WHEEL, REAR (30.1:1 RATIO) .....	50-36	KIT, OPERATOR'S SEAT AIR SUSPENSION	
HUB, FAN .....	20-4	WEAR PARTS .....	90-34
HUB, FRONT (23.5:1 RATIO) .....	50-34	KIT, ROTARY BEACON LIGHT (EXPORT) .....	40-66
HUB, REAR (30.1:1 RATIO) .....	50-36	KIT, ROTARY BEACON LIGHT (EXPORT) .....	95-4
HUBS, WHEEL .....	50-8	KIT, SEAL, NOZZLE ASSEMBLY, 1" PIPE .....	75-50
HYDRAULIC CYLINDER - INNER BOOM FOLD .....	75-5	KIT, STARTER MOTOR (DENSO) .....	40-48
HYDRAULIC CYLINDERS, CENTER FRAME		KIT, TERMINAL AND WIRING .....	40-62
(80/90' BOOM) .....	75-38	KIT, WINDSHIELD WASHER .....	90-37
HYDRAULIC OIL COOLER BYPASS AND HOSES .....	70-4	KITS, FUEL FILTER .....	30-20
HYDRAULIC PUMP HOSES AND FITTINGS,			
AUXILIARY .....	70-8	L	
HYDRAULIC PUMP SUCTION AND RETURN HOSES .....	70-2	LABELS, CAB .....	110-22
HYDRAULIC PUMP, AUXILIARY .....	70-20	LABELS, CAUTION AND SAFETY .....	110-18
HYDRAULIC/HYDROSTATIC OIL RESERVOIR .....	70-1	LABELS, CAUTION AND SAFETY (PORTUGUESE) .....	110-20
HYDROSTATIC CONTROL CABLE .....	90-60	LABELS, MISCELLANEOUS .....	110-14
HYDROSTATIC CONTROL HANDLE .....	90-56	LABELS, MISCELLANEOUS (PORTUGUESE) .....	110-16
HYDROSTATIC PUMP DISPLACEMENT CONTROL .....	50-32	LADDER POSITION SWITCH .....	40-9
HYDROSTATIC PUMP FITTINGS, FILTER AND		LADDER, LEFT-HAND .....	100-6
GASKET .....	50-24	LADDER, RIGHT-HAND .....	100-4
HYDROSTATIC PUMP HOUSING, SWASH PLATE		LAMP, WARNING .....	40-51
AND CYLINDER BLOCK .....	50-30	LAMP, WARNING (60' BOOM) .....	40-40
HYDROSTATIC PUMP MOUNTING .....	50-2	LAMP, WARNING (80/90' BOOM) .....	40-39
HYDROSTATIC PUMP MOUNTING .....	50-26	LATCH, HOOD .....	100-52
HYDROSTATIC PUMP SHAFT, SERVO ASSEMBLY .....	50-28	LEAPING DEERE EMBLEM .....	40-54
HYDROSTATIC PUMP VALVES, PLUGS AND SEALS .....	50-22	LEFT FRONT WHEEL MOTOR, HOSES, FITTINGS .....	50-14
		LEFT REAR WHEEL MOTOR, HOSES, FITTINGS .....	50-16
I		LEFT-HAND DOOR .....	90-54
IDLER GEAR .....	20-41	LEFT-HAND HANDRAILS (80/90' BOOM) .....	100-11
IDLER, FAN .....	20-4	LEFT-HAND HANDRAILS AND RIGHT-HAND LIGHT	
IMPELLER, HEATER AND A/C BLOWER MOTOR .....	90-12	SUPPORT (60' BOOM) .....	100-10
IMPELLER, SOLUTION PUMP .....	80-34	LEFT-HAND LADDER AND PLATFORM .....	100-6
INDICATOR, CAB PRESSURE .....	90-10	LEFT-HAND PLATFORMS AND STORAGE	
INLET, OIL FILL .....	20-49	COMPARTMENT .....	100-8
INLET, WATER PUMP .....	20-46	LEVELER, HYDROSTATIC PUMP .....	50-28
INNER DOOR HANDLE .....	90-54		
INNER PIPE (1ST)(LH/RH)(80/90') 20"SS .....	75-86		
INNER PIPE (1ST)(80/90')(15" SS)			
(LH/RH) .....	75-62		

## ALPHABETICAL INDEX - CONTINUED

	PAGE		PAGE
LEVELING CYLINDER, 60' BOOM .....	65-10	MOUNTINGS, ENGINE.....	20-6
LEVELING, AUTO AIR SPRING .....	100-54	MOUNTS, CAB .....	90-16
LEVER, PROPULSION, SPEED CONTROL .....	90-58	MSG85/MSG95, SUPER COMFORT SEAT .....	90-76
LID, EDUCTOR HOPPER (STANDARD) .....	80-42	MSG95/MSG85, SUPER COMFORT SEAT .....	90-76
LID, RINSE TANK.....	80-36	MUFFLER .....	20-10
LIFT ARM (60' BOOM) .....	65-18		
LIFT ARM (80/90' BOOM) .....	75-24	N	
LIFT CYLINDER HOSES.....	65-16	NEGATIVE BATTERY CABLE.....	40-3
LIFT CYLINDER, BOOM .....	75-6	NEUTRAL START SAFETY SWITCH .....	50-32
LIFT FRAME, 60' BOOM .....	65-8	NON AUTOTRAC STEERING CONTROL VALVE .....	60-12
LIFT STRAPS, ENGINE.....	20-25	NON-AUTOTRAC PRIORITY VALVE .....	70-22
LIGHT SUPPORT, RH (60' BOOM) .....	100-10	NOZZLE ASSEMBLY FOR 1" PIPE.....	75-48
LIGHT, COURTESY, INSIDE CAB .....	40-35	NOZZLE ASSEMBLY FOR 1" PIPE (80/ 90' BOOM).....	75-47
LIGHT, DOME .....	40-42	NOZZLE ASSEMBLY FOR 3/4" PIPE (60' BOOM) .....	65-22
LIGHT, FILL STATION.....	40-37	NOZZLE ASSEMBLY, 1" PIPE .....	75-50
LIGHT, HEADLIGHTS AND SIDE.....	40-38	NOZZLE KIT, TRIPLET .....	65-26
LIGHT, ROOF SIDE .....	40-35	NOZZLE SPACING, STANDARD 20" (80/90' BOOM) .....	75-52
LIGHTING, STANDARD HOOD .....	40-54	NOZZLE, FUEL INJECTION.....	30-16
LIGHTS, FRONT STEERING .....	40-41	NOZZLE, SINGLE (SPRAYMASTER) (60 FT. BOOM) .....	65-25
LIGHTS, PLATFORM.....	40-36	NOZZLES, FENCE ROW.....	80-76
LIMIT SWITCH, CYLINDER .....	75-38	NOZZLES, PREDRILLED TUBES (80/90' BOOM).....	75-52
LINER, CYLINDER .....	20-40		
LINES REFRIGERANT (6.8L) .....	100-44	O	
LINES, FUEL (CAB FORWARD) .....	30-6	OBA FOAM MARKER CONTROL UNIT .....	80-54
LINES, FUEL FILTER.....	30-18	OIL COOLER BYPASS AND HOSES .....	70-4
LINES, FUEL INJECTION.....	30-14	OIL COOLER, CONDENSER .....	20-64
LINES, OIL (CAB FORWARD).....	70-28	OIL COOLER, ENGINE .....	20-50
LINES, OIL, TURBOCHARGER .....	30-10	OIL DIPSTICK.....	20-12
LINES, REFRIGERANT/HEATER.....	90-6	OIL FILL INLET .....	20-49
LINK, ASSEMBLY (80/90' BOOM).....	75-45	OIL FILL INLET CAP .....	20-49
LINK, ATTACHMENT HARDWARE (80/90' BOOM).....	75-40	OIL FILL INLET GASKET .....	20-49
LINK, CENTER FRAME (80/90' BOOM) .....	75-34	OIL FILTER HEAD, ENGINE.....	20-52
LINKAGE, RETURN TO HEIGHT .....	75-29	OIL FILTER, ENGINE.....	20-52
LOCK AND HANDLE, DOOR .....	90-70	OIL LINES (CAB FORWARD).....	70-28
LOWER EDUCTOR FITTINGS AND HOSES.....	80-48	OIL LINES, TURBOCHARGER.....	30-10
		OIL PAN, ENGINE.....	20-36
M		OIL PICKUP, ENGINE .....	20-36
MAIN BEARINGS .....	20-39	OIL PRESSURE SENSOR, ENGINE.....	40-4
MAIN FRAME AND SUPPORTS .....	100-2	OIL PUMP INTAKE, ENGINE.....	20-36
MANIFOLD, EXHAUST .....	30-13	OIL PUMP, ENGINE.....	20-48
MANIFOLD, INTAKE .....	30-12	OIL RESERVOIR, HYDRAULIC/HYDROSTATIC .....	70-1
MAT, FLOOR.....	90-21	ON BOARD AIR RESERVOIR AND REGULATOR.....	105-1
MIRROR, FRONT AXLE, MOUNTED.....	100-14	ON-BOARD AIR FOAM MARKER CONTROL UNIT .....	80-54
MIRROR, REAR VIEW .....	90-73	OPERATOR'S SEAT .....	90-25
MIRROR, REMOTE .....	90-46	OPERATOR'S SEAT ADJUST AND PIVOT ASSEMBLIES.....	90-2
MISCELLANEOUS DECALS .....	110-10	OPERATOR'S SEAT AIR SUSPENSION WEAR PARTS KIT.....	90-34
MISCELLANEOUS DECALS (PORTUGUESE).....	110-12	OPERATOR'S SEAT AIR SUSPENSION, LOWER.....	90-30
MISCELLANEOUS DECALS (PORTUGUESE).....	110-16	OPERATOR'S SEAT AIR SUSPENSION, UPPER .....	90-32
MOBILE RADIO ANTENNA CABLE, BRACKET .....	90-5	OPERATOR'S SEAT CUSHION, ARMREST, AND MOUNTING.....	90-28
MODULE, RESUME SWITCH, AUTOTRAC .....	93-2	OPERATOR'S SEAT PIVOT AND ADJUST ASSEMBLIES.....	90-26
MOLDING, FRONT GLASS .....	90-50	OUTER FOLD CYLINDER (80/90' BOOM).....	75-7
MONITOR, GREENSTAR <sub>tm</sub> DISPLAY .....	40-4	OUTER PIPE (LH/RH)(80' ONLY)20"SS.....	75-88
MOTOR WHEEL .....	50-18	OUTER PIPE (LH/RH)(90' ONLY) 20"SS.....	75-82
MOTOR, HEATER AND A/C BLOWER.....	90-12	OUTER PIPE (80' ONLY) (15" SS) (LH/RH) .....	75-70
MOTOR, LEFT FRONT WHEEL .....	50-14		
MOTOR, LEFT REAR WHEEL .....	50-16		
MOTOR, RIGHT FRONT WHEEL .....	50-10		
MOTOR, RIGHT REAR WHEEL .....	50-12		
MOTOR, SOLUTION PUMP .....	80-34		
MOTOR, STARTING (DENSO) .....	40-48		
MOUNTED CENTER FRAME, (80/90' BOOM) .....	75-32		
MOUNTING BRACKETS, END (80/90' BOOM) .....	75-36		
MOUNTING PARTS, RECEIVER DRYER .....	90-72		
MOUNTING PLATE, 7-SECTION VALVE (EXPORT) .....	95-2		
MOUNTING, HYDROSTATIC PUMP .....	50-2		

## ALPHABETICAL INDEX - CONTINUED

	PAGE		PAGE
OUTER PIPE (90° ONLY) (15" SS).....	75-76	PRECLEANER.....	20-8
OUTER PIVOT PIPE (80/90°)(15" SS).....	75-60	PRESSURE INDICATOR, CAB.....	90-10
OUTER ROOF.....	90-9	PRESSURE VALVE, HOSES AND FITTINGS.....	80-32
OUTER WING CYLINDER (80/90' BOOM).....	75-22	PRESSURIZER BLOWER AND FILTER.....	90-14
OUTLETS, AUXILIARY POWER.....	40-29	PRIMARY FILTER, AIR.....	20-14
OVERFLOW TANK, RADIATOR.....	20-22	PRIMARY FUEL FILTER LINES.....	30-18
OVERHAUL KIT, ENGINE.....	20-58	PRIORITY VALVE (NON-AUTOTRAC).....	70-22
		PRIORITY VALVE - STATIC SIGNAL (AUTOTRAC).....	93-4
<b>P</b>		PRIORITY VALVE HOSES AND FITTINGS.....	70-12
PADS, BRAKE.....	60-18	PROPULSION CABLE SUPPORT.....	90-20
PAN, ENGINE OIL.....	20-36	PROPULSION CONTROL UNIT.....	90-56
PANEL ASSEMBLY, SIDE.....	100-36	PROPULSION LEVER.....	90-58
PARK BRAKE VALVE, HOSES AND FITTINGS.....	50-20	PULLEY, CRANKSHAFT.....	20-38
PEDAL, BRAKE.....	60-16	PULLEY, FAN.....	20-4
PEDAL, PIVOT RELEASE.....	60-8	PULLEY, WATER PUMP.....	20-60
PICKUP, ENGINE OIL.....	20-36	PUMP HOSES AND FITTINGS, AUXILIARY HYDRAULIC.....	70-8
PIPE ASSEMBLY, CENTER (80/90°)(15" SS) (LH/RH).....	75-66	PUMP HOUSING, SWASH PLATE AND CYLINDER BLOCK, HYDROSTATIC.....	50-30
PIPE, CENTER (80/90°)(15" SS).....	75-68	PUMP MOUNTING, HYDROSTATIC.....	50-2
PIPE, EXHAUST.....	20-10	PUMP SHAFT, HYDROSTATIC.....	50-28
PIPE, OUTER PIVOT (80/90°)(15" SS).....	75-60	PUMP VALVES, HYDROSTATIC.....	50-22
PIPE, 1ST INNER (80/90°)(15" SS) (LH/RH).....	75-62	PUMP, AUXILIARY HYDRAULIC.....	70-20
PIPE, 2ND INNER (80/90°)(15" SS ) (LH/RH).....	75-64	PUMP, ENGINE OIL.....	20-48
PIPES, HOSES, FEEDER (80/90' BOOM).....	75-42	PUMP, FUEL INJECTION.....	30-14
PIPES, SPRAYMASTER CUSTOM PLUMBING (80/90' BOOM).....	75-46	PUMP, HYDROSTATIC CHARGE.....	50-26
PIPES, SPRAYMASTER CUSTOM PLUMBING (80/90' BOOM).....	75-54	PUMP, SOLUTION.....	80-34
PISTON RINGS.....	20-40	PUMP, WATER.....	20-44
PISTON, AUXILIARY HYDRAULIC PUMP.....	70-20	PUMP, FUEL TRANSFER W/STRAIGHT FLEX FITTINGS.....	30-17
PISTON, ENGINE.....	20-40	PUSH ROD.....	20-30
PISTON, HYDROSTATIC PUMP.....	50-28		
PIVOT (80/90' BOOM).....	75-34	<b>Q</b>	
PIVOT PIPE, OUTER (80/90°)(15" SS).....	75-60	QUICK FILL (2").....	80-26
PIVOT RELEASE PEDAL.....	60-8	QUICK FILL (3").....	80-24
PIVOT SHAFT, HOOD.....	100-48	QUICK FILL, FOAM MARKER.....	80-75
PIVOT, CENTER FRAME (80/90' BOOM).....	75-34		
PIVOT, OPERATOR'S SEAT.....	90-26	<b>R</b>	
PIVOT, STEERING COLUMN.....	60-4	RADAR SENSOR AND BRACKET.....	40-30
PIVOTS, BREAKAWAY WING (80/90' BOOM).....	75-30	RADIATOR AND HOSES.....	20-22
PLANETARY HUB (FRONT) (23.5:1 RATIO).....	50-34	RADIATOR BRACKETS, SEALS AND CHANNELS.....	20-18
PLANETARY HUB (REAR)(30.1:1 RATIO).....	50-36	RADIO.....	40-24
PLASTIC (POLY) SOLUTION TANK.....	80-4	RADIO BEZEL.....	40-24
PLATE, CAMSHAFT.....	20-34	RADIO BEZEL BRACKET.....	40-24
PLATE, DRIVE SHAFT GUARD.....	50-33	RADIO SPEAKER.....	40-34
PLATE, FRONT.....	20-41	RAIL, FUEL INJECTION LINE.....	30-14
PLATFORM LIGHTS.....	40-36	REAR AXLE.....	100-22
PLATFORM, HANDRAILS, RIGHT HAND.....	100-12	REAR HOOD SUPPORT.....	100-34
PLATFORM, LEFT-HAND.....	100-6	REAR HUB, (30.1:1 RATIO).....	50-36
PLATFORM, LEFT-HAND.....	100-8	REAR OIL SEAL, CRANKSHAFT.....	20-43
PLUG, AIR HEATER.....	30-12	REAR SPEAKER KIT.....	40-31
PLUG, ENGINE OIL PAN DRAIN.....	20-36	REAR SUSPENSION.....	100-24
PLUGS, SEALS, HYDROSTATIC PUMP.....	50-22	REAR UPHOLSTERY (CAB).....	90-44
PLUMBING, SPRAYMASTER CUST.(80/90' BOOM) CENTER WING.....	75-46	REAR VIEW MIRROR.....	90-73
PLUMBING, SPRAYMASTER CUSTOM (80/90' BOOM) INNER, BREAKAWAY, OUTER WINGS.....	75-54	REAR WINDOW.....	90-52
POLY (PLASTIC) SOLUTION TANK.....	80-4	RECEIVER DRYER, A/C.....	90-72
POSITION SWITCH, LADDER.....	40-9	REFLECTORS.....	110-22
POSITIVE BATTERY CABLE.....	40-3	REFRIGERANT / HEATER LINES.....	90-6
POST UPHOLSTERY (CAB).....	90-40	REFRIGERANT LINES (6.8L).....	100-44
POTENTIOMETER, THROTTLE CONTROL.....	40-22	REGULATOR, ON BOARD AIR.....	105-1
POWER STRIP, AUXILIARY.....	40-29	RELAY, JUMPER AND HARNESS.....	40-17

## ALPHABETICAL INDEX - CONTINUED

	PAGE		PAGE
RELIEF VALVE, PRIORITY VALVE (NON-AUTOTRAC).....	70-22	SEAT, SUPER COMFORT, MSG85/MSG95 .....	90-76
REMOTE LADDER SWITCH.....	40-6	SECONDARY FILTER, AIR.....	20-14
REMOTE MIRROR.....	90-46	SECONDARY WING, 60' BOOM.....	65-6
REMOTE SOLUTION PUMP SWITCH.....	40-6	SEDIMENT BOWL, FUEL FILTER.....	30-20
REPAIR PARTS, SPRAY VALVE.....	80-80	SENDER, FUEL.....	30-2
RESERVOIR, HYDRAULIC/HYDROSTATIC OIL.....	70-1	SENSOR, AIR RESTRICTION.....	20-14
RESERVOIR, ON BOARD AIR.....	105-1	SENSOR, AIR TEMPERATURE.....	40-50
RESERVOIR, RADIATOR.....	20-22	SENSOR, CYLINDER POSITION.....	75-38
RESISTOR, HEATER AND A/C.....	90-12	SENSOR, ENGINE OIL PRESSURE.....	40-4
RESTRICTION, AIR SENSOR.....	20-14	SENSOR, ENGINE SPEED.....	40-50
RESTRICTOR, AUXILIARY PUMP HYDRAULIC.....	70-8	SENSOR, FLOWMETER.....	80-90
RESUME SWITCH MODULE, AUTOTRAC.....	93-2	SENSOR, FUEL INJECTION PUMP.....	30-14
RETURN TO HEIGHT LINKAGE.....	75-29	SENSOR, RADAR.....	40-30
RIGHT FRONT WHEEL MOTOR, HOSES, FITTINGS.....	50-10	SENSOR, TACHOMETER DRIVE.....	40-50
RIGHT REAR WHEEL MOTOR, HOSES, FITTINGS.....	50-12	SENSOR, WATER TEMPERATURE.....	40-50
RIGHT-HAND ARMREST ASSEMBLY.....	90-66	SENSOR, WHEEL ANGLE.....	93-6
RIGHT-HAND DOOR.....	90-69	SENSOR, WHEEL SPEED.....	40-10
RIGHT-HAND LADDER AND SUPPORT.....	100-4	SERVICE BRAKE VALVE.....	60-19
RIGHT-HAND LIGHT SUPPORT (60' BOOM).....	100-10	SERVICE BRAKE VALVE HOSES AND FITTINGS.....	50-4
RIGHT-HAND LIGHT SUPPORT (80/90' BOOM).....	100-11	SERVICE KIT, ELECTRICAL CONNECTORS.....	40-58
RIGHT-HAND PLATFORM AND HANDRAILS.....	100-12	SERVICE KIT, ELECTRICAL CONNECTORS.....	40-60
RIM, WHEEL.....	50-8	SERVO ASSEMBLY, HYDROSTATIC PUMP.....	50-28
RING GEAR, FLYWHEEL.....	20-42	SHAFT, DRIVE.....	50-33
RINGS, PISTON.....	20-40	SHAFT, HOOD CONTROL PIVOT.....	100-48
RINSE LINE, EDUCTOR , UPPER.....	80-46	SHAFT, HYDROSTATIC CHARGE PUMP DRIVE.....	50-26
RINSE TANK.....	80-36	SHAFT, HYDROSTATIC PUMP.....	50-28
RINSE TANK SUPPORTS AND SHIELDS.....	80-38	SHAFT, ROCKER ARM.....	20-30
RINSE TANK, CLEAN WATER.....	80-79	SHAFT, STEERING.....	60-6
RISER, CAB FLOOR.....	90-22	SHIELD, DRIVE SHAFT.....	50-33
ROCKER ARM, SHAFT, TAPPET AND PUSH ROD.....	20-30	SHIELD, FAN.....	20-1
ROCKER ASSEMBLY (80/90' BOOM).....	75-30	SHIELD, RINSE TANK.....	80-38
ROCKER ASSEMBLY, CENTER FRAME (80/90' BOOM).....	75-38	SHIELDS, CROP.....	100-26
ROD, CONNECTING.....	20-40	SHIELDS, FLYWHEEL.....	20-2
ROD, PUSH.....	20-30	SHIELDS, FRONT WHEEL.....	100-28
ROLL BIAS CYLINDER (80/90' BOOM).....	75-4	SHIELDS, WHEEL MOTOR.....	100-30
ROLL BIAS VALVE.....	75-1	SHIELDS, WHEEL MOTOR.....	100-32
ROOF SIDE LIGHTS.....	40-35	SHIFT VALVE.....	50-18
ROOF WIRING HARNESS.....	40-16	SHOCK ABSORBERS (80/90' BOOM).....	75-36
ROOF, INNER.....	90-8	SHOE, TRANSPORT BRACKET (60' BOOM).....	65-23
ROOF, OUTER.....	90-9	SHORT BLOCK ASSEMBLY, ENGINE.....	20-32
ROTARY BEACON LIGHT KIT (EXPORT).....	40-66	SHROUD, FAN.....	20-16
ROTARY BEACON LIGHT KIT (EXPORT).....	95-4	SHUT OFF VALVE, FOAM MARKER.....	80-68
		SIDE COVERS, CAB.....	100-40
		SIDE LIGHT.....	40-38
		SIDE PANEL ASSEMBLY.....	100-36
		SIGHT TUBE, HYDRAULIC/HYDROSTATIC OIL RESERVOIR.....	70-1
		SINGLE FLOWMETER WITH STANDARD PUMP.....	65-28
		SINGLE NOZZLE ASSEMBLY, SPRAYMASTER (60 FT. BOOM).....	65-25
		SMV EMBLEM (80/90' BOOM).....	75-24
		SMV EMBLEM AND BRACKET.....	100-37
		SOLENOID VALVE (60' BOOM).....	65-20
		SOLENOID VALVE (80/90' BOOM, BASIC).....	75-14
		SOLENOID VALVE, COMBINATION VALVE.....	70-10
		SOLUTION FILTER AND FLOW METER (-5000).....	80-12
		SOLUTION FILTER AND FLOW METER (5001-).....	80-14
		SOLUTION HOSES AND FITTINGS, CENTERFRAME.....	80-16
		SOLUTION PRESSURE HOSES AND FITTINGS.....	80-10
		SOLUTION PUMP AND MOTOR.....	80-34
		SOLUTION PUMP MOTOR AND FILTER HOSES.....	70-14
		SOLUTION PUMP SWITCH, REMOTE.....	40-6
		SOLUTION TANK BOTTOM FITTINGS AND HOSES.....	80-8
		SOLUTION TANK HOSES AND FITTINGS (TOP).....	80-2
		SOLUTION TANK SUPPORT.....	80-50
<b>S</b>			
S-LINK ASSEMBLY (80/90' BOOM).....	75-45		
SAFETY DECALS.....	110-2		
SAFETY DECALS (PORTUGUESE).....	110-4		
SAFETY SWITCH, NEUTRAL START.....	50-32		
SEAL KIT, FOLD CYLINDER, 60' BOOM.....	65-11		
SEAL KIT, LEVELING CYLINDER, 60' BOOM.....	65-10		
SEAL KIT, NOZZLE ASSEMBLY, 1" PIPE.....	75-50		
SEAL, CRANKSHAFT REAR OIL.....	20-43		
SEAL, FRONT.....	20-44		
SEAL, WINDSHIELD.....	90-50		
SEALS AND BUSHINGS, FRONT SUSPENSION.....	100-16		
SEALS AND BUSHINGS, REAR SUSPENSION.....	100-20		
SEALS, FRONT GRILLE.....	100-53		
SEALS, PLUGS, HYDROSTATIC PUMP.....	50-22		
SEALS, RADIATOR.....	20-18		
SEAT BELT, INSTRUCTIONAL SEAT.....	90-24		
SEAT, INSTRUCTIONAL.....	90-24		
SEAT, OPERATOR'S.....	90-25		



## ALPHABETICAL INDEX - CONTINUED

	PAGE		PAGE
SOLUTION TANK, POLY (PLASTIC)	80-4	SUPER COMFORT SEAT SUSPENSION	90-78
SOLUTION TANK, STAINLESS STEEL	80-6	SUPPLEMENTARY TERMINALS AND CONNECTORS	40-64
SOLUTION VALVE, BOOM		SUPPORT, FENDER	100-30
(- 5000)	80-28	SUPPORT, FENDER	100-32
SOLUTION VALVE, BOOM		SUPPORT, LIGHT, RH (60' BOOM)	100-10
(5001 - )	80-30	SUPPORT, PROPULSION CABLE	90-20
SPEAKER KIT, REAR	40-31	SUPPORT, R.H. HANDRAILS (80/90' BOOM)	100-11
SPEAKER, RADIO	40-34	SUPPORT, RIGHT-HAND LADDER	100-4
SPEED LEVER CONTROL	90-56	SUPPORT, RINSE TANK	80-38
SPEED SENSOR, WHEEL	20-39	SUPPORT, SOLUTION TANK	80-50
SPEED SENSOR, WHEEL	40-10	SUPPORT, TRANSPORT (60' BOOM)	65-23
SPEED, ENGINE SENSOR	40-50	SUPPORT,HOOD	100-48
SPINDLE, HUB, FRONT (23.5:1 RATIO)	50-34	SUPPORT,REAR HOOD	100-34
SPINDLE, HUB, REAR (30.1:1 RATIO)	50-36	SUPPORTS, FUEL TANK	30-4
SPRAY MANAGEMENT GUIDE	80-91	SUPPORTS, MAIN FRAME	100-2
SPRAY RATE CONTROL UNIT	40-12	SUSPENDED CENTER FRAME, (80/90' BOOM)	75-32
SPRAY TIPS, EXTENDED RANGE	80-86	SUSPENSION, FRONT	100-18
SPRAY TIPS, HIGH FLOW	80-86	SUSPENSION, REAR	100-24
SPRAY TIPS, HOLLOW CONE	80-87	SWASHPLATE, HYDROSTATIC PUMP	50-30
SPRAY TIPS, ULTRA LOW DRIFT	80-85	SWITCH, BOOM FOLD FOOT CONTROL	40-8
SPRAY VALVE REPAIR PARTS	80-80	SWITCH, DOME LIGHT	40-42
SPRAYMASTER CUSTOM PLUMBING (80/90' BOOM)		SWITCH, DOOR LIGHT	40-43
CENTER WING	75-46	SWITCH, KEY AND START AID	40-1
SPRAYMASTER CUSTOM PLUMBING(80/90' BOOM)		SWITCH, LADDER POSITION	40-9
INNER, BREAKAWAY, OUTER WINGS	75-54	SWITCH, NEUTRAL START SAFETY	50-32
SPRAYMASTER SINGLE NOZZLE ASSEMBLY		SWITCH, OUTER WING CYLINDER	
(60 FT. BOOM)	65-25	(80/90' BOOM)	75-22
SPRING LEVELING, AUTO AIR	100-54	SWITCH, REMOTE SOLUTION PUMP	40-6
SPRING, AIR, FRONT SUSPENSION	100-18	SWITCH, STARTER MOTOR (DENSO)	40-48
SPRING, AIR, REAR SUSPENSION	100-24	SWITCHES, R.H. CONSOLE	40-26
SPRING, HOOD PIVOT	100-48	SYSTEM, FUEL INJECTION	30-14
SPRING, VALVE	20-26		
SPRINGS, EXTENSION (80/90' BOOM)	75-34	T	
STABILIZER, LIFT ARM (60' BOOM)	65-18	TACHOMETER DRIVE SENSOR	40-50
STAINLESS STEEL SOLUTION TANK	80-6	TANK SUPPORT, SOLUTION	80-50
STANDARD BOOM TILT CYLINDER(80/90' BOOM)	75-2	TANK SUPPORTS, FUEL	30-4
STANDARD HOOD LIGHTING	40-54	TANK SUPPORTS, RINSE	80-38
START AID SWITCH	40-1	TANK, AIR	105-4
STARTER MOTOR KIT (DENSO)	40-48	TANK, CLEAN WATER RINSE	80-79
STARTER MOTOR SWITCH (DENSO)	40-48	TANK, FOAM MARKER	
STARTING MOTOR (DENSO)	40-48	(50 GALLON)	80-64
STATOR, A/C	90-4	TANK, FOAM MARKER	
STEERING ARM	100-14	(50 GALLON)	80-66
STEERING COLUMN PIVOT	60-4	TANK, FOAM MARKER (12 VOLT AND OBA)	
STEERING COLUMN PIVOT		(35 GALLON)	80-62
(AUTOTRAC)	93-1	TANK, FUEL	30-2
STEERING CONTROL VALVE, NON AUTOTRAC	60-12	TANK, HYDRAULIC/HYDROSTATIC OIL	70-1
STEERING CONTROLLER, AUTOTRAC	93-10	TANK, POLY (PLASTIC) SOLUTION	80-4
STEERING CYLINDER	60-13	TANK, RINSE	80-36
STEERING HOSES AND FITTINGS	60-10	TANK, STAINLESS STEEL SOLUTION	80-6
STEERING LIGHTS, FRONT	40-41	TAPPET, ROCKER ARM	20-30
STEERING SHAFT	60-6	TEMPERATURE CONTROL CABLE	90-12
STEERING VALVE BRACKET	60-9	TENSIONER, BELT	20-4
STEERING VALVE, AUTOTRAC	93-8	TERMINAL AND WIRING KIT	40-62
STEERING WHEEL	60-2	TERMINAL, BATTERY	40-3
STOP, INTERMEDIATE WING, 60' BOOM	65-2	TERMINALS AND CONNECTORS, SUPPLEMENTARY	40-64
STOPS, CENTERFRAME (80/90' BOOM)	75-38	TERMINALS, ELECTRICAL, WEATHERPACK	40-56
STORAGE COMPARTMENT, LH PLATFORM	100-8	THERMOSTAT AND COVER	20-62
STRAINER, BOOM HOSE	75-53	THERMOSTAT HOUSING	20-61
STRAINER, FUEL TANK	30-2	THERMOSTAT, HEATER AND A/C	90-12
STRAINER, HYDRAULIC/HYDROSTATIC OIL		THROTTLE CONTROL	40-22
RESERVOIR	70-1	TIGHTENER, FAN	20-4
STRAINER, 2" QUICK FILL	80-26	TIMING GEAR COVER	20-44
STRAINER, 3" QUICK FILL	80-24	TOE CONTROL VALVE, BRACKET AND FITTINGS	70-30
STRAP, ENGINE LIFT	20-25	TRACTION CONTROL VALVE	70-24
SUNSHADE KIT, FRONT	90-73		
SUPER COMFORT SEAT MSG85/MSG95	90-76		

## ALPHABETICAL INDEX - CONTINUED

	PAGE		PAGE
TRANSPORT BRACKET (60' BOOM) .....	65-23	VENTILATING SYSTEM, ENGINE .....	20-28
TRANSPORT BRACKETS .....	100-38	VENTURI TEE, EDUCTOR .....	80-46
TREAD ADJUST CYLINDER .....	70-26		
TREAD ADJUSTING VALVE .....	70-18		
TREAD ADJUSTING VALVES, HOSES AND FITTINGS .....	70-16	<b>W</b>	
TRIPLET NOZZLE ASSEMBLY, CUSTOM KIT (60' BOOM) .....	65-22	WARNING LAMP .....	40-51
TRIPLET NOZZLE ASSEMBLY, CUSTOM KIT (80'/90' BOOM) .....	75-47	WARNING LAMP (60' BOOM) .....	40-40
TRIPLET NOZZLE KIT .....	65-26	WARNING LAMP (80/90' BOOM) .....	40-39
TUBE, BY-PASS (WATER PUMP) .....	20-61	WATER PUMP .....	20-44
TUBE, FUEL INJECTOR FEED .....	30-16	WATER PUMP INLET .....	20-46
TUBE, OIL DIPSTICK .....	20-12	WATER PUMP PULLEY .....	20-60
TUBES, PREDRILLED (80/90' BOOM) .....	75-52	WATER VALVE .....	90-12
TURBOCHARGER .....	30-9	WEAR PLATES, END MOUNTING BRACKETS (80/90' BOOM) .....	75-36
TURBOCHARGER OIL LINES .....	30-10	WEATHERPACK TERMINALS AND CONNECTORS .....	40-56
TURNBUCKLE, 60' BOOM .....	65-4	WHEEL ANGLE SENSOR .....	93-6
		WHEEL BOLT, FRONT (23.5:1 RATIO) .....	50-34
<b>U</b>		WHEEL BOLT, REAR (30.1:1 RATIO) .....	50-36
ULTRA LOW DRIFT SPRAY TIPS .....	80-85	WHEEL DRIVE HOSES AND FITTINGS .....	50-6
UPHOLSTERY, FENDER, (CAB) .....	90-36	WHEEL MOTOR .....	50-18
UPHOLSTERY, POST (CAB) .....	90-40	WHEEL MOTOR SHIELDS .....	100-30
UPHOLSTERY, REAR (CAB) .....	90-44	WHEEL MOTOR SHIELDS .....	100-32
UPPER EDUCTOR FITTINGS AND HOSES .....	80-46	WHEEL SHIELDS, FRONT .....	100-28
		WHEEL SPEED SENSOR AND WIRING HARNESS .....	40-10
<b>V</b>		WHEEL, SPEED SENSOR .....	20-39
VALVE (60' BOOM) .....	65-20	WHEEL, STEERING .....	60-2
VALVE (80/90' BOOM, BASIC) .....	75-14	WHEELS AND HUBS .....	50-8
VALVE COVER .....	20-29	WINDOW, FRONT .....	90-50
VALVE HOSES, FITTINGS, FOLD CYLINDER 60' BOOM .....	65-12	WINDOW, REAR .....	90-52
VALVE HOSES, FITTINGS, LEVELING CYLINDER 60' BOOM .....	65-14	WINDSHIELD .....	90-50
VALVE SEAT INSERTS .....	20-26	WINDSHIELD WASHER KIT .....	90-37
VALVE, AGITATION .....	80-94	WINDSHIELD WIPER, FRONT AND REAR .....	90-48
VALVE, BOOM SOLUTION ( - 5000) .....	80-28	WING SECTION VALVE, INNER .....	80-96
VALVE, BOOM SOLUTION (5001 - ) .....	80-30	WING, BREAKAWAY (80/90' BOOM) .....	75-30
VALVE, COMBINATION .....	70-10	WING, BREAKAWAY, 60' BOOM .....	65-6
VALVE, ELECTRIC BALL (EXPORT) .....	95-2	WING, INTERMEDIATE, 60' BOOM .....	65-2
VALVE, EXHAUST .....	20-26	WING, SECONDARY, 60' BOOM .....	65-6
VALVE, HYDROSTATIC PUMP .....	50-22	WIPER, WINDSHIELD, FRONT AND REAR .....	90-48
VALVE, INNER WING SECTION .....	80-96	WIRE HARNESS, FUEL INJECTOR .....	30-14
VALVE, INTAKE .....	20-26	WIRING AND TERMINAL KIT .....	40-62
VALVE, PARK BRAKE .....	50-20	WIRING HARNESS AND BRACKETS, GREENSTAR_t..... m	040-4
VALVE, PRIORITY (AUTOTRAC) .....	93-4	WIRING HARNESS, (12 VOLT) DUAL OPTION .....	80-78
VALVE, PRIORITY (NON-AUTOTRAC) .....	70-22	WIRING HARNESS, ARMREST .....	40-14
VALVE, RINSE TANK QUICK FILL .....	80-36	WIRING HARNESS, AUTOTRAC .....	93-2
VALVE, ROLL BIAS .....	75-1	WIRING HARNESS, BEACON AND BRAKE LIGHTS (EXPORT) .....	95-6
VALVE, SERVICE BRAKE .....	60-19	WIRING HARNESS, BOOM (60' BOOM) .....	65-24
VALVE, SHIFT .....	50-18	WIRING HARNESS, BOOM (80/90' BOOM) .....	75-10
VALVE, STEERING CONTROL, NON AUTOTRAC .....	60-12	WIRING HARNESS, BOOM (80/90' BOOM) .....	75-12
VALVE, TOE CONTROL .....	70-30	WIRING HARNESS, CAB .....	40-18
VALVE, TRACTION CONTROL .....	70-24	WIRING HARNESS, CAB .....	40-20
VALVE, TREAD ADJUSTING .....	70-16	WIRING HARNESS, CHASSIS .....	40-6
VALVE, TREAD ADJUSTING .....	70-18	WIRING HARNESS, ENGINE .....	40-4
VALVE, WATER .....	90-12	WIRING HARNESS, GLOW PLUG .....	40-52
VALVE, 2" QUICK FILL .....	80-26	WIRING HARNESS, HEADLAMP .....	40-32
VALVE, 3" QUICK FILL .....	80-24	WIRING HARNESS, KEY, START AID SWITCHES .....	40-1
VALVE, 5 SECTION, 60' BOOM .....	65-12	WIRING HARNESS, PROPULSION CONTROL .....	90-56
VALVE, 5 SECTION, 60' BOOM .....	65-14	WIRING HARNESS, RELAY .....	40-17
		WIRING HARNESS, ROOF .....	40-16
		WIRING HARNESS, ROTARY BEACON LIGHT (EXPORT) .....	40-66
		WIRING HARNESS, ROTARY BEACON LIGHT (EXPORT) .....	95-4
		WIRING HARNESS, WHEEL SPEED SENSOR .....	40-10

# 10-16

4720 SELF-PROPELLED SPRAYER

---

MEMORANDA

# 20-1

ENGINE

## FAN SHIELDS

RXA0073643

-UN-24FEB04

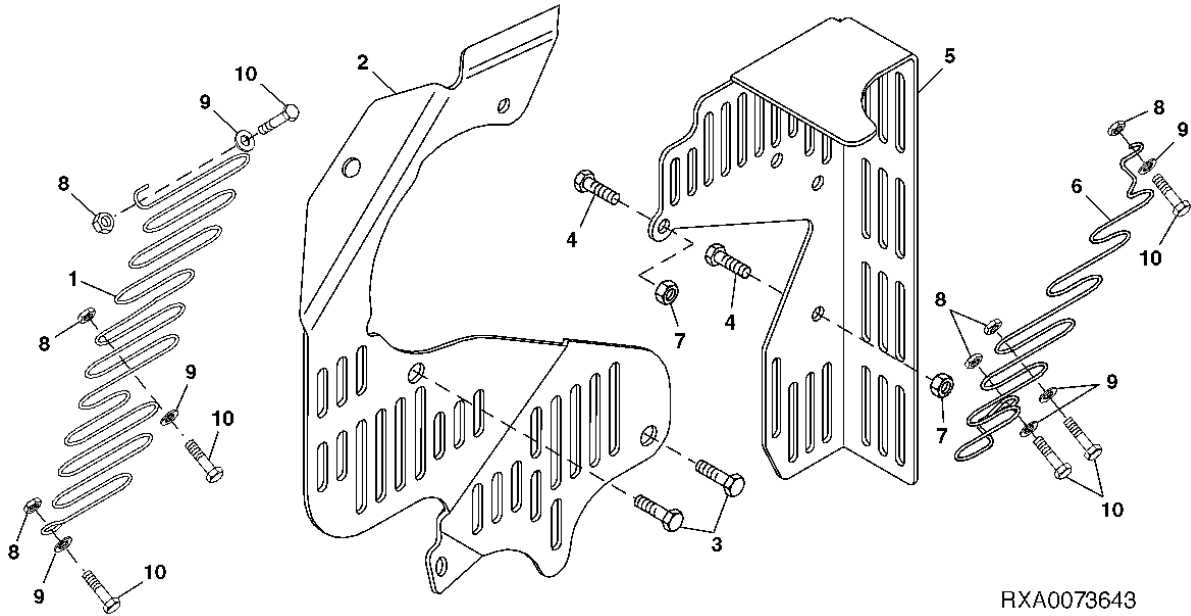

RXA0073643

KEY	PART NO.	PART NAME	QTY.	SERIAL NO.	REMARKS
1	RE219437	GUARD	1		
2	R218411	GUARD	1		
3	19M7811	SCREW	2		M10 X 90
4	19M7867	SCREW	2		M8 X 25
5	R218553	GUARD	1		
6	RE219615	GUARD	1		
7	14M7298	FLANGE NUT	2		M8
8	R214420	NUT	6		
9	24M7139	WASHER	6		6.400 X 18 X 1.600 MM
10	19M8627	SCREW	6		M6 X 20