

SERVICE REPAIR

MANUAL

Hyster C177 (H40XL, H50XL, H60XL) Forklift

HYSTER

PERIODIC MAINTENANCE

S/H1.25–1.75XL (S/H25–35XL)

S2.00–3.00XL (S40–60XL)

H2.00–3.00XL (H40–60XL)

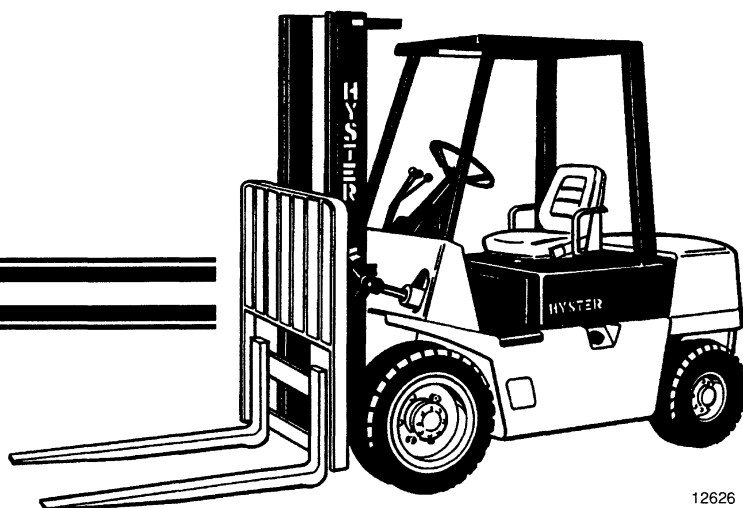

HYSTER

SAFETY PRECAUTIONS

MAINTENANCE AND REPAIR

- When lifting parts or assemblies, make sure that all slings, chains or cables are correctly fastened and that the load being lifted is balanced. Make sure that the crane, cables and chains have the capacity to support the weight of the load.
- Do not lift heavy parts by hand. Use a lifting mechanism.
- Wear safety glasses.
- **DISCONNECT THE BATTERY CONNECTOR** before doing any maintenance or repair on electric lift trucks. Disconnect the battery ground cable on internal combustion lift trucks.
- Always use correct blocks to prevent the unit from rolling or falling. See “How To Put The Lift Truck On Blocks” in the **OPERATING MANUAL** or the **PERIODIC MAINTENANCE** section.
- Keep the unit and working area clean and in order.
- Use the correct tools for the job.
- Keep the tools clean and in good condition.
- Always use **HYSTER APPROVED** parts when making repairs. Replacement parts must meet or exceed the specifications of the original equipment manufacturer.
- Make sure that all nuts, bolts, snap rings and other fastening devices are removed before using force to remove parts.
- Always fasten a **DO NOT OPERATE** sign to the controls of the unit when making repairs or if the unit needs repairs.
- Make sure you follow the **DANGER, WARNING** and **CAUTION** notes in the instructions.
- Gasoline, Liquid Petroleum Gas (LPG), and Diesel are flammable fuels. Make sure that you follow the necessary safety precautions when handling these fuels and when working on these fuel systems.
- Batteries generate flammable gas when they are being charged. Keep fire and sparks away from the area. Make sure the area has ventilation.

CONTENTS

PERIODIC MAINTENANCE	1	EVERY 250 HOURS OR TWO MONTHS ..	18
GENERAL	1	ENGINE OIL AND FILTER	18
Serial Number Data	1	Mazda, GM, And Later Production Isuzu Engines ...	18
HOW TO MOVE A DISABLED LIFT TRUCK	2	Earlier Production Isuzu C240 Engines .	18
How To Tow the Lift Truck	2	GOVERNOR, MAZDA ENGINE	19
HOW TO PUT A LIFT TRUCK ON BLOCKS	2	DRIVE BELTS	19
How To Raise the Drive Tires	2	Mazda Engine	19
How To Raise the Steering Tires	3	Isuzu, GM 4-181, And GM 4-153 Engines	19
MAINTENANCE PROCEDURES	7	BRAKE FLUID	19
EVERY 8 HOURS OR DAILY	7	HYDRAULIC TANK BREATHER, CLEAN AND CHECK	20
HOW TO MAKE CHECKS WITH THE ENGINE STOPPED	7	FORKS, CHECK FOR WEAR AND DAMAGE	20
Engine Oil	7	LIFT CHAINS	20
Drive Belts	7	Lubrication	20
Cooling System	7	Check For Wear	20
Battery	8	MAST, LUBRICATION	21
Fuel System	10	TIE ROD ENDS AND PIVOT SHAFT, STEERING AXLE	21
Air Filter	10	CONTROL LEVERS AND PEDALS, LUBRICATION	22
Hydraulic System Oil	10	FUEL SYSTEM, CHECKS AND ADJUSTMENTS	22
Tires and Wheels	11	Idle Speed, Diesel	22
Forks	11	LPG Carburetor	22
Forks, Adjustment	12	Gasoline Carburetor	23
Forks, Removal And Installation	12	EVERY 1000 HOURS OR SIX MONTHS ..	24
Inspection Of Forks, Mast, and Lift Chains	13	DIESEL FUEL FILTER	24
Safety Labels	14	Filter Replacement, Models Without A Water Separator	24
Operator Restraint System	14	Filter Replacement, Models With A Water Separator	25
HOW TO MAKE CHECKS WITH THE ENGINE RUNNING	15	Remove Air from the Diesel Fuel System	25
Gauges, Lights, Horn, and Fuses	15	DIFFERENTIAL	26
Fuel Filter, Diesel Engine	16	VALVE CLEARANCE ADJUSTMENT ...	26
How To Drain The Water From The Fuel Filter	16	IGNITION SYSTEM, MAZDA AND GM ENGINES	26
Oil Level, Powershift Transmission	16	PCV VALVE AND FILTER	27
Control Levers and Pedals	16	EVERY 2000 HOURS OR YEARLY	27
Lift System Operation	16	HYDRAULIC SYSTEM	27
Inching/Brake Pedal	17	Replace the Hydraulic Oil And Filter ...	27
Service Brakes	17	POWERSHIFT TRANSMISSION	28
Parking Brake	17		
Steering System	17		

**Thanks very much for your reading,
Want to get more information,
Please click here, Then get the complete
manual**

JustClickHere 

NOTE:

**If there is no response to click on the link above,
please download the PDF document first, and then
click on it.**

**Have any questions please write to me:
admin@servicemanualperfect.com**

COOLING SYSTEM	28	FUEL INJECTORS	34
SERVICE BRAKES	28	WELDING REPAIRS	34
DIFFERENTIAL	29	CHANGES TO THE OVERHEAD GUARD	34
WHEEL BEARINGS	29	WHEELS AND TIRES	34
Steering Wheels, lubrication	29	Solid Rubber Tires (Press-on)	34
Drive Wheels, Lubrication	29	Install The Wheels	35
GASOLINE FUEL FILTER, REPLACEMENT	29	Pneumatic Tires, Remove The Wheels From The Lift Truck	36
PCV VALVE, GM ENGINES	29	Pneumatic Tires, Remove The Tire From The Wheel	36
LPG FILTER, REPLACEMENT	30	Pneumatic Tires, Install The Wheel In The Tire	37
FILTER FOR THE FUEL INJECTION PUMP, MODEL PE4A	30	Pneumatic Tires, Add Air To The Tires .	38
GENERAL PROCEDURES	30	Pneumatic Tires, Install the Wheels	39
CHECK THE HOOD LATCH	30	Pneumatic Tires, Installation Procedures, Dual Drive Wheels	39
LIFT CHAIN ADJUSTMENTS	31	SOLID RUBBER TIRES THAT LOOK LIKE PNEUMATIC TIRES	40
SAFETY PROCEDURES WHEN WORKING NEAR THE MAST	32	Remove The Wheels From The Lift Truck	40
CHECK FOR LEAKS IN THE LIFT AND TILT SYSTEM	33	Remove The Tire From The Wheel	40
Check the Lift Cylinders for Leaks	33	Install The Tire On The Wheel	41
Check the Tilt Cylinders for Leaks	33	REFERENCE TABLE	42

This section is for the following models:

S/H1.25-1.75XL (S/H25-35XL),
S2.00-3.00XL (S40-60XL),
H2.00-3.00XL (H40-60XL)

PERIODIC MAINTENANCE

GENERAL

This section contains a MAINTENANCE SCHEDULE and the instructions for maintenance and inspection.

The MAINTENANCE SCHEDULE has time intervals for inspection, lubrication and maintenance for your lift truck. The service intervals are given in both operating hours recorded on the lift truck hour meter, and in calendar time. The recommendation is to use the interval that comes first.

The recommendation for the time intervals are for eight hours of operation per day. The time intervals must be decreased from the recommendations in the MAINTENANCE SCHEDULE for the following conditions:

- a. If the lift truck is used more than eight hours per day.
- b. If the lift truck must work in dirty operating conditions.

Your dealer for Hyster lift trucks has the equipment and trained service personnel to do a complete program of inspection, lubrication, and maintenance. A regular program of inspection, lubrication, and maintenance will help your lift truck give more efficient performance and operate for a longer period of time.

Some users have service personnel and equipment to do the inspection, lubrication, and maintenance shown in the MAINTENANCE SCHEDULE. Service Manuals are available from your dealer for Hyster lift trucks to help users who do their own maintenance.

WARNING

Do not make repairs or adjustments unless you have both authorization and training. Repairs and adjustments that are not correct can make a dangerous operating condition.

WARNING

Do not operate a lift truck that needs repairs. Report the need for repairs immediately. If repair is necessary, put a "DO NOT OPERATE" tag in the operator's area. Remove the key from the key switch.

Serial Number Data

The serial number for the lift truck is found on the nameplate and also on the right-hand side of the frame near the counterweight. The serial number indicates the design series, manufacturing plant, and the year manufactured.

Example: **B177** **B** **4369** **L**
 (1) **(2)** **(3)** **(4)**

(1) The first letter and number of the serial number indicates the design series and the serial code of the lift truck.

Examples: A177 indicates the serial code for this series of lift trucks and includes the H2.00–3.00XL (H40–60XL) models.

B177 indicates the serial code for this series of lift trucks made after April 1990.

C177 indicates the serial code for this series of lift trucks made after June 1990.

A187 indicates the serial code for this series of lift trucks and includes the S2.00–3.00XL (S40–60XL) models.

B/C187 indicates the serial code for later production for this series of lift trucks.

B10 indicates the serial code for this series of lift trucks and includes the S1.25–1.75XL (S25–35XL) models.

C1 indicates the serial code for this series of lift trucks and includes the H1.25–1.75XL (H25–35XL) models.

(2) The second letter identifies the manufacturing plant.
Examples:

A = Scotland
B = Northern Ireland
D = Danville, IL U.S.A.
E = Nijmegen, The Netherlands
S = Australia
V = Berea, KY U.S.A.

(3) The number series indicates the sequence of manufacture where the lift truck was made.

(4) The letter indicates the year of manufacture starting with A = 1980. The letter L = 1990, M = 1991, and N = 1992. (The letters I, O, and Q are not used.)

HOW TO MOVE A DISABLED LIFT TRUCK

WARNING

Use extra caution when towing a lift truck if any of the following conditions exist:

- a. Brakes do not operate correctly.
- b. Steering does not operate correctly.
- c. Tires are damaged.
- d. Traction conditions are bad.
- e. The lift truck must be towed on a slope.

If the engine cannot run, there is no power available for the hydraulic steering system and the service brakes. This condition can make the lift truck difficult to steer and stop. If the lift truck uses power from the engine to help apply the brakes, the application of the brakes will be more difficult. Poor traction can cause the disabled lift truck or towing vehicle to slide. A slope will also make the lift truck more difficult to stop.

Never lift and move a disabled lift truck unless the disabled lift truck **MUST** be moved and cannot be towed. A lift truck used to move a disabled lift truck **MUST** have a capacity rating equal to or greater than the weight of the disabled lift truck. The capacity of the lift truck used to move a disabled lift truck must have a load center equal to half the width of the disabled lift truck. See the nameplate of the disabled lift truck for the approximate total weight. The forks must extend the full width of the disabled lift truck. Put the weight center of the disabled lift truck on load center of the forks. Be careful to not damage the under side of the lift truck.

How To Tow the Lift Truck

1. The towed lift truck must have an operator.
2. Tow the lift truck slowly.
3. Raise the carriage and forks approximately 30 cm (12 inches) from the surface. Install a chain to prevent the carriage and mast channels from moving.

4. If another lift truck is used to tow the disabled lift truck, that lift truck must have an equal or larger capacity than the disabled lift truck. Install approximately 1/2 of a capacity load on the forks of the lift truck that is being used to tow the disabled lift truck. This 1/2 capacity load will increase the traction of the lift truck. Keep the load as low as possible.

5. Use a towing link made of steel that fastens to the tow pins in the counterweights of both lift trucks.

HOW TO PUT A LIFT TRUCK ON BLOCKS

WARNING

The lift truck must be put on blocks for some types of maintenance and repair. The removal of the following assemblies will cause large changes in the center of gravity: mast, drive axle, engine and transmission, and the counterweight. When the lift truck is put on blocks, put additional blocks in the following positions to maintain stability:

- a. Before removing the mast and drive axle, put blocks under the counterweight so that the lift truck can not fall backward.
- b. Before removing the counterweight, put blocks under the mast assembly so that the lift truck can not fall forward.

The surface must be solid, even, and level when the lift truck is put on blocks. Make sure that any blocks used to support the lift truck are solid, one piece units.

NOTE: Some lift trucks have lifting eyes. These lifting eyes can be used to raise the lift truck so that blocks can be installed.

How To Raise the Drive Tires (See FIGURE 1.)

1. Put blocks on each side (front and back) of the steering tires to prevent movement of the lift truck.
2. Put the mast in a vertical position. Put a block under each outer mast channel.
3. Tilt the mast fully forward until the drive tires are raised from the surface.
4. Put additional blocks under the frame behind the drive tires.
5. If the hydraulic system will not operate, use a hydraulic jack under the side of the frame near the front. Make

sure that the jack has a capacity equal to at least half the weight of the lift truck. See the nameplate.

How To Raise the Steering Tires (See FIGURE 1.)

1. Apply the parking brake. Put blocks on both sides (front and back) of the drive tires to prevent movement of the lift truck.

2. Use a hydraulic jack to raise the steering tires. Make sure that the jack has a capacity of at least $\frac{2}{3}$ of the total weight of the lift truck as shown on the nameplate.

3. Put the jack under the steering axle or frame to raise the lift truck. Put blocks under the frame to support the lift truck.

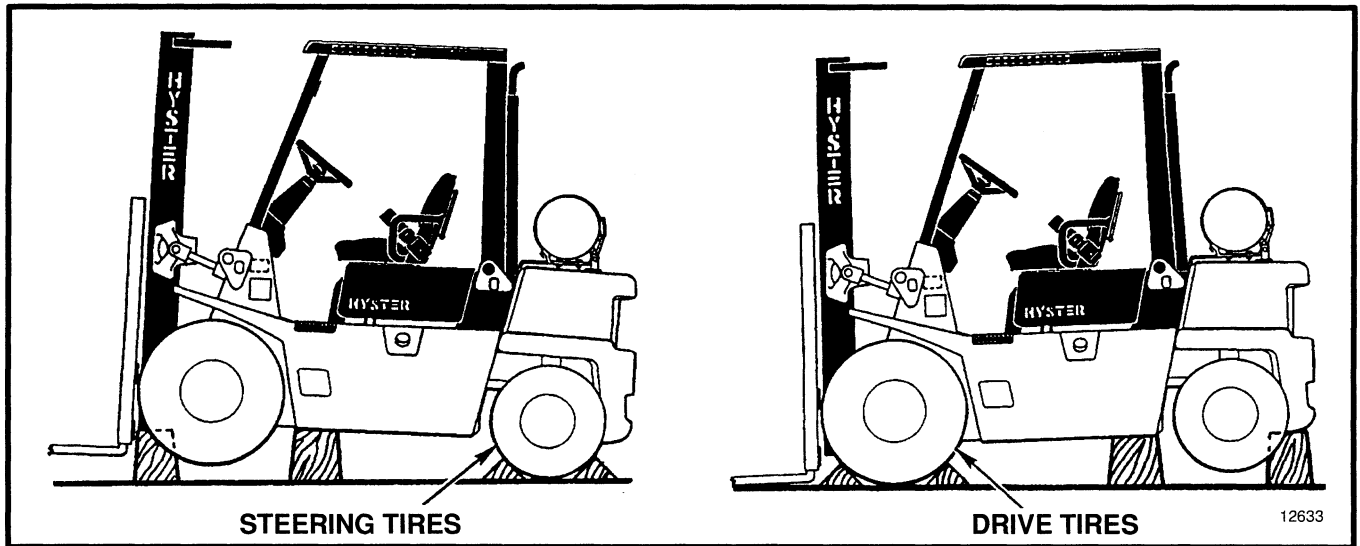

FIGURE 1. PUT A LIFT TRUCK ON BLOCKS

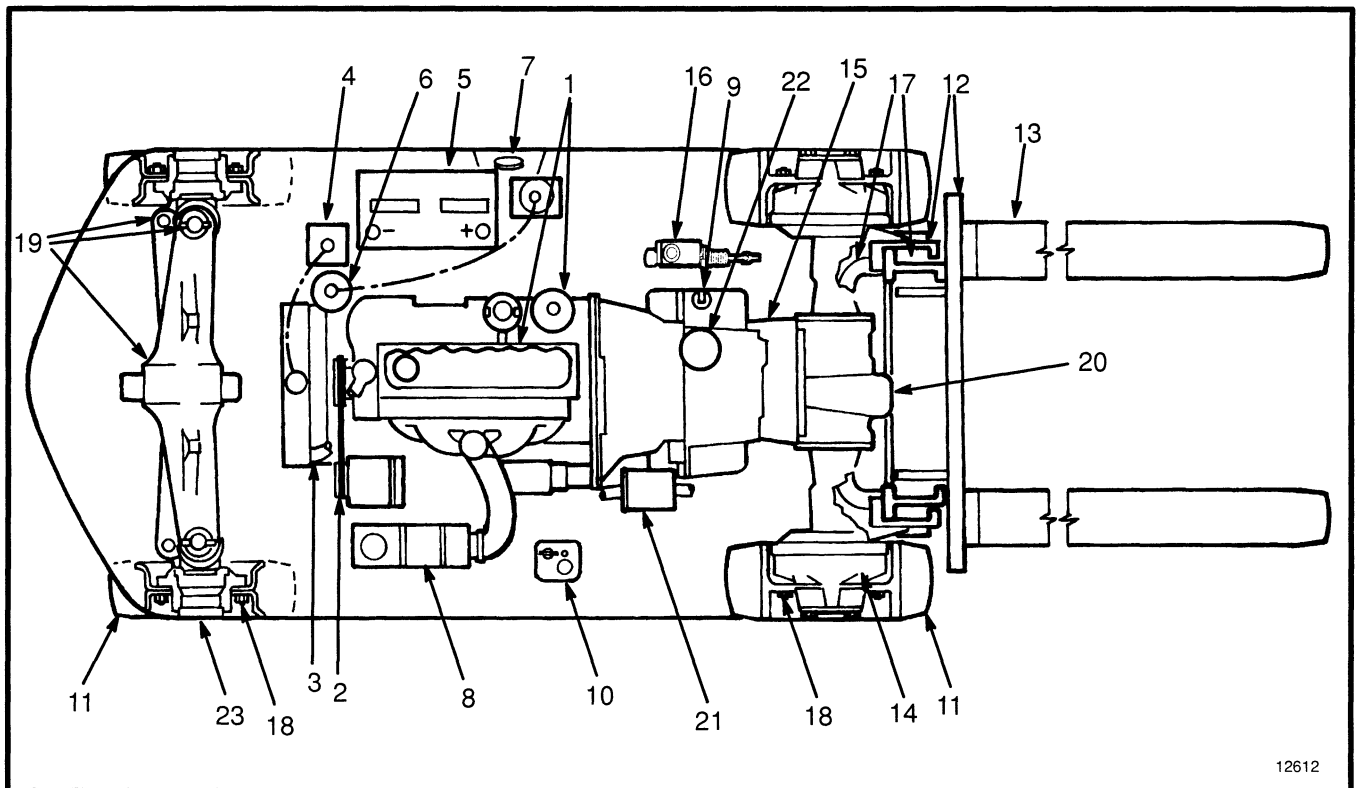

FIGURE 2. MAINTENANCE AND LUBRICATION POINTS

ITEM NO.	ITEM	8 Hr./ Daily	250 Hr./ 6 wk.	1000 Hr./ 6 mo.	2000 Hr./ 1 yr.	PROCEDURE OR QUANTITY	SPECIFICATION
1	ENGINE OIL Mazda 4-121G (Gasoline and LPG)	X	C			5.2 litre (5.5 qt)	API CC/SE/SF/SG, MIL-L-46152 30°C (85°F) and up SAE 30 15-30°C (60-85°F) SAE 30 0-15°C (32-60°F) SAE 20 less than -10°C (15°F) SAE 10W
1	ENGINE OIL GM 4-181 and GM 4-153 (Gasoline and LPG)	X	C			4.3 litre (4.5 qt)	API CC/SE/SF/SG, greater than -18°C (0°F) SAE 10W-30
1	ENGINE OIL Isuzu C240 (Diesel) Isuzu 4JB1 (Diesel)	X	C			5.2 litre (5.5 qt) 6.5 litre (6.9 qt)	API CC/SE/SF/SG, 27°C (80°F) and up SAE 40 0-32°C (32-90°F) SAE 30 less than -7°C (20°F) SAE 10W
2	DRIVE BELTS	X				Check Condition	See Parts Manual
	CHECK FOR LEAKS— FUEL, OIL, WATER	X				Check for Leaks	
3	COOLANT HOSES	X				Check Condition	See Parts Manual
4	COOLING SYSTEM S/H1.25-1.75XL (S/H25-35XL) Mazda 4-121G Isuzu C240 S2.00-3.00XL (S40-60XL) Mazda 4-121G GM 4-181 and GM 4-153 Isuzu C240 H2.00-3.00XL (H40-60XL) Mazda 4-121G GM 4-181 Isuzu C240 Isuzu 4JB1	X			C	7.8 litre (8.2 qt) 8.1 litre (8.6 qt) 7.6 litre (8.0 qt) 11.4 litre (12.0 qt) 8.5 litre (9.0 qt) 11.1 litre (11.8 qt) 11.0 litre (11.7 qt) 11.4 litre (12.0 qt) 11.0 litre (11.7 qt)	50% Water with 50% Ethylene Glycol
5	BATTERY ELECTROLYTE	X				Check Level	
6	FUEL FILTER, DIESEL	X		C		Clean or Replace See NOTE 1	See Parts Manual
7	FUEL TANK S/H1.25-1.75XL (S/H25-35XL) S2.00-3.00XL (S40-60XL) H2.00-3.00XL (H40-60XL)	X				25.0 litre (6.5 gallon) 38.6 litre (10 gallon) 43.5 litre (11.5 gallon)	85 Octane — Gasoline Diesel No. 2 LPG — HD-5
8	AIR FILTER	X				Clean or Replace See NOTE 2	See Parts Manual
9	TRANSMISSION OIL S/H1.25-1.75XL (S/H25-35XL) S2.00-3.00XL (S40-60XL) H2.00-3.00XL (H40-60XL)	X			C	9.0 litre (9.5 qt) 10.4 litre (11 qt) 9.0 litre (9.5 qt)	Hyster Part No. 336831
X= Check C=Change L=Lubricate				NOTE 1: Check indicator light during operation (Lift trucks with serial codes B/C177 and B187 only). NOTE 2: Very dirty conditions will require daily check and clean.			

ITEM NO.	ITEM	8 Hr./ Daily	250 Hr./ 6 wk.	1000 Hr./ 6 mo.	2000 Hr./ 1 yr.	PROCEDURE OR QUANTITY	SPECIFICATION
10	HYDRAULIC SYSTEM (TANK) S/H1.25–1.75XL (S/H25–35XL) S2.00–3.00XL (S40–60XL) H2.00–3.00XL (H40–60XL)	X			C	18.9 litre (20 qt) 30.3 litre (32.0 qt) 31.8 litre (33.6 qt)	–18°C (0°F) and Above SAE 10W API CC or CC/SE/SF/SG
11	TIRES, TIRE PRESSURE	X				See Nameplate	
12	MAST, CARRIAGE, LIFT CHAINS	X				Check Condition	See Parts Manual
13	FORKS	X	X			Check Condition	
	SAFETY LABELS	X				Replace as Necessary	See Parts Manual
	SEAT BELT AND SEAT RAILS	X				Check Condition	
	HOOD AND SEAT LATCHES	X				Check Condition	
	HORN, GAUGES, LIGHTS, ALARMS	X				Check Operation	
14	SERVICE BRAKES AND PARKING BRAKE	X			X	Check Operation Check Condition	
	STEERING & POSITION LATCH	X				Check Operation	
15	TRANSMISSION	X				Check Operation	
16	BRAKE FLUID		X			0.2 litre (0.4 pt)	SAE J–1703
2	DRIVE BELTS		X			Adjust or Replace	See Parts Manual
	BRAKE, INCHING/BRAKE PEDALS		X			Adjust as Required	
1	ENGINE OIL FILTER		C			See NOTE 3	See Parts Manual
10	HYDRAULIC TANK BREATHER		X			Clean or Replace	See Parts Manual
	GOVERNOR OIL, MAZDA 4–121G		C			200 ml (6.8 oz)	Engine Oil
17	MAST PIVOTS SLIDING SURFACES AND LOAD ROLLER SURFACES		L L			2 Fittings As Required	Multi–Purpose Grease See NOTE 4 Multi–Purpose Grease
12	LIFT CHAIN		X, L			As Required	Engine Oil
18	WHEEL NUTS DRIVE WHEELS S/H1.25–1.75XL (S/H25–35XL) S2.00–3.00XL (S40–60XL) H2.00–3.00XL (H40–60XL) STEER WHEELS H2.00–3.00XL (H40–60XL) SPACERS IF DUAL WHEELS ARE INSTALLED (ALL)		X			Check Torque	155 N.m (115 lbf ft) 240 to 305 N.m (175 to 225 lbf ft) 610 to 680 N.m (450 to 500 lbf ft) 237 to 305 N.m (175 to 225 lbf ft) 98 N.m (80 lbf ft)
X= Check C=Change L=Lubricate NOTE 3: Change filters on new lift trucks after first 100 hours. NOTE 4: Multi–Purpose Grease with 2 to 4% Molybdenum Disulfide.							

ITEM NO.	ITEM	8 Hr./ Daily	250 Hr./ 6 wk.	1000 Hr./ 6 mo.	2000 Hr./ 1 yr.	PROCEDURE OR QUANTITY	SPECIFICATION
19	STEERING AXLE S/H1.25–1.75XL (S/H25–35XL) PIVOT PIN TIE RODS H2.00–3.00XL (H40–60XL) PIVOT PIN TIE RODS KING PIN BEARINGS (UPPER AND LOWER) S2.00–3.00XL (S40–60XL) KING PIN BEARINGS (LOWER)		L			1 Fitting 4 Fittings 1 Fitting 4 Fittings 2 Fittings 2 Fittings	Multi-Purpose Grease See NOTE 4
	ENGINE SPEED IDLE SPEED Mazda & GM 4–153 GM 4–181 Isuzu C240 Isuzu 4JB1 GOVERNED SPEED S/H1.25–1.75XL (all units) (S/H25–35XL) S2.00–3.00XL (S40–60XL) Mazda 4–121G GM 4–181 and GM 4–153 (B187) GM 4–181 (C187) Isuzu C240 H2.00–3.00XL (H40–60XL) Mazda 4–121G GM 4–181 Isuzu C240 Isuzu 4JB1		X			Adjust as Required	600 to 650 rpm 550 to 600 rpm 600 to 650 rpm 750 to 800 rpm 2600 to 2700 rpm 2700 to 2800 rpm 2550 to 2650 rpm 2700 to 2800 rpm 2500 to 2600 rpm 2900 to 3000 rpm 2700 to 2800 rpm 2900 to 3000 rpm 2250 to 2350 rpm
	PCV VALVE, GM ENGINES			X	C	Replace as Necessary	See Parts Manual
20	DIFFERENTIAL OIL S2.00–3.00XL (S40–60XL) H2.00–3.00XL (H40–60XL)			X	C	3.8 litre (4.0 qt) 7.6 litre (8.0 qt)	SAE 80W–90, 85W–140
	TIMING MAXDA 4–121G GM 4–153 only GM 4–181 ISUZU C240 ISUZU 4JB1			X		Adjust as Required	Gasoline – 9° BTDC LPG – 18° BTDC at 625 rpm 8° BTDC at 600 rpm Electronic Control 14° BTDC Static 16° BTDC Static
X= Check C=Change L=Lubricate NOTE 4: Multi-Purpose Grease with 2 to 4% Molybdenum Disulfide.							

ITEM NO.	ITEM	8 Hr./ Daily	250 Hr./ 6 wk.	1000 Hr./ 6 mo.	2000 Hr./ 1 yr.	PROCEDURE OR QUANTITY	SPECIFICATION
	VALVE ADJUSTMENT MAXDA 4-121G GM 4-181 and GM 4-153 ISUZU C240 ISUZU 4JB1			X		Adjust as Required	0.30 mm (0.012 in) Hot Not Adjustable 0.45 mm (0.018 in) Cold 0.40 mm (0.016 in) Cold
	SPARK PLUGS MAXDA 4-121G GM 4-181 and GM 4-153			C		4 4	0.7 to 0.8 mm (0.028 to 0.032 in) See Parts Manual 1.1 mm (0.045 in) See Parts Manual
	PEDALS, LEVERS, SEAT RAILS, CABLES, HINGES, LINKAGES, HOOD LATCH			L		Lubricate as Necessary	Hyster Part No. 328388
	FUEL FILTER, GASOLINE & LPG				C	1	See Parts Manual
21	HYDRAULIC OIL FILTER				C	See NOTE 5	See Parts Manual
22	TRANSMISSION OIL FILTER				C	See NOTE 5	See Parts Manual
23	WHEEL BEARINGS				L	0.5 kg (1lb)	Multi-Purpose Grease See NOTE 4
X= Check C=Change L=Lubricate NOTE 4: Multi-Purpose Grease with 2 to 4% Molybdenum Disulfide. NOTE 5: Change filters on new lift trucks after first 100 hours.							

MAINTENANCE PROCEDURES

EVERY 8 HOURS OR DAILY

WARNING

Do not operate a lift truck that needs repairs. Report the need for repairs immediately. If repair is necessary, put a "DO NOT OPERATE" tag in the operator's area. Remove the key from the key switch.

HOW TO MAKE CHECKS WITH THE ENGINE STOPPED

Put the lift truck on a level surface. Lower the carriage and forks, stop the engine and apply the parking brake. Open the hood and check for leaks and conditions that are not normal. Clean any oil or fuel spills. Make sure that lint, dust, paper, and other materials are removed from the engine compartment.

Engine Oil (See FIGURE 4.)

After the engine has stopped, wait one minute before checking the oil level. Keep the oil at the correct level as

indicated on the dipstick. Use the correct oil as shown in the MAINTENANCE SCHEDULE.

Drive Belts

Check the drive belts for wear and damage.

Cooling System (See FIGURE 3.)

WARNING

DO NOT remove the radiator cap from the radiator when the engine is hot. When the radiator cap is removed, the pressure is released from the system. If the system is hot, the steam and boiling coolant can cause burns. **DO NOT** remove the cover for the radiator when the engine is running.

Make sure the coolant level is between the "FULL" and the "ADD" mark on the auxiliary coolant reservoir. The coolant will expand as it is heated and the level in the auxiliary coolant reservoir will increase. If coolant is

added, use the correct mixture of water and ethylene glycol shown in the MAINTENANCE SCHEDULE.

Check the radiator fins. Clean the radiator with compressed air or water as needed.

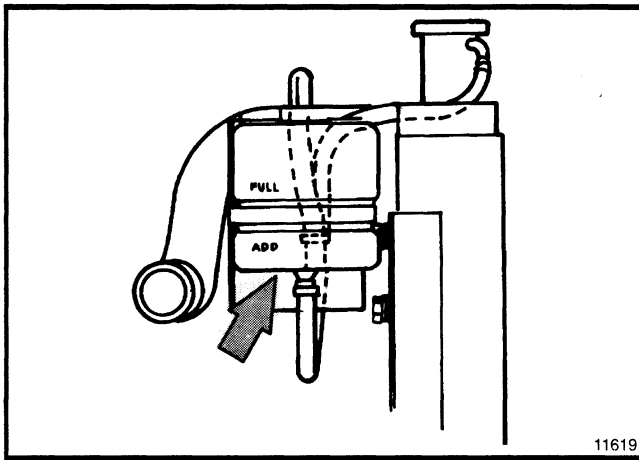

FIGURE 3. AUXILIARY COOLANT RESERVOIR

Battery (See FIGURE 4.)

⚠ WARNING

The acid in the electrolyte can cause injury. If the electrolyte is spilled, use water to flush the area. Use a solution of sodium bicarbonate (soda) to make the

acid neutral. Acid in the eyes must be flushed with water immediately. Wear eye protection.

Batteries generate explosive fumes. Keep the vents in the caps clean. Keep sparks or open flame away from the battery area. Do not make sparks from the battery connections. Disconnect the battery ground cable when doing maintenance.

Keep the battery and cable terminals clean. Check the electrolyte level (unless maintenance-free battery). Keep the electrolyte level above the separators and plates. Use distilled water. Do not fill the battery more than to the bottom of the internal filler neck.

If the battery becomes discharged and requires a booster battery to start the engine, follow these procedures carefully when connecting the jumper cables:

- Always connect the positive jumper cable to the positive terminal of the discharged battery and the negative jumper cable to the negative terminal.
- Always connect the jumper cable that is the ground cable last.
- Always connect the jumper cables to the discharged battery before connecting them to the booster battery.

GASOLINE AND LPG, MAZDA

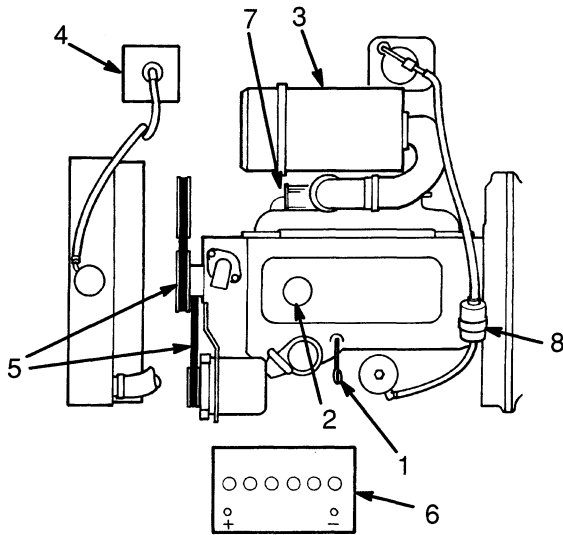

- 1. DIPSTICK FOR ENGINE OIL
- 2. FILL CAP, ENGINE OIL
- 3. AIR FILTER

- 4. AUXILIARY COOLANT RESERVOIR
- 5. DRIVE BELTS
- 6. BATTERY

GASOLINE AND LPG, GM

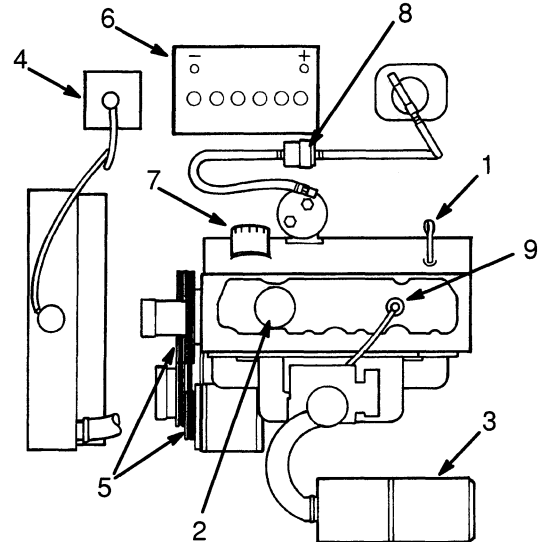

- 7. OIL FILTER
- 8. FUEL FILTER
- 9. PCV VALVE

DIESEL, ISUZU 4JB1

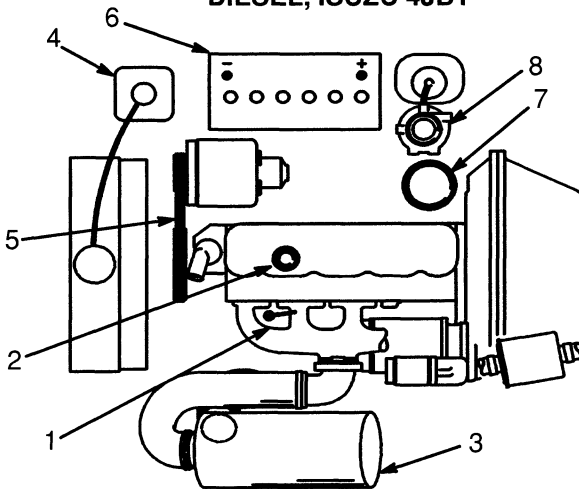

DIESEL, ISUZU C240

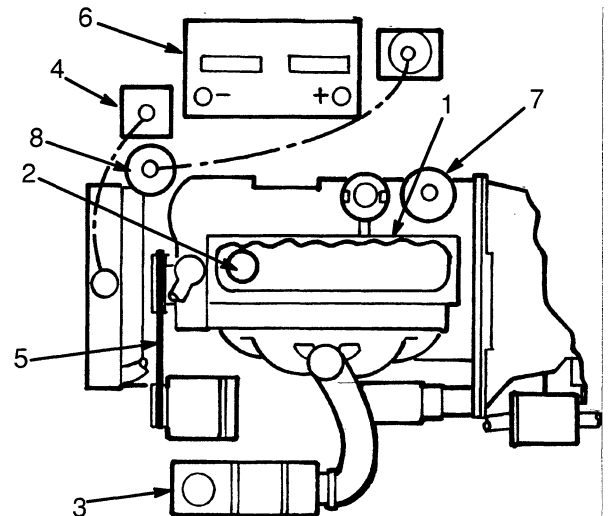

FIGURE 4. ENGINE MAINTENANCE POINTS

Fuel System

WARNING

All fuels are very flammable and can burn or cause an explosion. Do not use an open flame to check the fuel level or to check for leaks in the fuel system. If there is a leak in the fuel system, extra care must be used during the repair. Do not operate the lift truck until a leak is repaired.

Check the fuel system for leaks and the condition of parts. When fuel is added to the lift truck, see the section, **How To Add Fuel To The Lift Truck** procedures in the **OPERATING MANUAL**.

Air Filter (See FIGURE 5.)

Clean or replace the air filter as necessary. Use compressed air to clean the filter element. Air pressure must be less than 210 kPa (30 psi). Apply the air from the inside to the outside of the filter element.

Inspect the filter element. Put a bright light inside the filter element and look for holes or other damage. If the filter element is damaged, replace it with a new filter element. Use a cloth with solvent to clean the inside of the canister when the filter element is replaced.

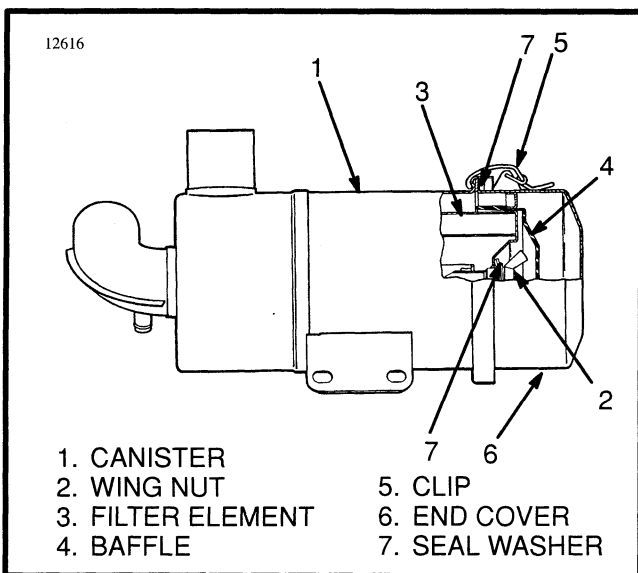

FIGURE 5. AIR FILTER

Hydraulic System Oil (See FIGURE 6.)

WARNING

At operating temperature the hydraulic oil is **HOT**. Do not permit the hot oil to touch the skin and cause a burn.

CAUTION

Do not permit dirt to enter the hydraulic system when the oil level is checked or the filter is changed.

Never operate the hydraulic pump without oil in the hydraulic system. The operation of the hydraulic pump without oil will damage the pump.

Check the hydraulic oil level when the oil is at operating temperature, the carriage is lowered and the engine is stopped. Add hydraulic oil only as needed. If more hydraulic oil is added than the "FULL" level, the hydraulic oil will leak from the breather during operation. The oil level indicated by the dipstick is most accurate when the oil temperature is 53 to 93°C (130 to 200°F).

Check the hydraulic system for leaks and damaged or loose components.

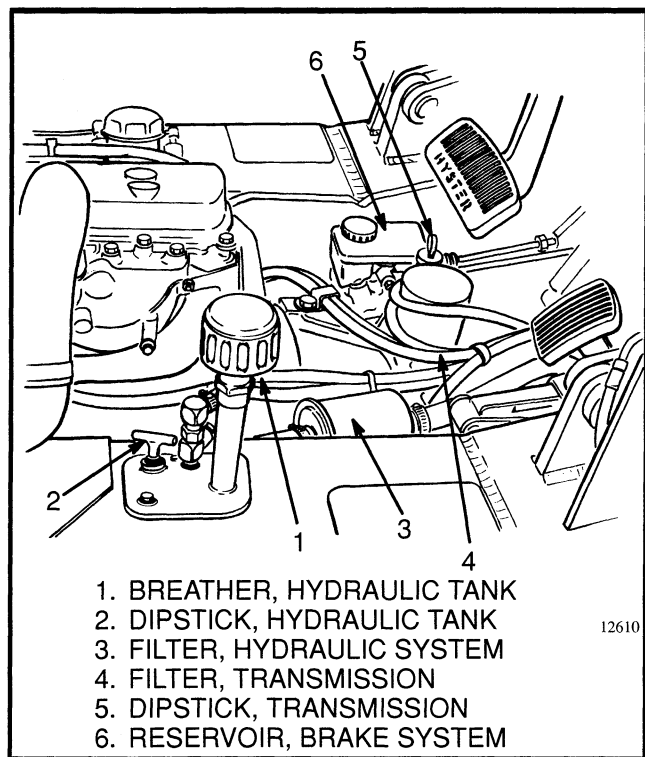

FIGURE 6. FILTERS AND SYSTEM CHECK POINTS

Tires and Wheels (See FIGURE 7.)

⚠ WARNING

Air pressure in pneumatic tires can cause tire and wheel parts to explode. The explosion of wheel parts can cause serious injury or death.

Remove all of the air from the tires before the tires are removed from the lift truck.

If the air pressure is less than 80% of the correct air pressure, the tire must be removed before air is added. Put the tire in a safety cage when adding air pressure to the tire. Follow the procedures described in "Add Air To The Tires".

When air is added to the tires, use a remote air chuck. The person adding air must stand away and to the side and not in front of the tire.

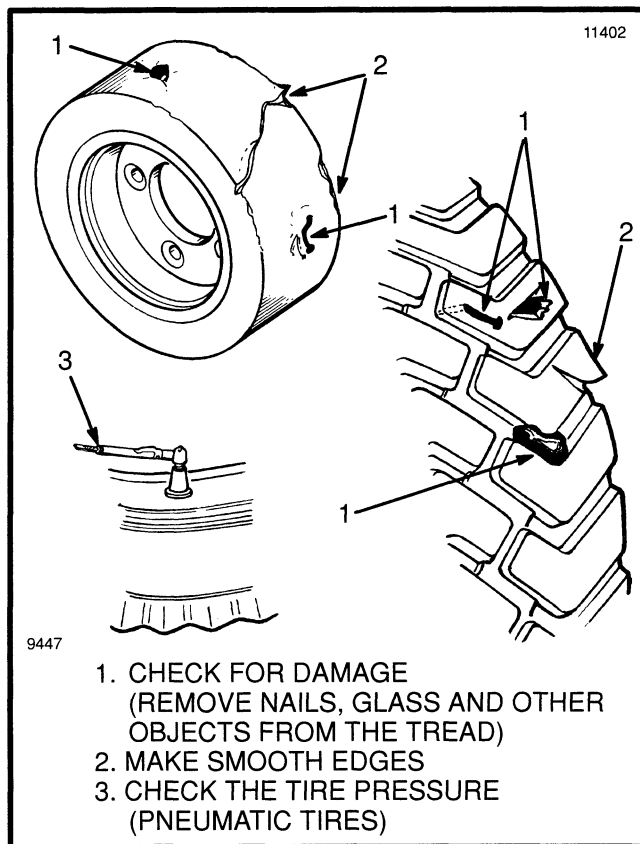

FIGURE 7. CHECK THE TIRES

If the lift truck has pneumatic tires, keep the tires at the correct air pressure. (See the Nameplate.) Check the air pressure with a gauge when the tires are cold. If it is necessary to add air to a tire that is warm, check one of the other tires on the same axle and add air to the tire that has low pressure so that the air pressures are equal. The air pressure of the warm tires must always be equal to or greater than the specification for air pressure for cold tires.

Check the tires for damage. Inspect the tread and remove any objects that will cause damage. Check for bent or damaged rims. Check for loose or missing parts. Remove any wire, straps or other material wrapped around the axle.

Make sure the drive wheel nuts are tight. Tighten the wheel nuts in a cross pattern to the correct torque value shown in the MAINTENANCE SCHEDULE.

⚠ CAUTION

When the drive wheels have been installed check all wheel nuts after 2 to 5 hours of operation. Tighten the nuts in a cross pattern to the correct torque value shown in the MAINTENANCE SCHEDULE. When the nuts stay tight for eight hours, the interval for checking the torque can be extended to 250 hours.

Forks

The identification of a fork describes how the fork is connected to the carriage. The S/H2.00-3.00XL (S/H40-60XL) series of lift trucks normally have a hook fork. See FIGURE 8.

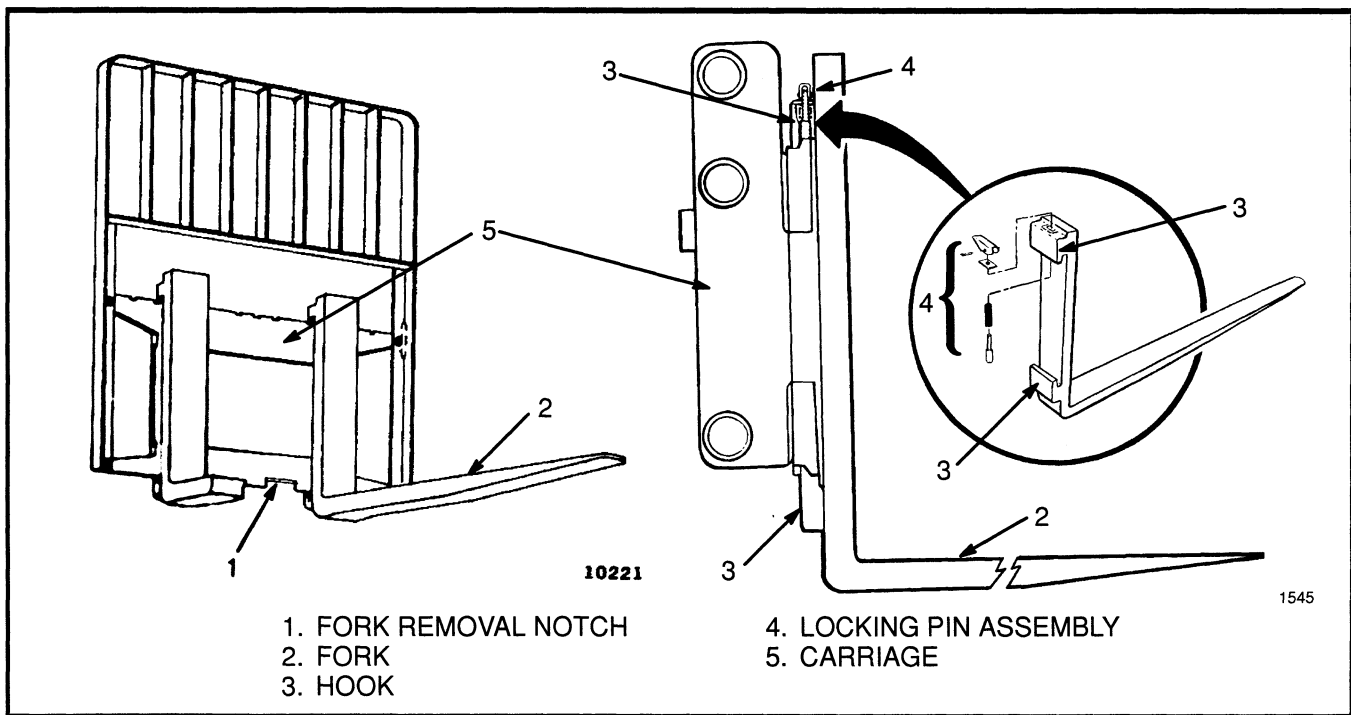

FIGURE 8. HOOK FORK

Forks, Adjustment

Hook forks are connected to the carriage by hooks and lock pins. See FIGURE 8. These lock pins are installed through the top fork hooks and fit into slots in the top carriage bar. Adjust the forks as far apart as possible for maximum support of the load. Hook forks will slide along the carriage bars to adjust for the load to be lifted. Raise the lock pin in each fork to slide the fork on the carriage bar. Make sure the lock pin is engaged in the carriage bar to lock the fork in position after the width adjustment is made.

Forks, Removal And Installation

A fork can be removed from the carriage for replacement of the fork or other maintenance.

⚠ WARNING

Do not try to move a fork without a lifting device. Each hook fork for these lift trucks can weigh 45 kg to 115 kg (100 to 250 lb).

Hook Fork (Removal). Slide a hook fork to the fork removal notch on the carriage. See FIGURE 8. Lower the fork onto blocks so that the bottom hook of the fork moves through the fork removal notch. See FIGURE 9.

Lower the carriage further so that the top hook of the fork is disengaged from the top carriage bar. Move the carriage away from the fork, or use a lifting device to move the fork away from the carriage.

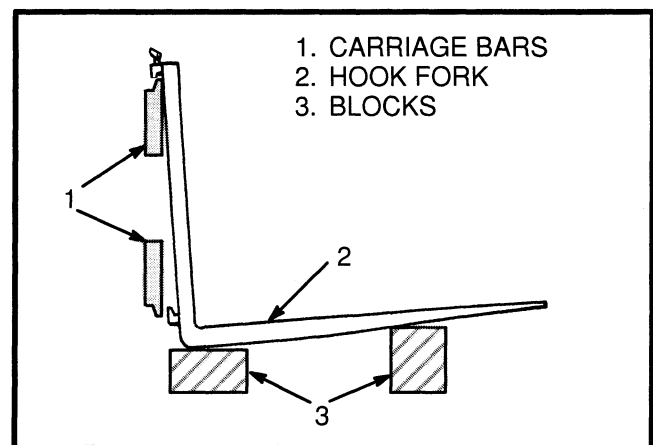

FIGURE 9. REMOVE A HOOK FORK

Hook Fork (Installation). Move the fork and carriage so that the top hook on the fork can engage the upper carriage bar. Raise the carriage to move the lower hook through the fork removal notch. Slide the fork on the carriage so that both upper and lower hooks engage the carriage. Engage the lock pin with a notch in the upper carriage bar.

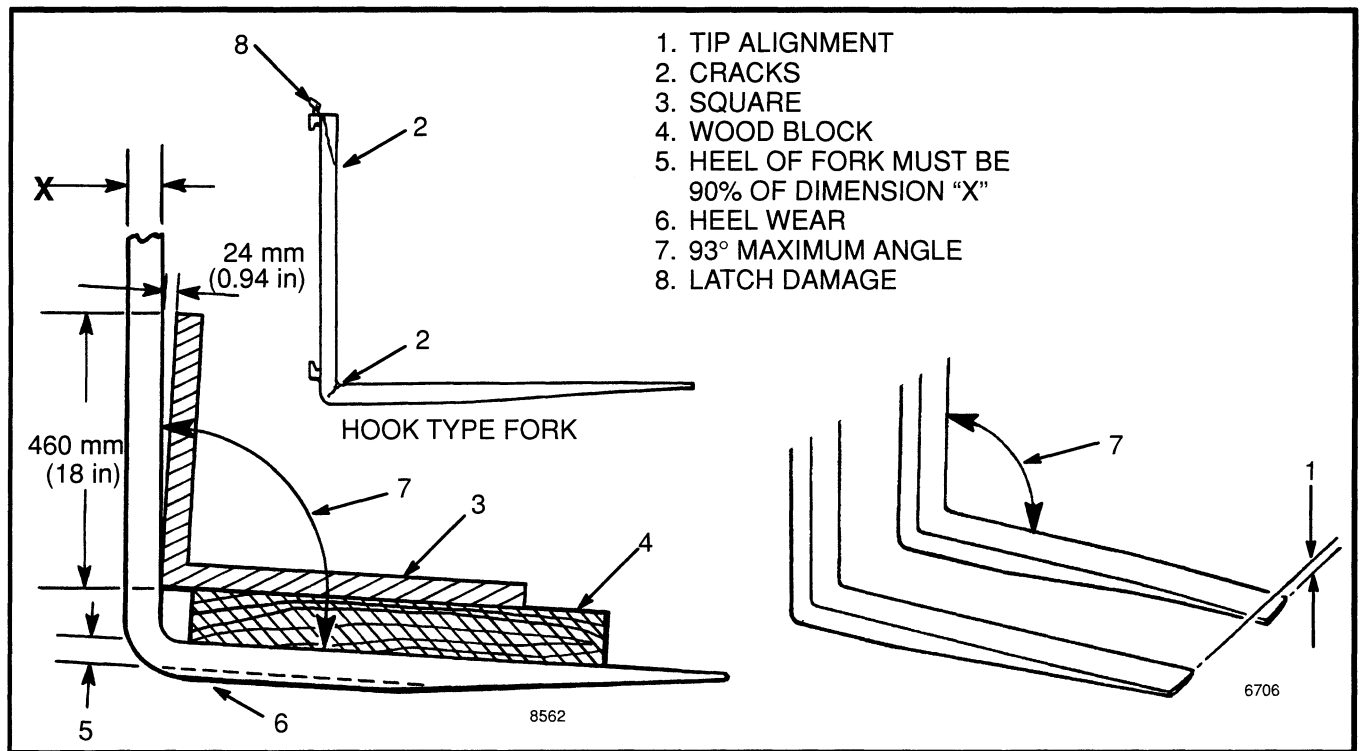

FIGURE 10. CHECK THE FORKS

Inspection Of Forks, Mast, and Lift Chains (See FIGURE 10. and FIGURE 11.)

⚠ WARNING

When working on or near the mast, see **SAFETY PROCEDURES WHEN WORKING NEAR THE MAST** in **GENERAL PROCEDURES** at the end of this section.

Lower the lift mechanism completely. Never allow any person under a raised carriage. Do not put any part of your body in or through the lift mechanism unless all parts of the mast are completely lowered and the engine is STOPPED.

Do not try to correct the alignment of the fork tips by bending the forks or adding shims. Replace damaged forks.

Never repair damaged forks by heating or welding. Forks are made of special steel using special procedures. Replace damaged forks.

1. Inspect the welds on the mast and carriage for cracks. Make sure that the capscrews and nuts are tight.

2. Inspect the channels for wear in the areas where the rollers travel. Inspect the rollers for wear or damage.

3. Inspect the load backrest extension for cracks and damage.

4. Inspect the forks for cracks and wear. Check that the fork tips are aligned within 13 mm (0.5 in) of each other. (See FIGURE 10.) Check that the bottom of the fork is not worn (Item 5).

5. Replace any damaged or broken parts that are used to keep the forks locked in position.

6. If the lift truck is equipped with a side-shift carriage or attachment, inspect the parts for cracks and wear. Make sure the parts that fasten the side-shift carriage or attachment to the carriage are in good condition.

7. Check that the lift chains are correctly lubricated. Use SAE 30 engine oil to lubricate the lift chains.

8. Inspect the lift chains for cracks or broken links and pins. (See FIGURE 11.)

9. Inspect the chain anchors and pins for cracks and damage.

10. Make sure the lift chains are adjusted so that they have equal tension. **Adjustment or replacement of the lift chains must be done by authorized personnel.** See Lift Chain Adjustments described in the **GENERAL PROCEDURES** later in this section.

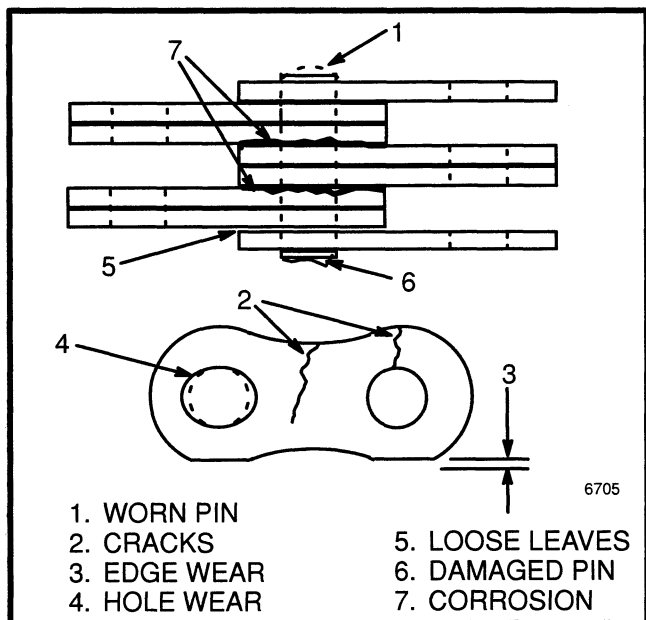

FIGURE 11. CHECK THE LIFT CHAINS

Safety Labels

WARNING

Safety labels are installed on the lift truck to give information about operation and possible hazards. It

is important that all safety labels are installed on the lift truck and can be read.

Check that all safety labels are installed in the correct location on the lift truck. See the **PARTS MANUAL** or the **FRAME** section of the **SERVICE MANUAL** for the correct location of the safety labels. See the **FRAME** section for the installation procedure.

Operator Restraint System (See FIGURE 12. and FIGURE 13.)

The seat belt, hip restraint brackets, seat and mount, hood, latches and floor plates are all part of the operator restraint system. Each item must be checked to make sure it is fastened correctly, functions correctly and is in good condition.

See FIGURE 12. Make sure the seat rails and latch striker are not loose. The seat rails must lock tightly in position, but move freely when unlocked. The seat rails must be correctly fastened to the mount surface. If the mount surface is the hood, the hood must be fastened to the floor plate with the latch. The floor plate must be fastened to the lift truck frame. Try to lift the hood to make sure it is fastened correctly and will not move.

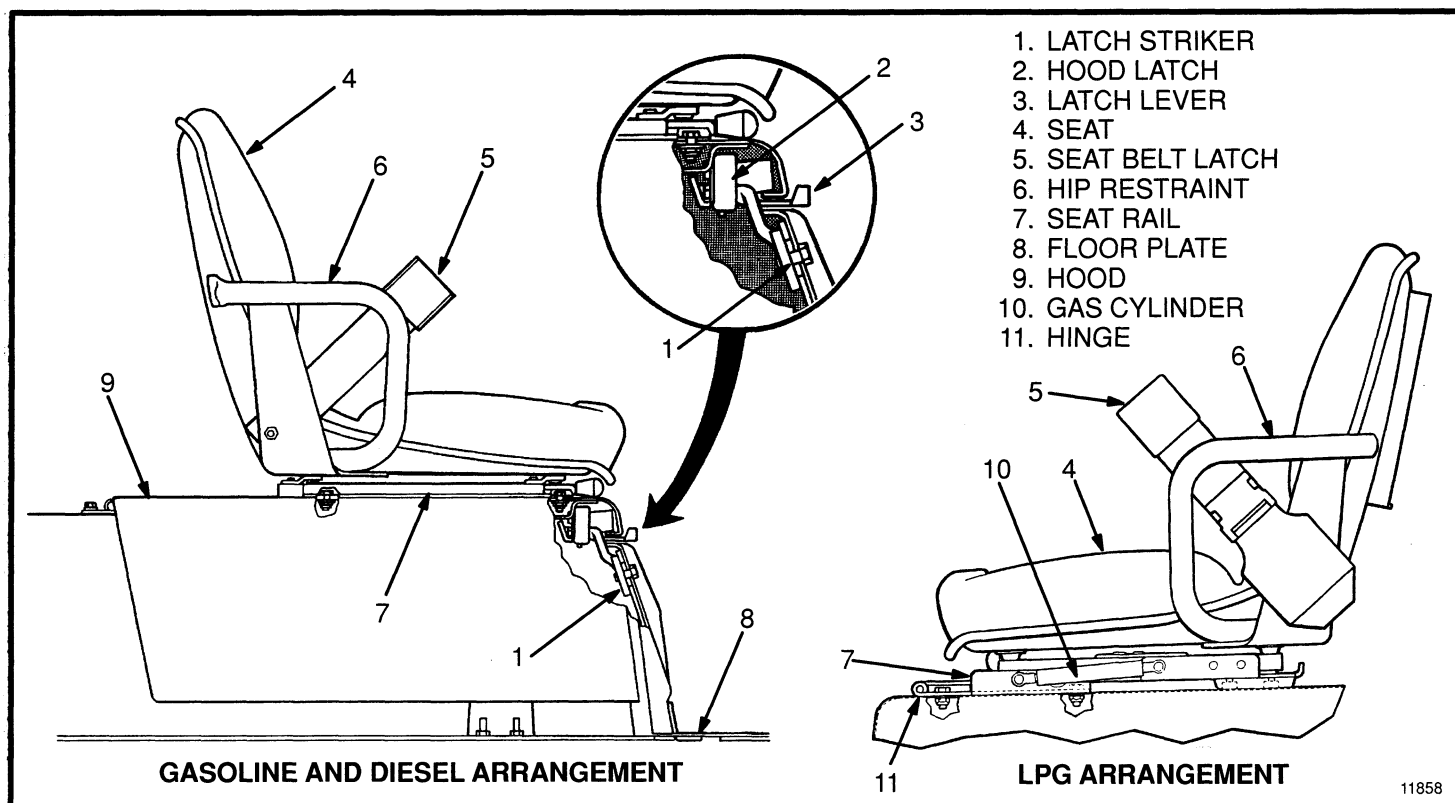

FIGURE 12. CHECK THE HOOD AND SEAT LATCHES

The end of the seat belt must fasten correctly in the latch. Make sure the seat belt pulls from the retractor assembly and retracts smoothly. The seat belt must be in good condition. A seat belt that is damaged or worn will not give protection when it is needed. If the seat belt can not be pulled from the retractor assembly, remove the screw that keeps the cover on the retractor. Push the bar to release the spool. Straighten the belt so that it will pull and retract smoothly from the retractor assembly. (See FIGURE 13.)

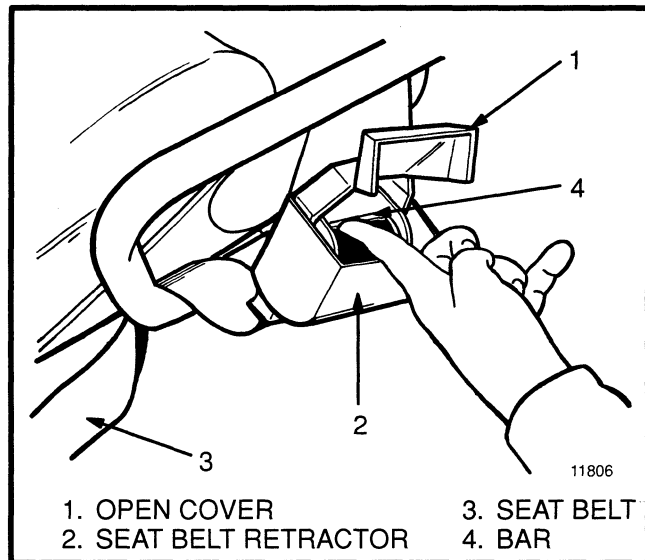

FIGURE 13. RELEASE A JAMMED SEAT BELT

HOW TO MAKE CHECKS WITH THE ENGINE RUNNING

⚠ WARNING

FASTEN YOUR SEAT BELT! The seat belt is installed to help the operator stay on the truck if the lift truck tips over. **IT CAN ONLY HELP IF IT IS FASTENED.**

Make sure that the area around the lift truck is clear before starting the engine or making any checks of the operation. Be careful when making the checks. If the lift truck is stationary during a check, apply the parking brake and put the transmission in **NEUTRAL**. Make the checks carefully.

Gauges, Lights, Horn, and Fuses

Start the engine. Check the gauges and lights for correct operation as described in the **OPERATING MAN-**

UAL. Check the operation of the horn. If any of the lights or gauges do not operate correctly, check the fuses. The fuses are under the instrument panel on the left side of the cowl. See FIGURE 14. and FIGURE 15.

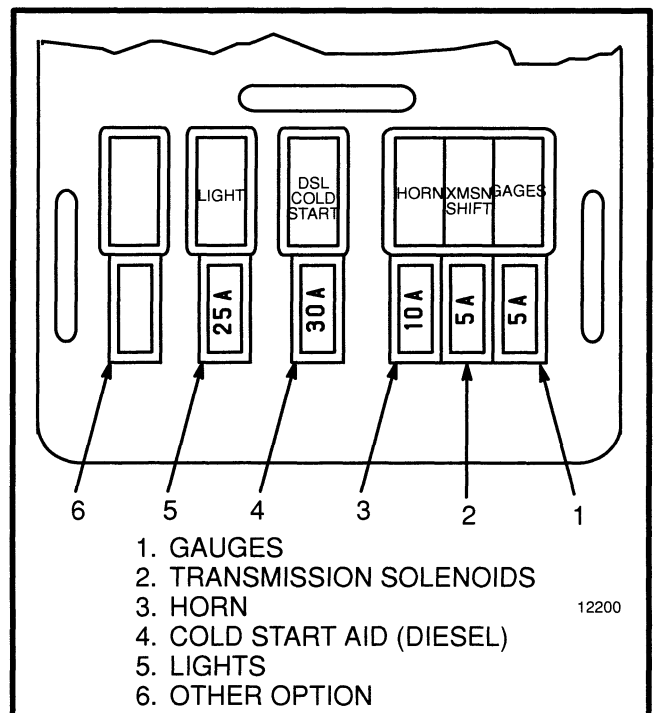

FIGURE 14. FUSES, LATER PRODUCTION

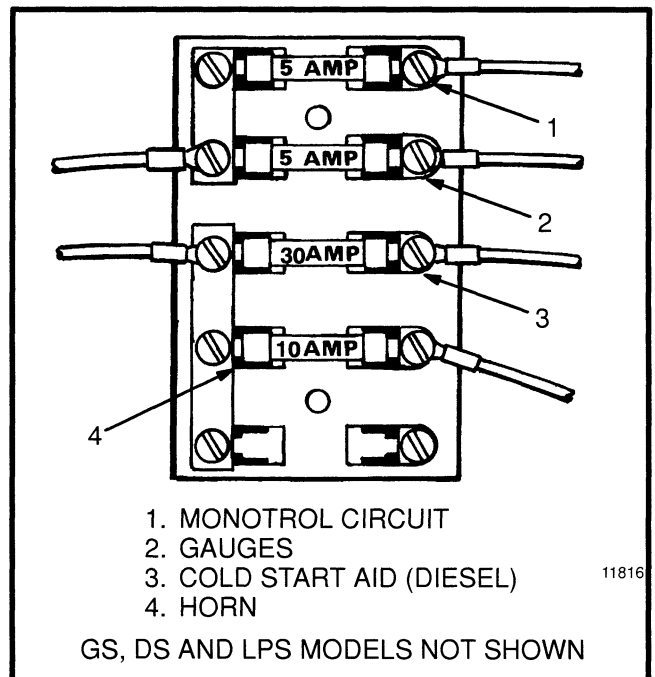

FIGURE 15. FUSES, EARLIER PRODUCTION