



# Bobcat®

## Service Manual

---



---

### Wheel Saw WSSL20

S/N B4KK00101 & Above





# MAINTENANCE SAFETY



## WARNING

Instructions are necessary before operating or servicing machine. Read and understand the Operation & Maintenance Manual, Operator's Handbook and signs (decals) on machine. Follow warnings and instructions in the manuals when making repairs, adjustments or servicing. Check for correct function after adjustments, repairs or service. Untrained operators and failure to follow instructions can cause injury or death.

W-2003-0807







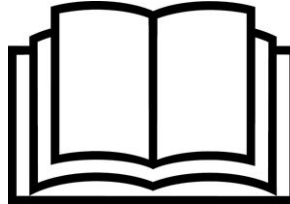



**Safety Alert Symbol:** This symbol with a warning statement, means: "Warning, be alert! Your safety is involved!" Carefully read the message that follows.

**CORRECT**



P-90216

-  Never service attachments / implements without instructions. See Operation & Maintenance Manual and Attachment / Implement Service Manual.
-  Cleaning and maintenance are required daily.
-  Never service or adjust attachment / implement with the engine running unless instructed to do so in manual.
-  Always lower the attachment / implement to the ground before lubricating or servicing.
-  Avoid contact with leaking hydraulic fluid or diesel fuel under pressure. It can penetrate skin or eyes.
-  Stop, cool and clean engine of flammable materials before checking fluids.
-  Keep body, loose objects and clothing away from moving parts, electrical contacts, hot parts and exhaust.
-  Safety glasses are needed for eye protection from electrical arcs, battery acid, compressed springs, fluids under pressure and flying debris or when tools are used. Use eye protection approved for type of welding.



## CONTENTS

SAFETY AND MAINTENANCE .....	10-01
HYDRAULIC SYSTEM .....	20-01
MAINFRAME .....	30-01
SPECIFICATIONS .....	SPEC-01
ALPHABETICAL INDEX .....	INDEX-01

**Thanks very much for your reading,  
Want to get more information,  
Please click here, Then get the complete  
manual**

**JustClickHere** 

**NOTE:**

**If there is no response to click on the link above,  
please download the PDF document first, and then  
click on it.**

**Have any questions please write to me:  
[admin@servicemanualperfect.com](mailto:admin@servicemanualperfect.com)**



**Bobcat®**

**FOREWORD**

SERIAL NUMBER LOCATION ..... 1-7

    Attachment Serial Number ..... 1-7

DELIVERY REPORT ..... 1-7

ATTACHMENT IDENTIFICATION ..... 1-8

FEATURES AND ACCESSORIES ..... 1-9

    Standard Items ..... 1-9

    Options And Accessories ..... 1-9





**Bobcat®**

SERIAL NUMBER LOCATION

Attachment Serial Number

Figure 1

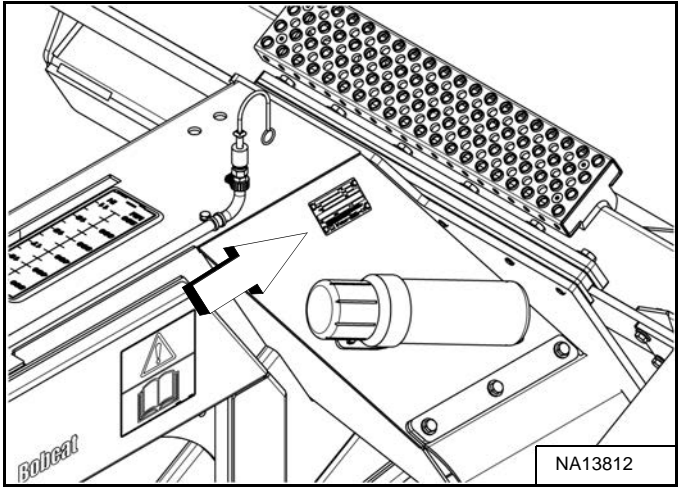

Always use the serial number **[Figure 1]** of the wheel saw when requesting service information or when ordering parts. Early or later models (identification made by serial number) may use different parts, or it may be necessary to use a different procedure in doing a specific service operation.

DELIVERY REPORT

Figure 2

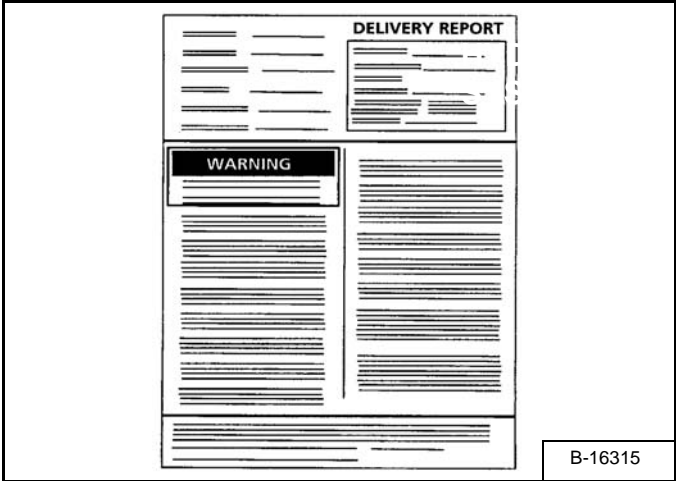

The delivery report **[Figure 2]** contains a list of items that must be explained or shown to the owner or operator by the dealer when the Bobcat attachment is delivered.

The delivery report must be reviewed and signed by the owner or operator and the dealer.

ATTACHMENT IDENTIFICATION

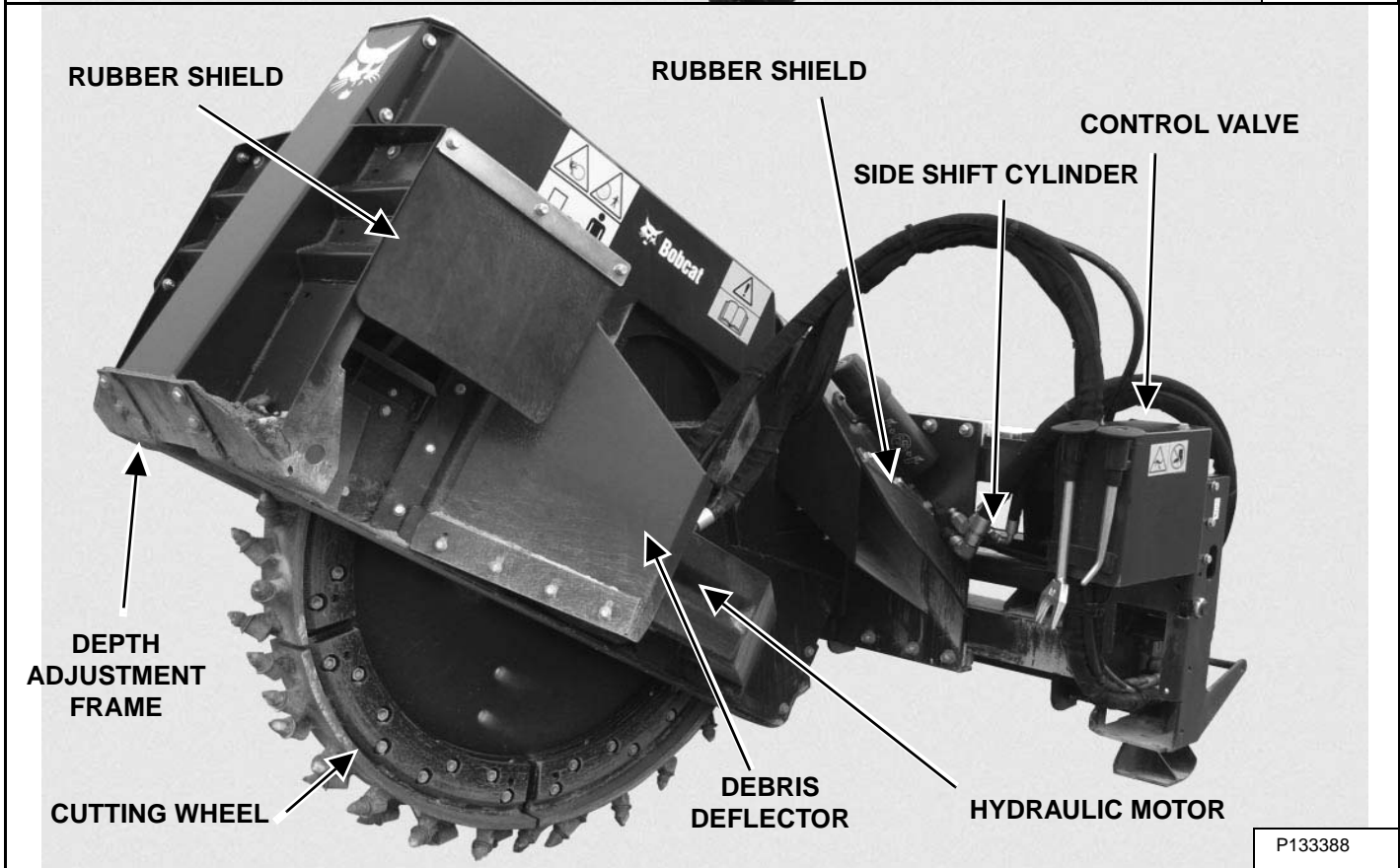
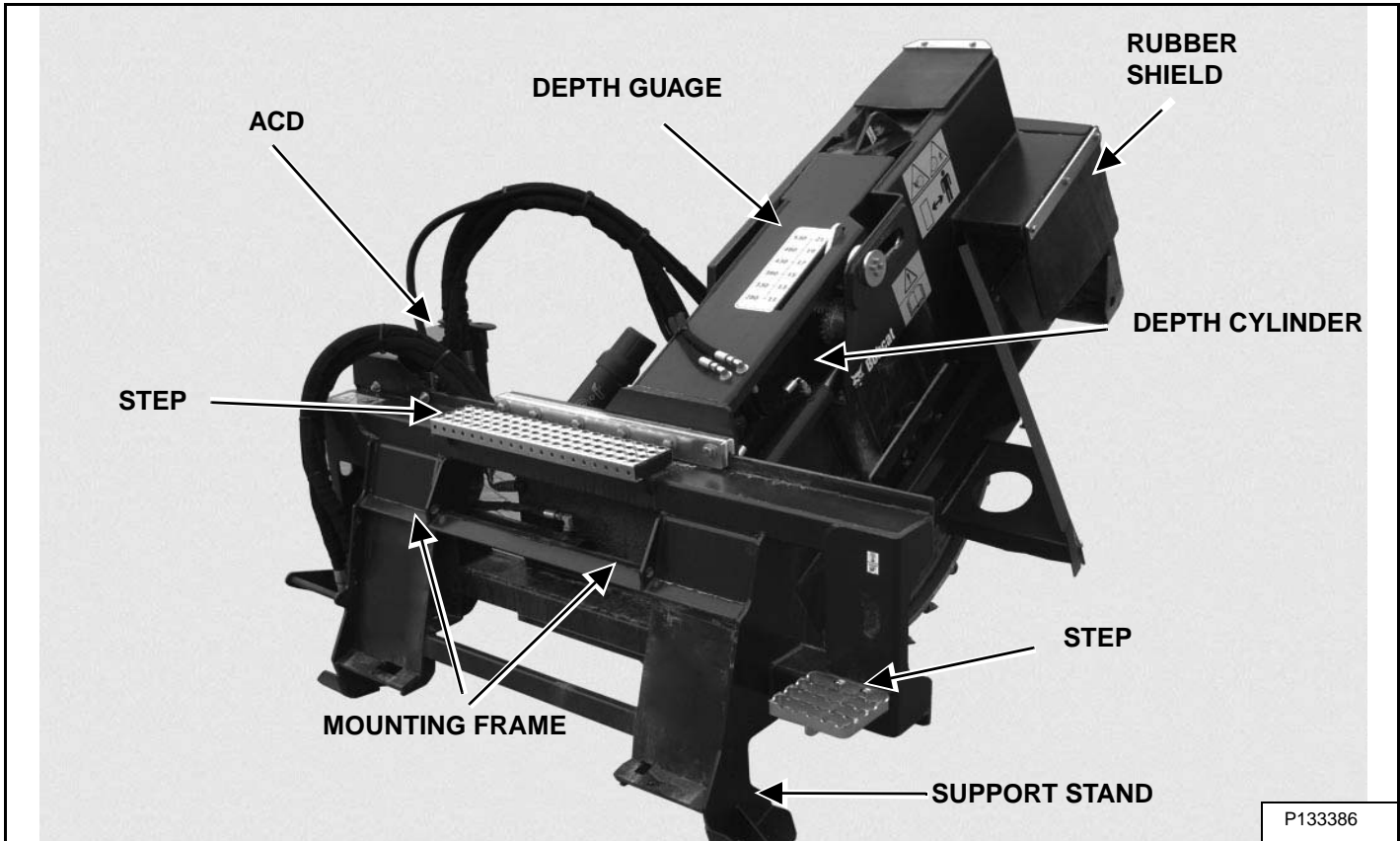

## FEATURES AND ACCESSORIES

### Standard Items

The wheel saw is equipped with the following Standard items:

- Self Leveling Mounting Frame.
- Depth Adjustment Frame.
- Bit Removal And Installation Tool.
- Side-Shifting Attachment Frame.
- Wheel With Quick Interchangeable Cutting Segments.
- Rubber Shield Kit.

### Options And Accessories

- 14 Pin ACD Kit.
- 50 mm (2.0 in) Wheel.
- 80 mm (3.15 in) Wheel.
- 100 mm (3.94 in) Wheel.
- 120 mm (4.72 in) Wheel.
- Spray Nozzle Kit.
- Right Side Outlet Cover Kit.



**Bobcat®**

## **SAFETY AND MAINTENANCE**

TROUBLESHOOTING .....	10-10-1
Chart .....	10-10-1
SERVICE SCHEDULE .....	10-20-1
Chart .....	10-20-1
DAILY INSPECTION .....	10-30-1
Attachment Mounting Frame .....	10-30-1
Hydraulic Motor Safety Cover .....	10-30-1
Bob-Tach .....	10-30-2
Tool Bit Inspection .....	10-30-4
Wear Plates Inspection .....	10-30-5
Spoil Deflectors .....	10-30-6
REGULAR MAINTENANCE .....	10-40-1
Tool Bit Replacement .....	10-40-1
Wear Plate Replacement .....	10-40-2
Spoil Deflector Replacement .....	10-40-3
Hydraulic Motor Safety Cover Replacement .....	10-40-5
LUBRICATING THE WHEEL SAW .....	10-50-1
Lubrication Locations .....	10-50-1
ATTACHMENT STORAGE AND RETURN TO SERVICE .....	10-60-1
Storage .....	10-60-1
Return To Service .....	10-60-1



**Bobcat®**

## TROUBLESHOOTING

### Chart



## WARNING

Instructions are necessary before operating or servicing machine. Read and understand the Operation & Maintenance Manual, Operator's Handbook and signs (decals) on machine. Follow warnings and instructions in the manuals when making repairs, adjustments or servicing. Check for correct function after adjustments, repairs or service. Untrained operators and failure to follow instructions can cause injury or death.

W-2003-0807

If the attachment is not working correctly, check the hydraulic system of the machine thoroughly before making any repairs on the attachment. Attachment problems can be affected by a hydraulic system that is not operating to specifications. Connect a flow meter to the machine to check the hydraulic pump output, relief valve setting and tube lines to check flow and pressure. (See the machine's Service Manual for the correct procedure to connect the flow meter.)

Use the following troubleshooting chart to locate and correct problems which most often occur with the attachment.

PROBLEM	CAUSE	CORRECTION
Wheel Saw will not rotate.	Auxiliary hydraulics not activated.	Activate auxiliary hydraulics.
	Hydraulic couplers not fully connected.	Check hydraulic connections.
	Wheel saw bits are contacting the ground when start-up is attempted.	Raise the wheel saw off the ground before engaging auxiliary hydraulics.
	Electrical solenoids on wheel saw disconnected or defective.	Check all electrical connections. Repair and / or replace solenoids.
	Control valve on wheel saw damaged or defective.	Repair and / or replace control valve.
Wheel Saw loses power.	Travel speed too fast.	Move loader forward at a slower rate.
	Loss of hydraulic flow.	Make sure High Flow hydraulics are activated.
	Loader relief valve not set to specification.	Check loader relief valve setting.
	Hydraulic pump flow insufficient.	Check hydraulic pump flow.
Wheel Saw will not side shift.	Debris obstructing side shift function.	Check area around side shift cylinder for any obstructions.
	Electrical solenoids on wheel saw disconnected or defective.	Check all electrical connections. Repair and / or replace solenoids.
	Control valve on wheel saw damaged or defective.	Repair and / or replace control valve.
Wheel Saw depth frame will not lower or raise.	Debris obstructing depth frame movement.	Clean all areas around depth frame.
	Electrical solenoids on wheel saw disconnected or defective.	Check all electrical connections. Repair and / or replace solenoids.
Cutting bits wear unevenly.	Bits are not rotating in their housings.	See bit replacement page 10-10- 4.
Wheel Saw vibrates.	Wheel saw frame not positioned firmly on work surface.	The wheel saw frame should be fully lowered on the work surface.
	Not enough loader weight on the wheel saw.	Raise loader front wheels slightly off of the ground to add additional weight.
Trench has excessive debris after cutting operation.	Wrong width format installation.	Check if discharge plates are bolted into the correct position.
		Check if front spacers are correct for width.





**Bobcat®**

## SERVICE SCHEDULE

### Chart



## WARNING

Instructions are necessary before operating or servicing machine. Read and understand the Operation & Maintenance Manual, Operator's Handbook and signs (decals) on machine. Follow warnings and instructions in the manuals when making repairs, adjustments or servicing. Check for correct function after adjustments, repairs or service. Untrained operators and failure to follow instructions can cause injury or death.

W-2003-0807

Maintenance work must be done at regular intervals. Failure to do so will result in excessive wear and early failures. The service schedule is a guide for correct maintenance of the Bobcat product.

SERVICE SCHEDULE	HOURS			
SERVICE REQUIRED	1	50	100	200
Inspect the wheel saw wheel and wheel saw teeth.				
Check the hydraulic hoses and hydraulic fittings for damage.				
Drain line safety cover inspection.				
Lubricate wheel.				
Lubricate the depth cylinder gear.				
The structural integrity of the wheel saw.				
Check all nuts and bolts for being tight or missing.				
Check the support skids for damage or excessive wear.				



## DAILY INSPECTION

### Attachment Mounting Frame

Figure 10-30-1

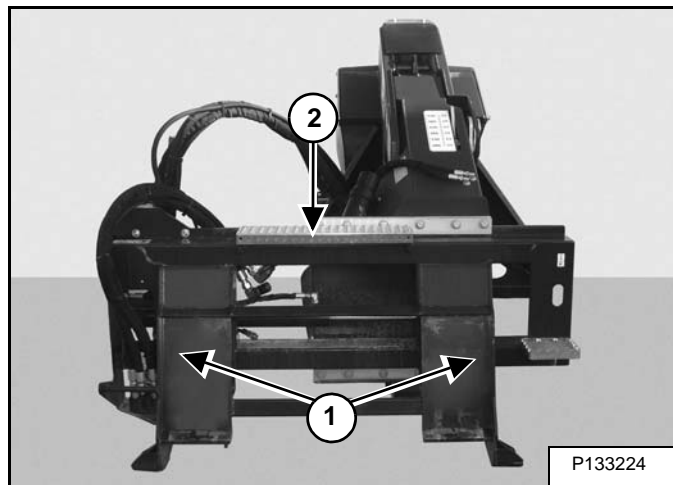

Inspect the Bob-Tach wedge mount (Item 1), mounting flange (Item 2) **[Figure 10-30-1]** and all welds on the wheel saw mount for wear and damage each time the wheel saw is removed from the loader.

### Hydraulic Motor Safety Cover

Figure 10-30-2

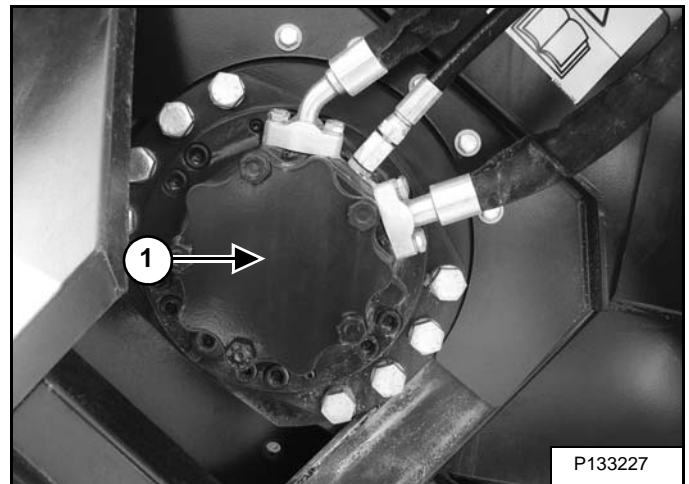

To prevent damage to the hydraulic motor due to high counter pressure in the drain line, a safety cover (Item 1) **[Figure 10-30-2]** allows excess pressure to be relieved.

Inspect the safety cover (Item 1) **[Figure 10-30-2]** for any deformity. Replace as necessary.

Frequently inspect the wheel saw to ensure that all components are secure and that all bolts and nuts are thoroughly tightened.

## DAILY INSPECTION (CONT'D)

### Bob-Tach

#### Hand Lever Bob-Tach

## ! WARNING

### AVOID INJURY OR DEATH

The Bob-Tach wedges must extend through the holes in the attachment mounting frame. Levers must be fully down and locked. Failure to secure wedges can allow attachment to come off.

W-2715-0208

Figure 10-30-3

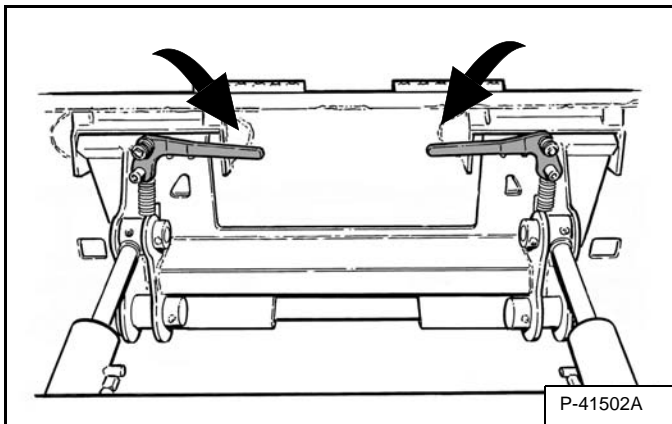

Push down on the Bob-Tach® levers until they are fully engaged in the locked position [Figure 10-30-3] (wedges fully extended through the attachment mounting frame holes).

The levers and wedges must move freely [Figure 10-30-3].

Figure 10-30-4

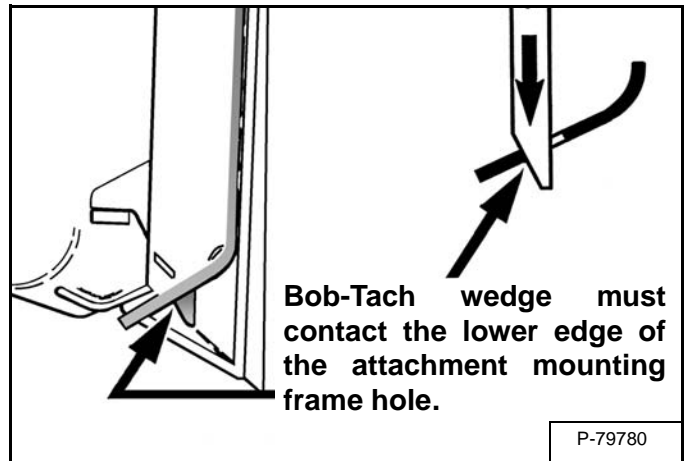

The wedges must extend through the holes in the attachment mounting frame, securely fastening the attachment to the Bob-Tach [Figure 10-30-4].

**NOTE:** If the wedge does not contact the lower edge of the hole, the attachment will be loose and can come off the Bob-Tach.

Figure 10-30-5

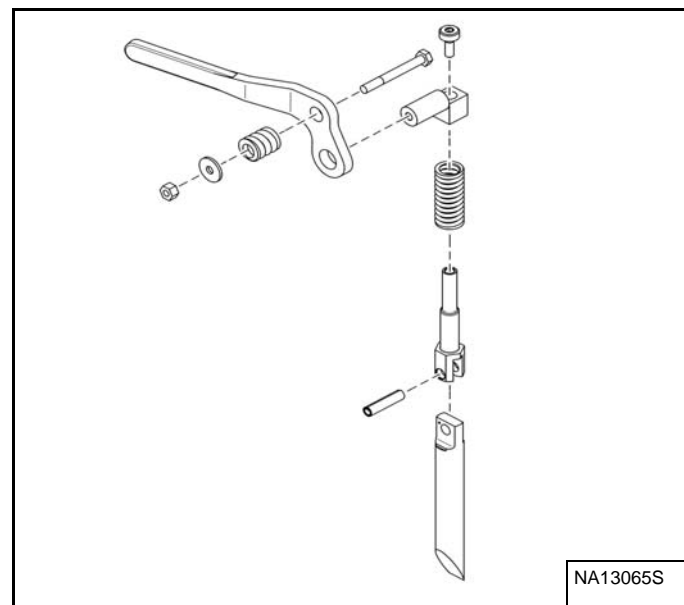

Inspect the mounting frame on the attachment. (See the machine's Operation & Maintenance Manual for inspecting the Bob-Tach). Replace any parts that are damaged, bent, or missing [Figure 10-30-5]. Keep all fasteners tight. Look for cracked welds.

Lubricate the wedges. (See the machine's Operation & Maintenance Manual for the correct procedure.)

## DAILY INSPECTION (CONT'D)

### Bob-Tach (Cont'd)

Power Bob-Tach

# ! WARNING

### AVOID INJURY OR DEATH

The Bob-Tach wedges must extend through the holes in the attachment mounting frame. Levers must be fully down and locked. Failure to secure wedges can allow attachment to come off.

W-2715-0208

Figure 10-30-6

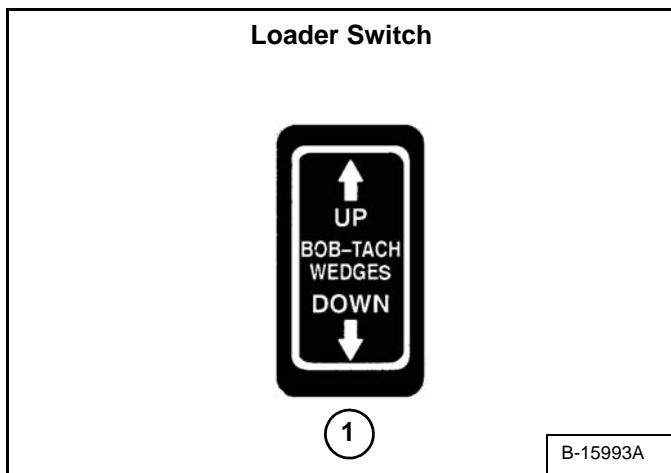
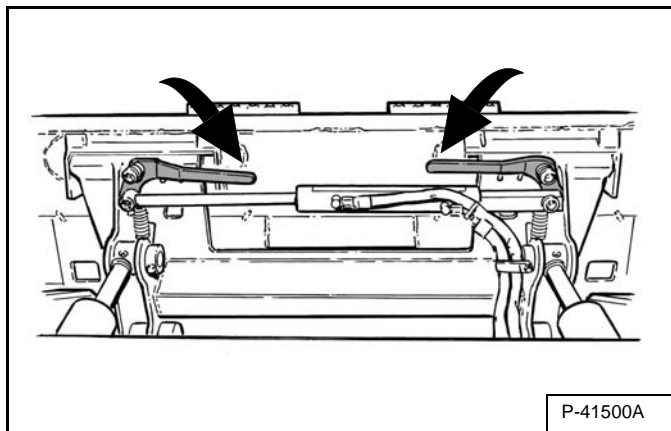
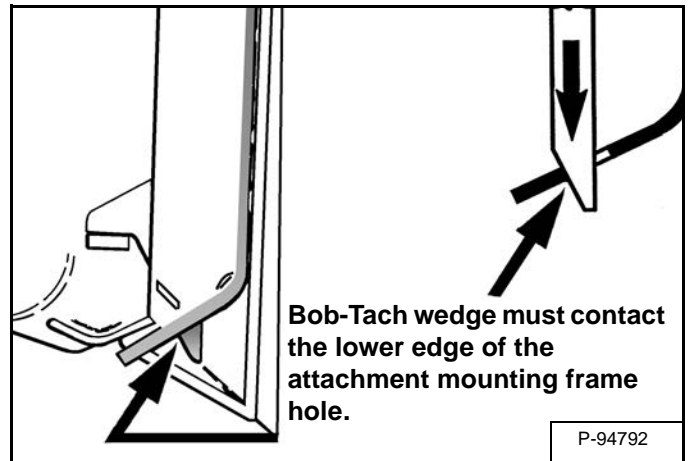

Figure 10-30-7



Push (Item 1) [Figure 10-30-6] and hold the BOB-TACH "WEDGES DOWN" switch until the levers are fully engaged in the locked position [Figure 10-30-7] (wedges fully extended through the attachment mounting frame holes).

Figure 10-30-8



The wedges must extend through the holes in the attachment mounting frame, securely fastening the attachment to the Bob-Tach [Figure 10-30-8].

**NOTE:** If the wedge does not contact the lower edge of the hole, the attachment will be loose and can come off the Bob-Tach.

Figure 10-30-9

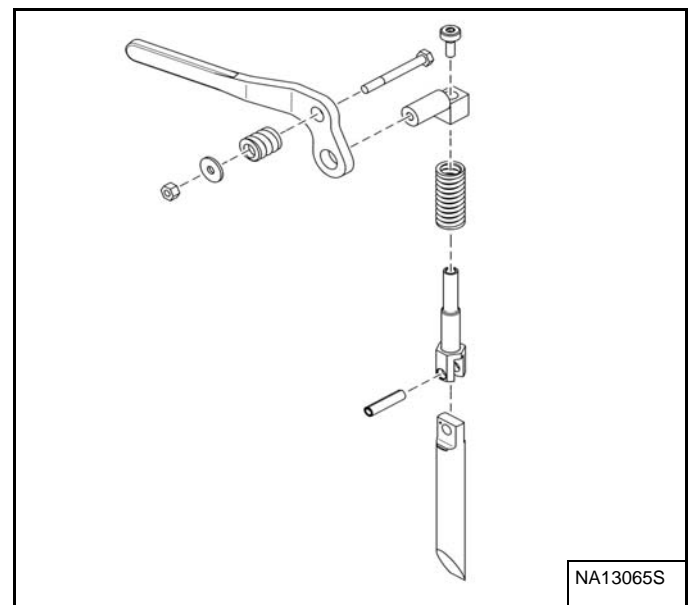

Inspect the mounting frame on the attachment. (See the machine's Operation & Maintenance Manual for inspecting the Bob-Tach). Replace any parts that are damaged, bent or missing [Figure 10-30-9]. Keep all fasteners tight. Look for cracked welds.

Lubricate the wedges. (See the machine's Operation & Maintenance Manual for the correct procedure.)

DAILY INSPECTION (CONT'D)

Tool Bit Inspection

Cutting Wheel

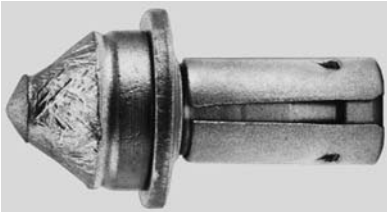
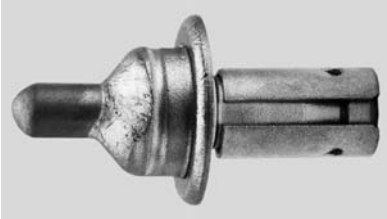
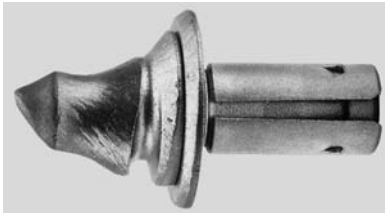
<p><b>A: Features of a correctly worn tooth:</b></p> <ul style="list-style-type: none"><li>• The remaining part of the carbide tip is symmetrically shaped.</li><li>• The body has a uniform, tapered shape,</li><li>• The body has enough bulk to support the carbide core.</li><li>• Tooth is worn and needs replacing.</li></ul>	
<p><b>B: Tooth that has worked on soft materials:</b></p> <ul style="list-style-type: none"><li>• If a tooth has been used on an overly soft material, the body will wear quicker than the tip, and the tip will end up snapping off. Additionally, the altered tooth shape will increase tooth holder wear.</li><li>• Tooth is worn and needs replacing.</li></ul>	
<p><b>C: Tooth which has not rotated properly</b></p> <ul style="list-style-type: none"><li>• The teeth which are subject to uneven use, wear out fast. Wear of this kind is usually due to the tooth not turning round in its holder. The wear maybe due to a worn tooth holder or the presence of small particles of cut material between the shank of the tooth and the seat in which it is fitted. In this instance, clean the seat and lubricate with diesel fuel.</li><li>• Tooth is worn and needs replacing.</li></ul>	
<p><b>NOTE: The tooth shown in the picture is a standard model, but the concept applies to all teeth models.</b></p>	