



---

# Service Manual

## Forestry Cutter

---

(FRST CTR FRC150ST) B4A900101 & Above  
(FRST CTR FRC150HT) B4A800101 & Above  
(FRST CTR FRC200HT) B48J00101 & Above

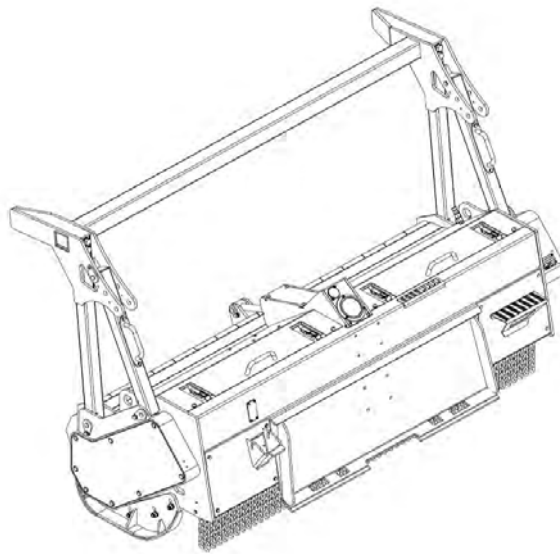

Loader Must Be Equipped With Approved Forestry Kit.





# MAINTENANCE SAFETY



## WARNING







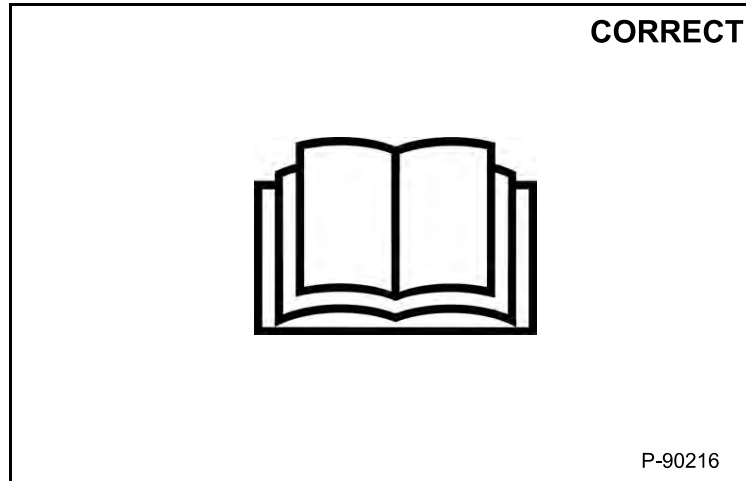

Instructions are necessary before operating or servicing machine. Read and understand the Operation & Maintenance Manual, Operator's Handbook and signs (decals) on machine. Follow warnings and instructions in the manuals when making repairs, adjustments or servicing. Check for correct function after adjustments, repairs or service. Untrained operators and failure to follow instructions can cause injury or death.

W-2003-0807



**Safety Alert Symbol:** This symbol with a warning statement, means: "Warning, be alert! Your safety is involved!" Carefully read the message that follows.



-  **Never service attachments / implements without instructions. See Operation & Maintenance Manual and Attachment / Implement Service Manual.**
-  **Cleaning and maintenance are required daily.**
-  **Never service or adjust attachment / implement with the engine running unless instructed to do so in manual.**
-  **Always lower the attachment / implement to the ground before lubricating or servicing.**
-  **Avoid contact with leaking hydraulic fluid or diesel fuel under pressure. It can penetrate skin or eyes.**
-  **Stop, cool and clean engine of flammable materials before checking fluids.**
-  **Keep body, loose objects and clothing away from moving parts, electrical contacts, hot parts and exhaust.**
-  **Safety glasses are needed for eye protection from electrical arcs, battery acid, compressed springs, fluids under pressure and flying debris or when tools are used. Use eye protection approved for type of welding.**

MSW30-0409

**Thanks very much for your reading,  
Want to get more information,  
Please click here, Then get the complete  
manual**

**JustClickHere** 

**NOTE:**

**If there is no response to click on the link above,  
please download the PDF document first, and then  
click on it.**

**Have any questions please write to me:  
[admin@servicemanualperfect.com](mailto:admin@servicemanualperfect.com)**



**Bobcat<sup>®</sup>**

## CONTENTS

SAFETY AND MAINTENANCE .....	10-01
HYDRAULIC SYSTEM .....	20-01
MAINFRAME .....	30-01
ELECTRICAL SYSTEM .....	40-01
SPECIFICATIONS .....	SPEC-01
ALPHABETICAL INDEX .....	INDEX-01



**Bobcat®**

## FOREWORD

SERIAL NUMBER LOCATION .....	1-7
Attachment Serial Number .....	1-7
MANUAL STORAGE .....	1-7
FORESTRY DOOR SERIAL NUMBER .....	1-8
DELIVERY REPORT .....	1-8
ATTACHMENT IDENTIFICATION .....	1-9
Forestry Cutter (FRC150ST S/N B4A900101 & Above, FRC150HT S/N B4A800101 & Above and FRC200HT S/N B48J00101 & Above) .....	1-9
Forestry Kit Equipment .....	1-10



**Bobcat<sup>®</sup>**

## SERIAL NUMBER LOCATION

### Attachment Serial Number

Figure 1

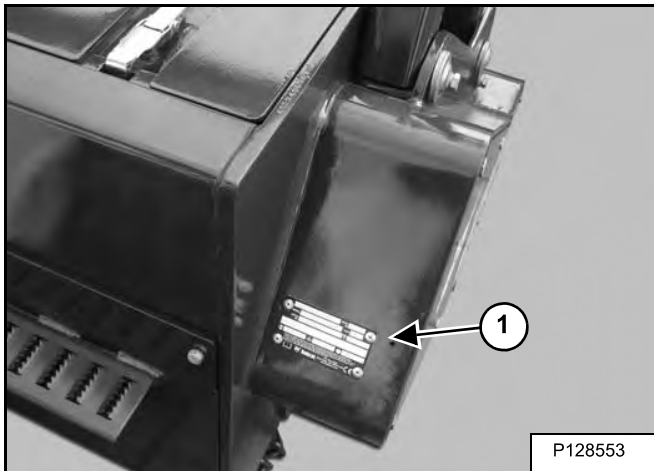

Always use the serial number (Item 1) [Figure 1] of the forestry cutter when requesting service information or when ordering parts (Serial number is located under the left cover).

Later models (identification made by serial number) may use different parts, or it may be necessary to use a different procedure in doing a specific service operation.

## MANUAL STORAGE

Figure 2

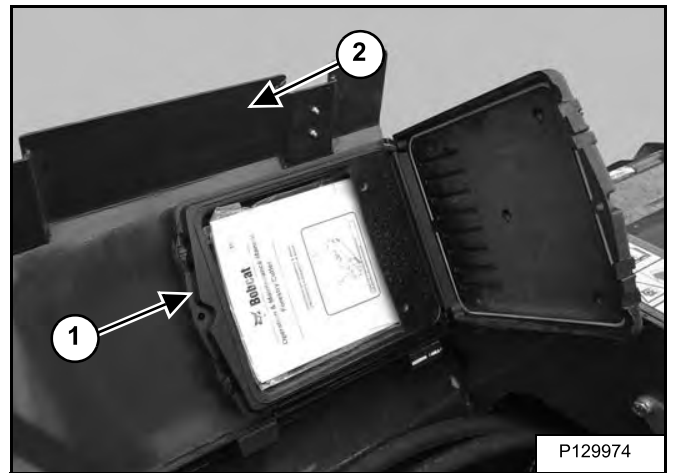

The manual storage container (Item 1) is mounted under the left cover (Item 2) [Figure 2] of the forestry cutter.

## FORESTRY DOOR SERIAL NUMBER

Figure 3

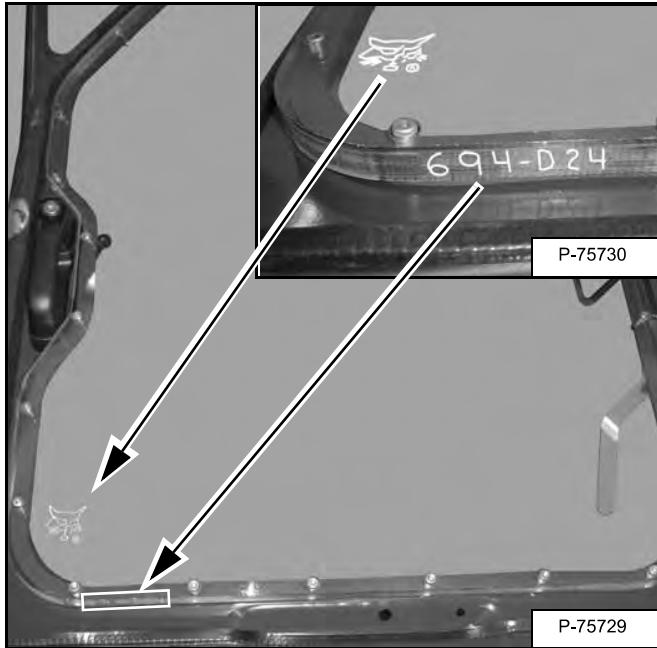

The forestry door serial number is located under the lower right-hand corner of the window (as viewed from the operator's seat) below the Bobcat logo [Figure 3].

## DELIVERY REPORT

Figure 4

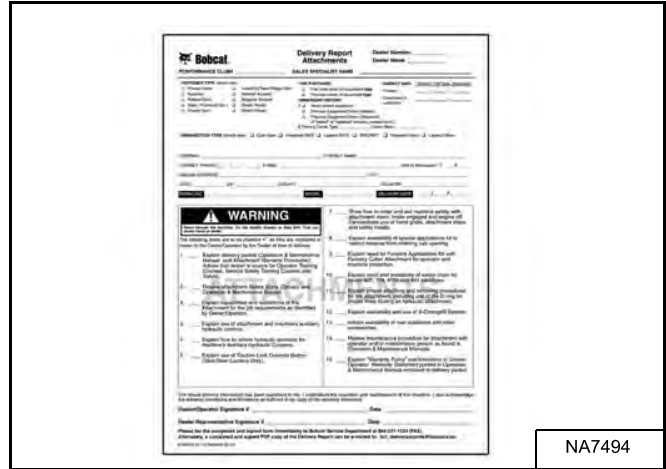

The delivery report [Figure 4] contains a list of items that must be explained or shown to the owner or operator by the dealer when the Bobcat forestry cutter is delivered.

The delivery report must be reviewed and signed by the owner or operator and the dealer.

**ATTACHMENT IDENTIFICATION**

Forestry Cutter (FRC150ST S/N B4A900101 & Above, FRC150HT S/N B4A800101 & Above and FRC200HT S/N B48J00101 & Above)

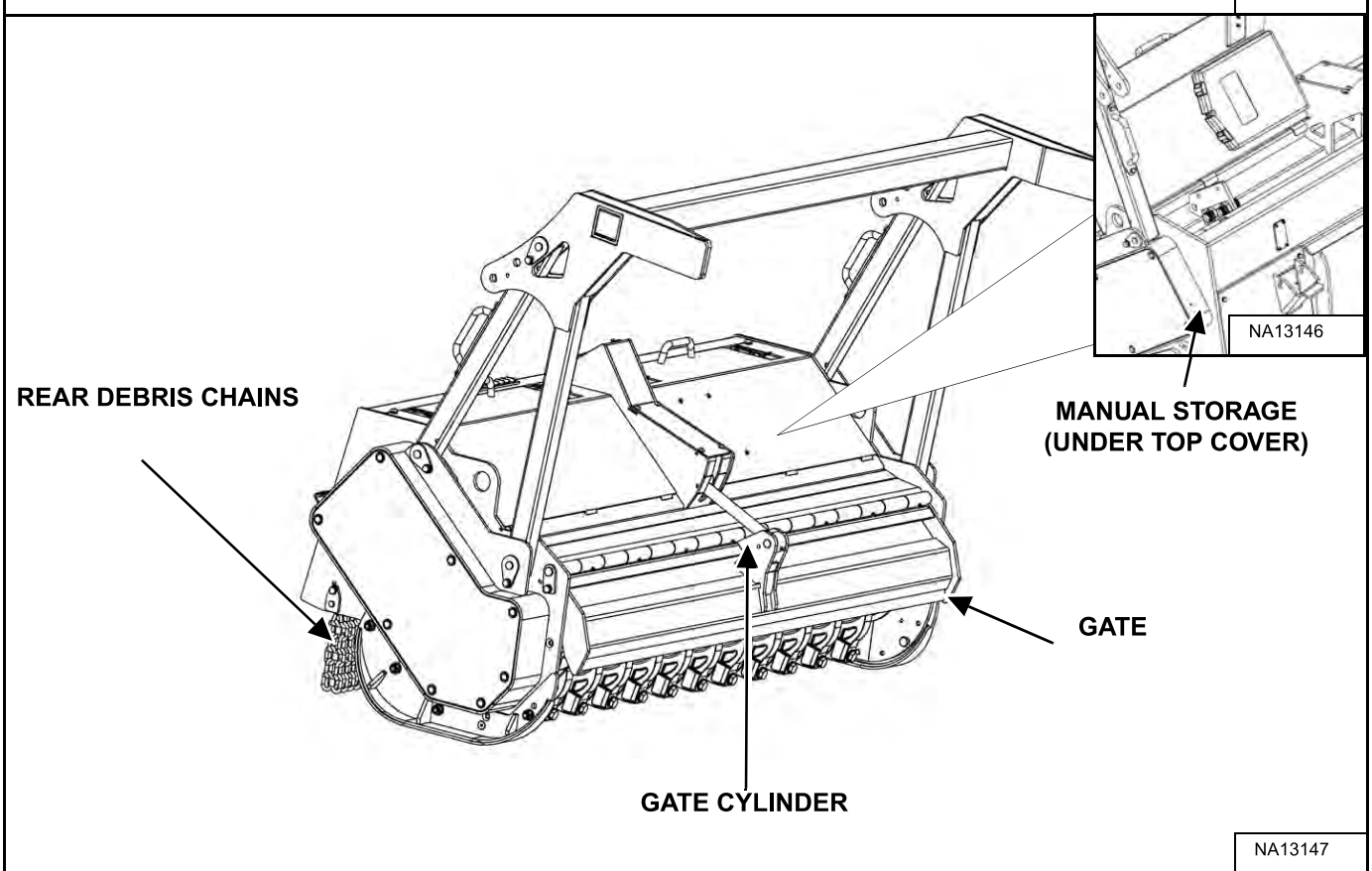
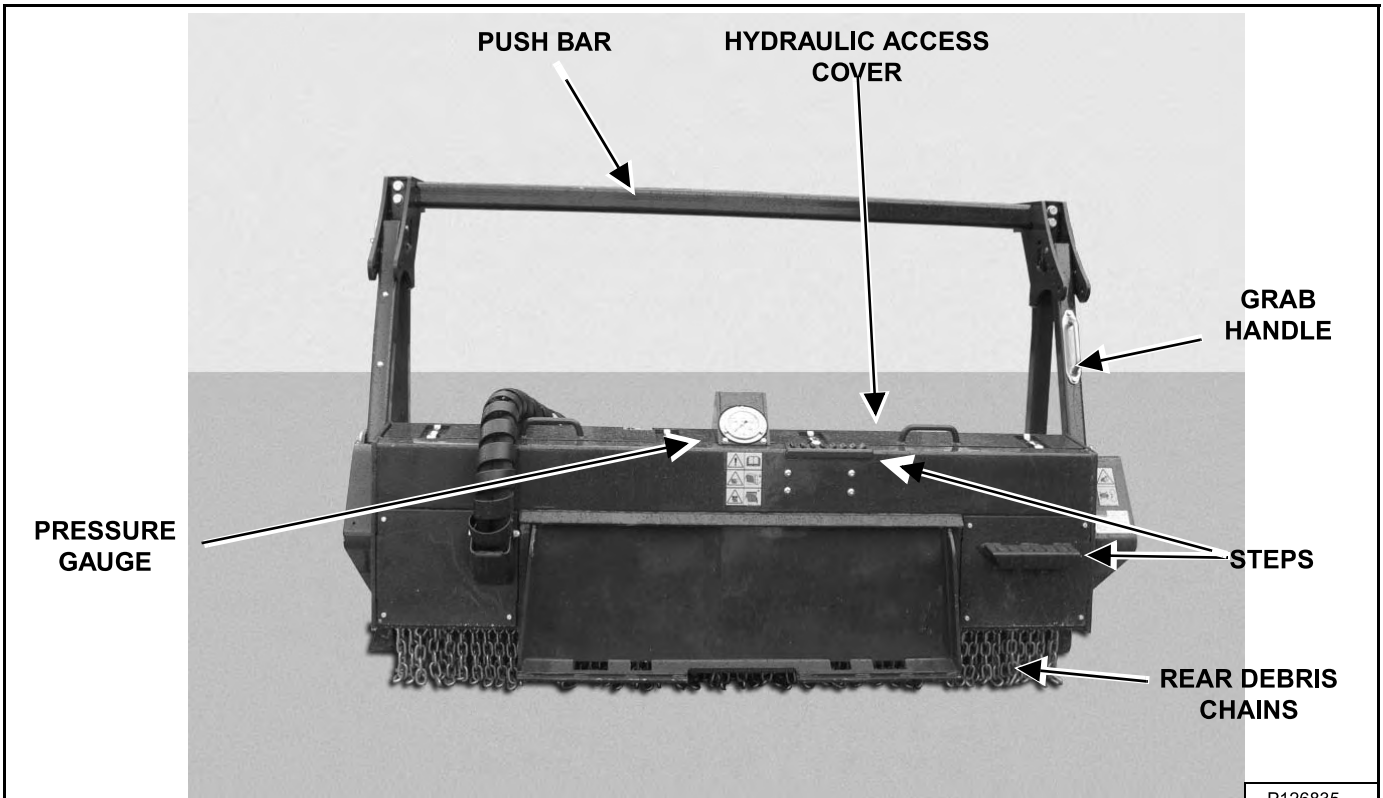

ATTACHMENT IDENTIFICATION (CONT'D)

Forestry Kit Equipment

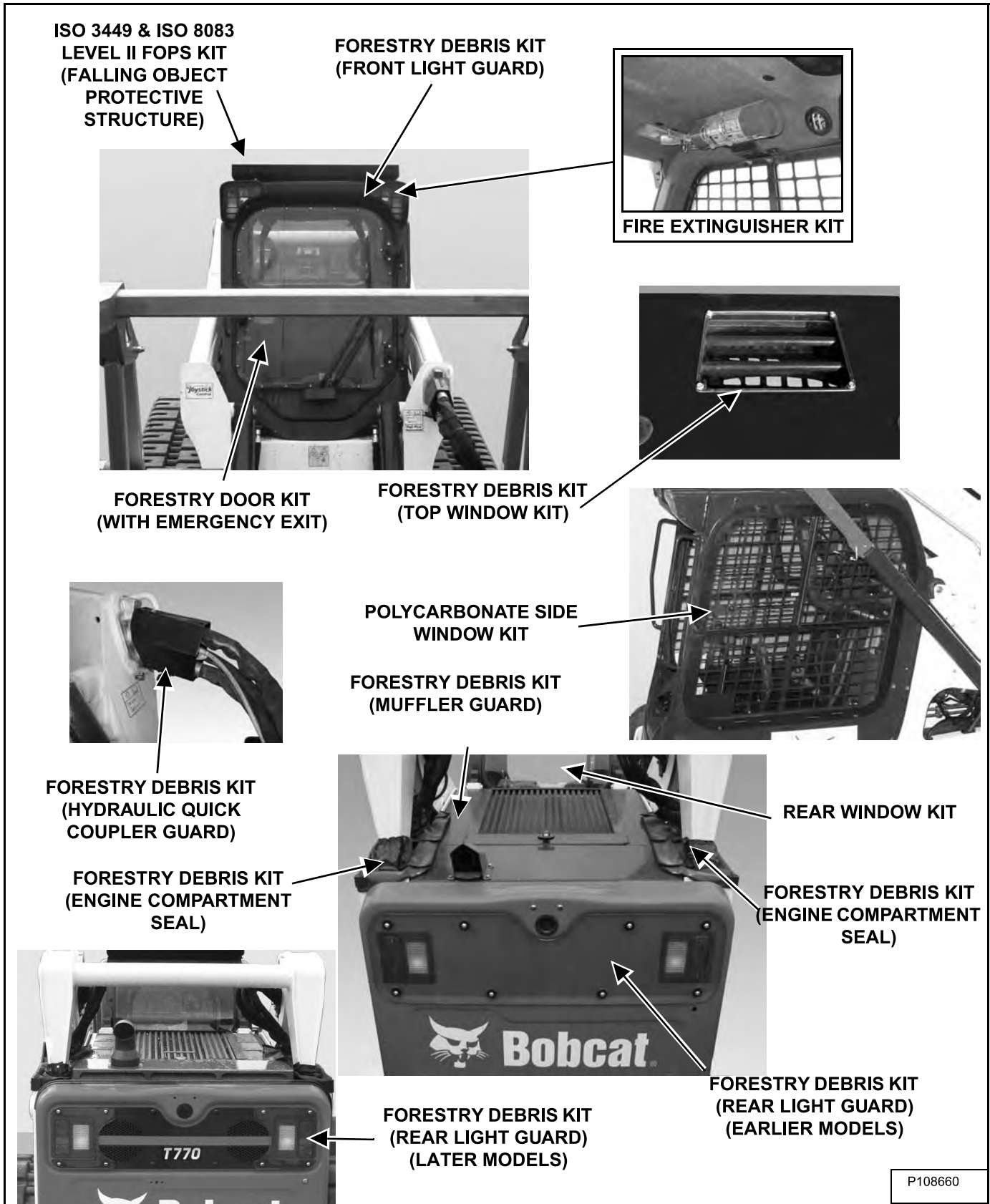

## SAFETY AND MAINTENANCE

TROUBLESHOOTING .....	10-10-1
Chart .....	10-10-1
SERVICE SCHEDULE .....	10-20-1
Chart .....	10-20-1
DAILY INSPECTION .....	10-30-1
Loader And Forestry Cutter .....	10-30-1
Guards, Shields, Seals And Decals .....	10-30-1
Hydraulic Hoses And Fittings .....	10-30-1
Hydraulic Fuse .....	10-30-1
Forestry Door .....	10-30-2
Forestry Door Interlock .....	10-30-3
Forestry Cutter Mounting Frame .....	10-30-3
Level II Falling-Object Protective Structure (FOPS) .....	10-30-4
Debris Chains .....	10-30-4
Drum .....	10-30-5
Drive Belt .....	10-30-6
Counter Knife Segments .....	10-30-7
Fire Extinguisher .....	10-30-8
Bob-Tach .....	10-30-9
Cleaning The Loader And Forestry Cutter .....	10-30-11
LUBRICATING THE FORESTRY CUTTER .....	10-40-1
Lubrication Locations .....	10-40-1
CARBIDE TEETH .....	10-50-1
Removal And Installation .....	10-50-1
CLEANING THE LOADER .....	10-60-1
Loader Cleaning (Earlier Models) .....	10-60-1
Loader Cleaning (Later Models) .....	10-60-3
Engine Compartment Cleaning .....	10-60-8
CLEANING THE FORESTRY CUTTER .....	10-70-1
Forestry Cutter Cleaning .....	10-70-1
ATTACHMENT STORAGE AND RETURN TO SERVICE .....	10-80-1
Storage .....	10-80-1
Return To Service .....	10-80-1



**Bobcat®**

## TROUBLESHOOTING

### Chart

 <b style="font-size: 24pt; margin-left: 10px;">WARNING</b>	<p>Instructions are necessary before operating or servicing machine. Read and understand the Operation &amp; Maintenance Manual, Operator's Handbook and signs (decals) on machine. Follow warnings and instructions in the manuals when making repairs, adjustments or servicing. Check for correct function after adjustments, repairs or service. Untrained operators and failure to follow instructions can cause injury or death.</p> <p style="text-align: right; font-size: 10pt;">W-2003-0807</p>
--	---

If the attachment is not working correctly, check the hydraulic system of the machine thoroughly before making any repairs on the attachment. Attachment problems can be affected by a hydraulic system that is not operating to specifications. Connect a flow meter to the machine to check the hydraulic pump output, relief valve setting and tube lines to check flow and pressure. (See the machine's Service Manual for the correct procedure to connect the flow meter.)

Use the following troubleshooting chart to locate and correct problems which most often occur with the attachment.

PROBLEM	CAUSE	CORRECTION
Drum will not turn.	Forestry door open.	Close forestry door.
	Wire harness disconnected.	Install wire harness.
	Quick couplers disconnected.	Install quick couplers.
	Auxiliary hydraulics not engaged.	Engage auxiliary hydraulics.
	Unapproved door installed.	Install approved door.
	Rotor is jammed or plugged.	Unplug rotor.
	Belt may be loose or damaged.	Tighten or replace belt.
	Pulley may be loose or damaged.	Tighten or replace pulley.
Auxiliary hydraulics will not start.	Forestry door open.	Close forestry door.
	Unapproved door installed.	Install approved door.
Forestry cutter performs poorly.	Material engagement speed too fast.	Engage material at a slower speed.
	Gate not closed while making final passes.	Close gate during final passes.
	Final passes not performed in reverse travel direction.	Perform final passes in reverse travel direction.
Hydraulic motor leakage (Drive Shaft bleed plug leakage) (FRC150HT & FRC200HT).	Damaged shaft seal.	Remove hydraulic motor and replace shaft seal. Inspect hydraulic motor for overpressure condition.
	Oil drain line obstruction	Remove oil drain line and clear the obstruction.
	Improper drain line connection.	Connect the drain line.
	Quick coupler hydraulic block.	Replace pressure line cartridge on the carrier Quick Connect block.
Hydraulic motor leakage (FRC150ST)	Oil drain line obstruction	Remove oil drain line and clear the obstruction.
	Quick coupler hydraulic block.	Replace pressure line cartridge on the carrier Quick Connect block.



**Bobcat®**

## SERVICE SCHEDULE

### Chart

Maintenance work must be done at regular intervals. Failure to do so will result in excessive wear and early failures. The service schedule is a guide for correct maintenance of the Bobcat three-point hitch adapter.

 <b style="font-size: 24pt; margin-left: 10px;">WARNING</b>	<p><b>Instructions are necessary before operating or servicing machine. Read and understand the Operation &amp; Maintenance Manual, Operator's Handbook and signs (decals) on machine. Follow warnings and instructions in the manuals when making repairs, adjustments or servicing. Check for correct function after adjustments, repairs or service. Untrained operators and failure to follow instructions can cause injury or death.</b></p> <p style="text-align: right; font-size: 10pt;">W-2003-0807</p>
--	--

SERVICE SCHEDULE		HOURS		
ITEM	SERVICE REQUIRED	8	40	500
General Items	Check for proper function of the Forestry Door Interlock.			
	Inspect the Forestry Door for damage.			
	Inspect Level II Falling-Object Protective Structure (FOPS) for damage.			
	Clean debris, leaves, branches and flammable material from Forestry Cutter and machine.			
	Check cutting teeth and drum for cracks and damage.			
	Check teeth mounting hardware for proper torque. *			
	Check for damaged or leaking hydraulic hoses or fittings.			
	Check drive belt for cracks and damage after every 8 hours of operation.			
	Check drive belt for proper tension after first 8 hours of operation then every 40 hours thereafter.			
Decals	Check for damaged and missing decals.			
Lubrication	Lubricate drum bearings.			
	Lubricate front gate hinge.			
	Lubricate Cylinder.			
Drive Shaft (FRC150HT & FRC200HT Only)	Replace oil after first 50 hours of operation then every 500 hours thereafter. Replace oil with Bobcat Transmission Oil 6987805 or oil compatible with ISO 220 or DIN51502.			

\* For proper torque. (See CARBIDE TEETH on Page 10-50-1.)



**Bobcat<sup>®</sup>**