



**Bobcat®**

**Tilt-Tatch**

# **Service Manual**

**S/N 224100101 & Above**

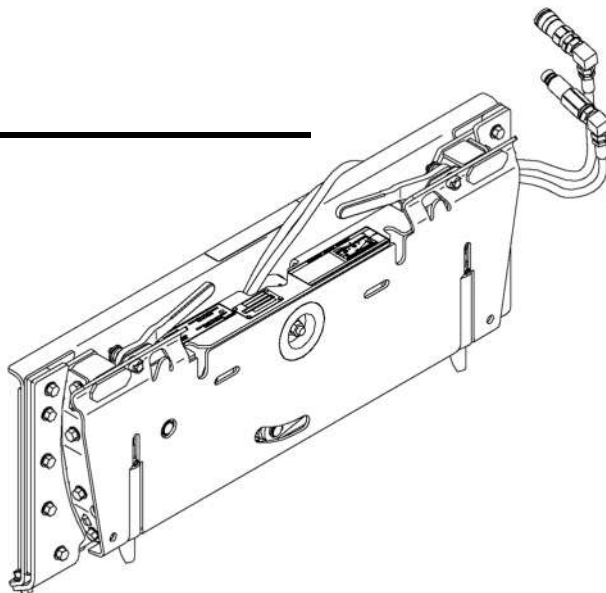



# MAINTENANCE SAFETY



## WARNING







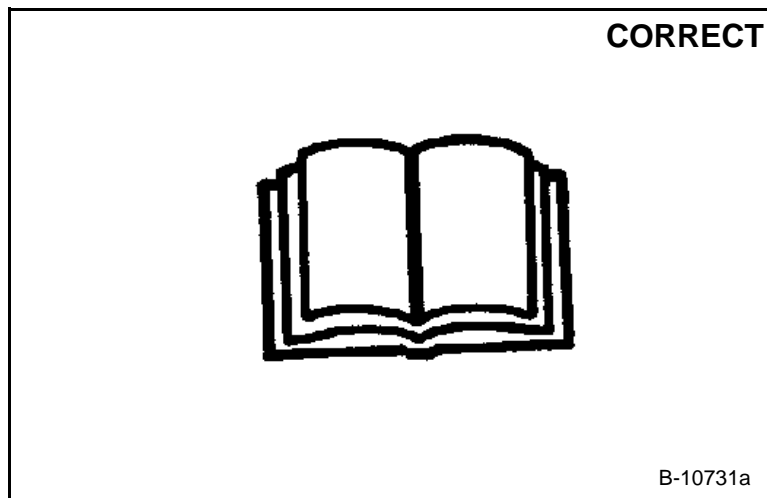

Instructions are necessary before operating or servicing machine. Read and understand the Operation & Maintenance Manual, Operator's Handbook and signs (decals) on machine. Follow warnings and instructions in the manuals when making repairs, adjustments or servicing. Check for correct function after adjustments, repairs or service. Untrained operators and failure to follow instructions can cause injury or death.

W-2003-0903



**Safety Alert Symbol:** This symbol with a warning statement, means: "Warning, be alert! Your safety is involved!" Carefully read the message that follows.



-  Never service attachments without instructions. See Operation & Maintenance Manual and Attachment Service Manual.
-  Cleaning and maintenance are required daily.
-  Never service or adjust attachment with the engine running unless instructed to do so in manual.
-  Always lower the attachment to the ground before lubricating or servicing.
-  Avoid contact with leaking hydraulic fluid or diesel fuel under pressure. It can penetrate skin or eyes.
-  Stop, cool and clean engine of flammable materials before checking fluids.
-  Keep body, loose objects and clothing away from moving parts, electrical contacts, hot parts and exhaust.
-  Safety glasses are needed for eye protection from electrical arcs, battery acid, compressed springs, fluids under pressure and flying debris or when tools are used. Use eye protection approved for type of welding.



**Bobcat®**

## ALPHEBETICAL INDEX

HYDRAULIC CYLINDER .....	20-10-1
HYDRAULIC SCHEMATIC .....	SPEC-20-1
INSPECTION .....	10-20-1
LEVER AND WEDGE .....	30-20-1
LUBRICATION .....	10-30-1
SPECIFICATIONS .....	SPEC-10-1
TROUBLESHOOTING .....	10-10-1
WEAR PLATE REPLACEMENT .....	30-10-1



## CONTENTS

IDENTIFICATION AND MACHINE SIGNS (DECALS) .....	IV
SERIAL NUMBER LOCATION .....	III
SAFETY AND MAINTENANCE .....	10-01
HYDRAULIC SYSTEM .....	20-01
MAIN FRAME .....	30-01
SPECIFICATIONS AND SCHEMATICS .....	SPEC-01

**SAFETY AND  
MAINTENANCE**

**HYDRAULIC  
SYSTEM**

**MAIN  
FRAME**

**SPECIFICATIONS  
AND  
SCHEMATICS**

### CALIFORNIA

#### PROPOSITION 65 WARNING

Diesel engine exhaust and some of its constituents are known to the State of California to cause cancer, birth defects and other reproductive harm.





## SERIAL NUMBER LOCATION

Always use the serial number of the Tilt-Tatch when requesting service information or when ordering parts. Early or later models (identification made by serial number) may use different parts, or it may be necessary to use a different procedure in doing a specific service operation.

### Serial Number Location

Figure 1

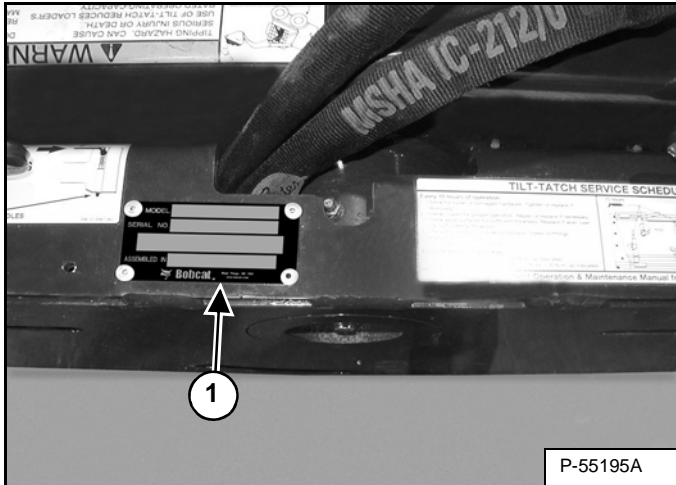

The Tilt-Tatch serial number plate (Item 1) [Figure 1] is located on the frame in the location shown.

**IDENTIFICATION AND MACHINE SIGNS (DECALS)**

	<b>WARNING</b>	
	TIPPING HAZARD. CAN CAUSE SERIOUS INJURY OR DEATH. USE OF THE ATTACHMENT REDUCES LOADER'S RATED OPERATING CAPACITY.	DO NOT OVERLOAD. READ ATTACHMENT OPERATOR'S MANUAL FOR INSTRUCTIONS.

TILT-TATCH SERVICE SCHEDULE	
<b>Every 10 hours of operation:</b> 1. Check for loose or damaged hardware. Tighten or replace if necessary. 2. Check covers for proper operation. Repair or replace if necessary. 3. Check wear surfaces for sufficient thickness. Replace if worn over one half material thickness. 4. Check for damaged or leaking hydraulic hoses or fittings. Replace if necessary. 5. Lubricate all (5) grease points.	
<b>Every 50 hours of operation:</b> 1. Torque pivot bolt to 150 ft-lbs (200 N-m) as indicated. 2. Torque (12) retaining plate bolts to 100 ft-lbs (135 N-m) as indicated.	
See Attachment Operation & Maintenance Manual for more information	

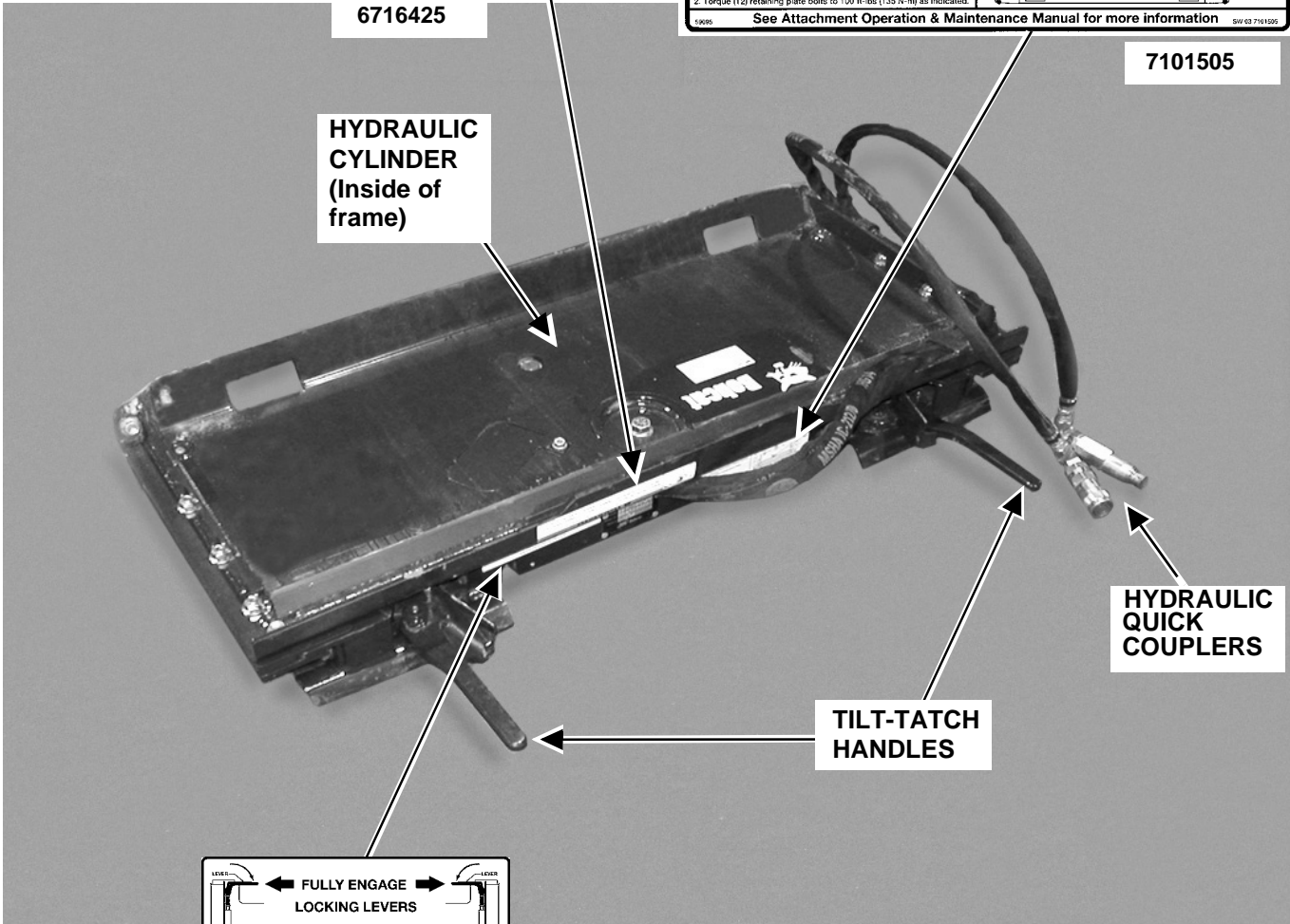

**6716425**

**HYDRAULIC CYLINDER (Inside of frame)**

**7101505**

**HYDRAULIC QUICK COUPLERS**

**TILT-TATCH HANDLES**

<b>FULLY ENGAGE LOCKING LEVERS</b>
WEDGES MUST EXTEND THROUGH MOUNTING FRAME HOLES

**5651383**

P-55191

## SAFETY AND MAINTENANCE

## SAFETY AND MAINTENANCE

INSPECTION .....	10-20-1
Hand Lever Bob-Tach Inspection.....	10-20-1
Power Bob-Tach Inspection.....	10-20-2
Tilt-Tatch Mount Inspection .....	10-20-3
LUBRICATION .....	10-30-1
TROUBLESHOOTING .....	10-10-1



**Bobcat®**

## TROUBLESHOOTING



Instructions are necessary before operating or servicing machine. Read and understand the Operation & Maintenance Manual, Operator's Handbook and signs (decals) on machine. Follow warnings and instructions in the manuals when making repairs, adjustments or servicing. Check for correct function after adjustments, repairs or service. Untrained operators and failure to follow instructions can cause injury or death.

W-2003-0903

If the Tilt-Tatch is not working correctly, check the hydraulic system of the Bobcat Loader thoroughly before making any repairs on the Tilt-Tatch. Tilt-Tatch problems can be affected by a hydraulic system that is not operating to specifications or such problems as a plugged hydraulic filter in the loader. Connect a flow meter to the loader to check the hydraulic pump output, relief valve setting and tubelines to check flow and pressure. (See the Loader service manual for the correct procedure to connect the flow meter.)

TROUBLESHOOTING THE TILT-TATCH		
PROBLEM	CAUSE	CORRECTION
Tilt-Tatch does not mount properly on the Bob-Tach.	Bob-tach wedges are not fully retracted before installation.	Retract Bob-Tach wedges before installation.
	Mud, dirt or stones are lodged between the Bob-Tach and the Tilt-Tatch mount.	Remove debris between Bob-Tach and Tilt-Tatch mount.
Tilt-Tatch does not angle.	Auxiliary front hydraulics not engaged.	Activate loader front auxiliary hydraulics.
	No hydraulic flow.	Check quick couplers connection. Check for damaged hose ends and fittings.
	Excessive dirt and debris in Tilt-Tatch	Remove dirt and debris.
Excessive movement between Tilt-Tatch plates.	Center pivot bolt is loose.	Tighten to correct torque.
	Wear plates are worn.	Replace wear plates.



**Bobcat®**

## INSPECTION

### Hand Lever Bob-Tach Inspection

# ! WARNING

Bob-Tach wedges must extend through the holes in attachment. Levers must be fully down and locked. Failure to secure wedges can allow attachment to come off and cause injury or death.

W-2102-0588

Figure 10-20-1

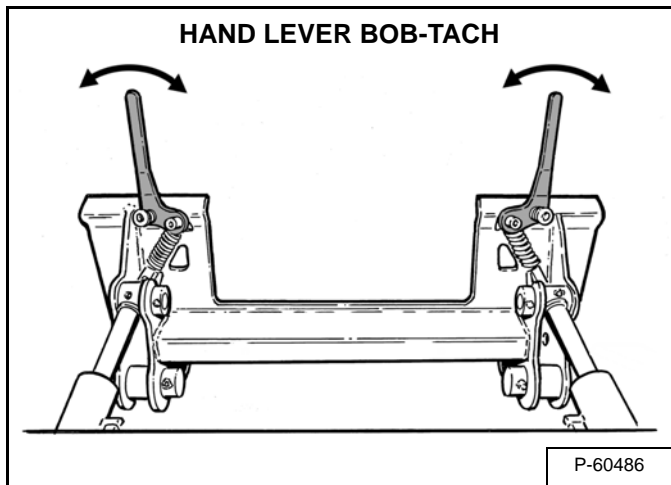

Move the Bob-Tach levers to engage and disengage the wedges [Figure 10-20-1]. The levers and wedges must move freely.

Figure 10-20-2

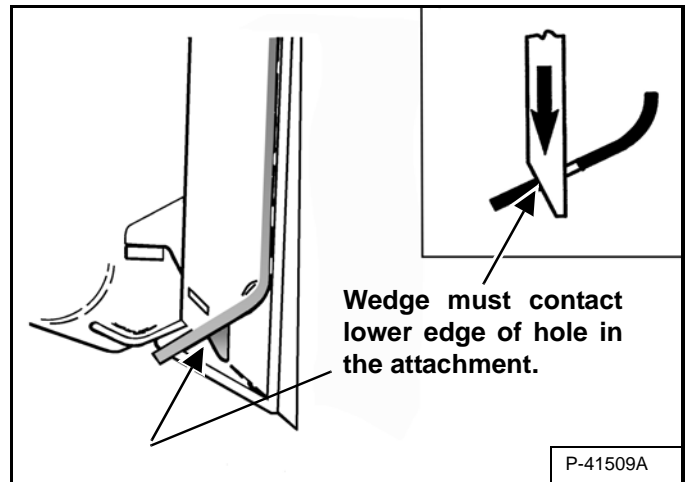

The wedges must extend through the holes in the attachment mounting frame [Figure 10-20-2].

If the wedge does not contact the lower edge of the hole [Figure 10-20-2], the attachment will be loose and can come off the Bob-Tach.

Figure 10-20-3

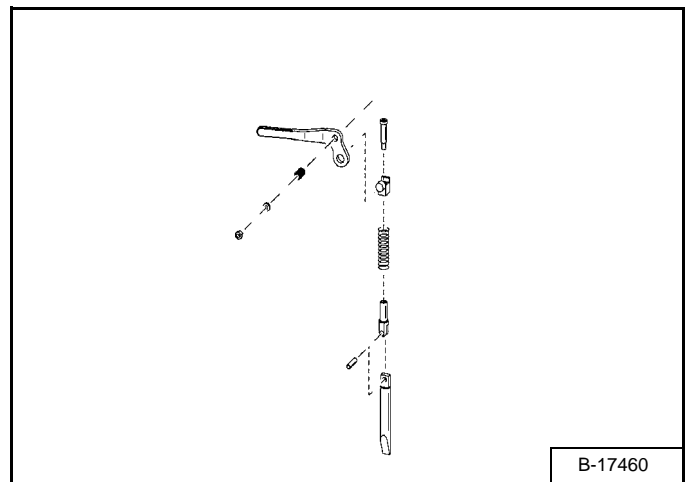

Inspect the mounting frame on the attachment and the Bob-Tach, linkages and wedges for excessive wear or damage [Figure 10-20-3]. Replace any parts that are damaged, bent or missing. Keep all fasteners tight.

Look for cracked welds. Contact your Bobcat dealer for repair or replacement parts.

Lubricate the wedges. (See the correct loader Operation & Maintenance Manual for *LUBRICATION OF THE BOBCAT LOADER*.)

## INSPECTION (CONT'D)

### Power Bob-Tach Inspection

# ! WARNING

Bob-Tach wedges must extend through the holes in attachment. Levers must be fully down and locked. Failure to secure wedges can allow attachment to come off and cause injury or death.

W-2102-0588

Figure 10-20-4

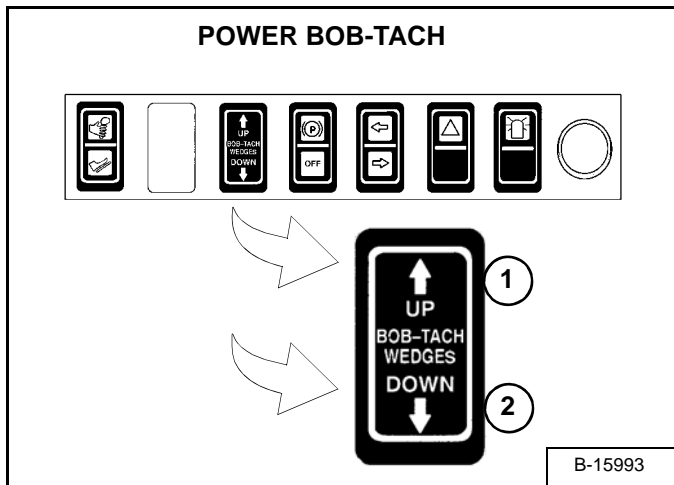
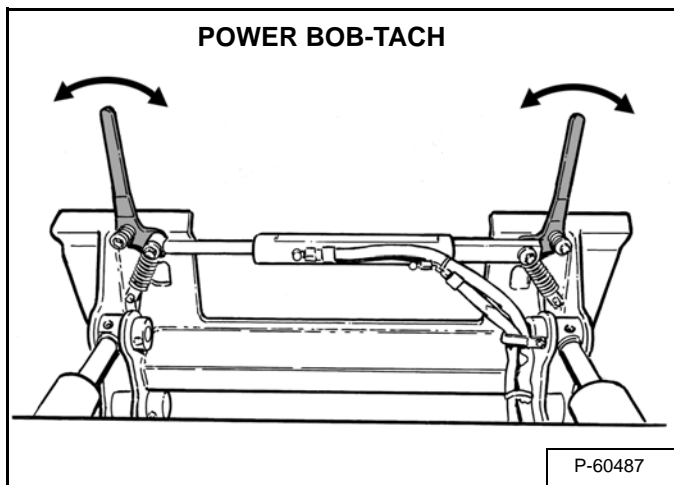

Figure 10-20-5



Push and hold the BOB-TACH WEDGES UP switch (Item 1) until the wedges are fully raised. Push and hold the BOB-TACH WEDGES DOWN switch (Item 2) [Figure 10-20-4] until the wedges are fully lowered.

The levers and wedges must move freely [Figure 10-20-5].

Figure 10-20-6

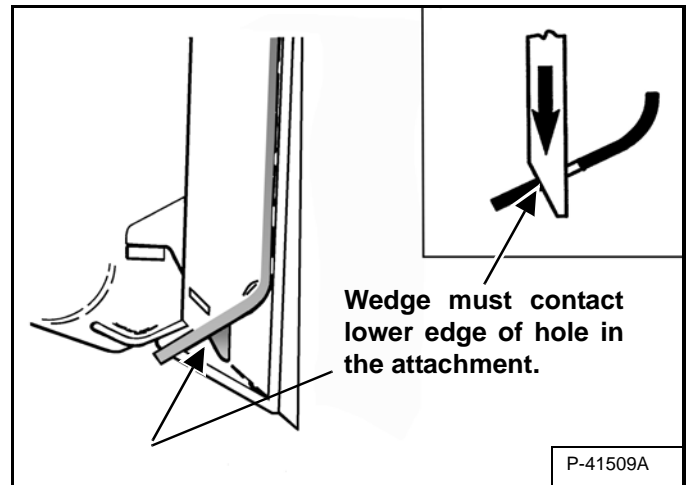

The wedges must extend through the holes in the attachment mounting frame [Figure 10-20-6].

If the wedge does not contact the lower edge of the hole [Figure 10-20-6], the attachment will be loose and can come off the Bob-Tach.

Figure 10-20-7

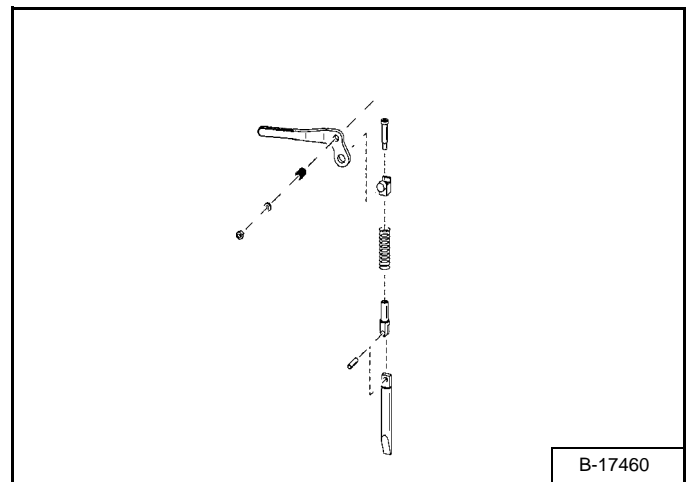

Inspect the mounting frame on the attachment and the Bob-Tach, linkages and wedges for excessive wear or damage [Figure 10-20-7]. Replace any parts that are damaged, bent or missing. Keep all fasteners tight.

Look for cracked welds. Contact your Bobcat dealer for repair or replacement parts.

Lubricate the wedges. (See the correct loader Operation & Maintenance Manual for *LUBRICATION OF THE BOBCAT LOADER*.)



## INSPECTION (CONT'D)

### Tilt-Tatch Mount Inspection

Figure 10-20-8

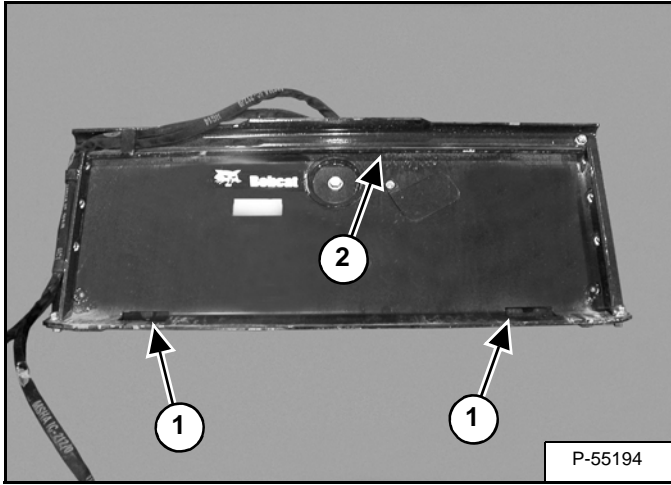

Inspect the Bob-Tach wedge mounts (Item 1), mounting flange (Item 2) and all welds on the tilt-tatch for wear and damage each time the tilt-tatch is removed from the machine [Figure 10-20-8].

Figure 10-20-9

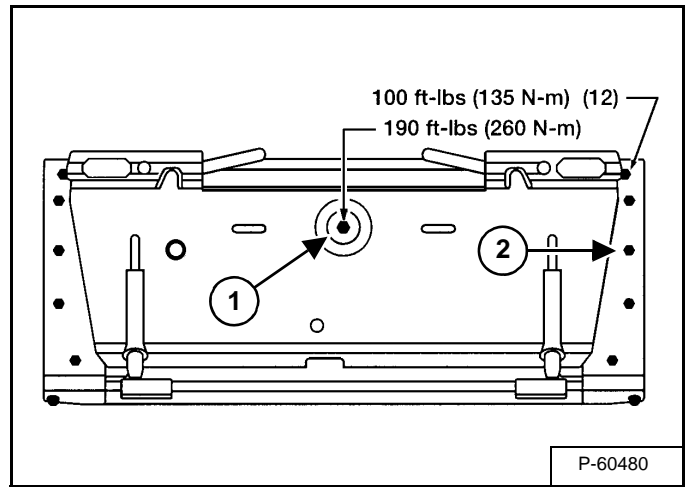

Frequently inspect the tilt-tatch to ensure that all components are secure and that all bolts and nuts are thoroughly tightened.

#### ***Every 50 Hours Of Operation***

Torque pivot bolt (Item 1) [Figure 10-20-9] to 190 ft-lbs (260 Nm) torque as indicated.

Torque (12) retaining plate bolts (Item 2) [Figure 10-20-9] to 100 ft-lbs (135 Nm) torque as indicated.



**Bobcat**®

**Dear**

**Thanks very much for your visiting and  
patience.**

**Want to get more information,**

**Please click here, Go back to the page.**

**After your payment, you will have instant access to  
your download.**

**The Download Link will also be sent to your e-mail.**

**You will get the complete manual**

**Have any questions**

**please write to me**

**[admin@servicemanualperfect.com](mailto:admin@servicemanualperfect.com)**