



---

# Service Manual

## 38 Inch Tiller

---

(TILLER 38) - S/N 614400101 & Above

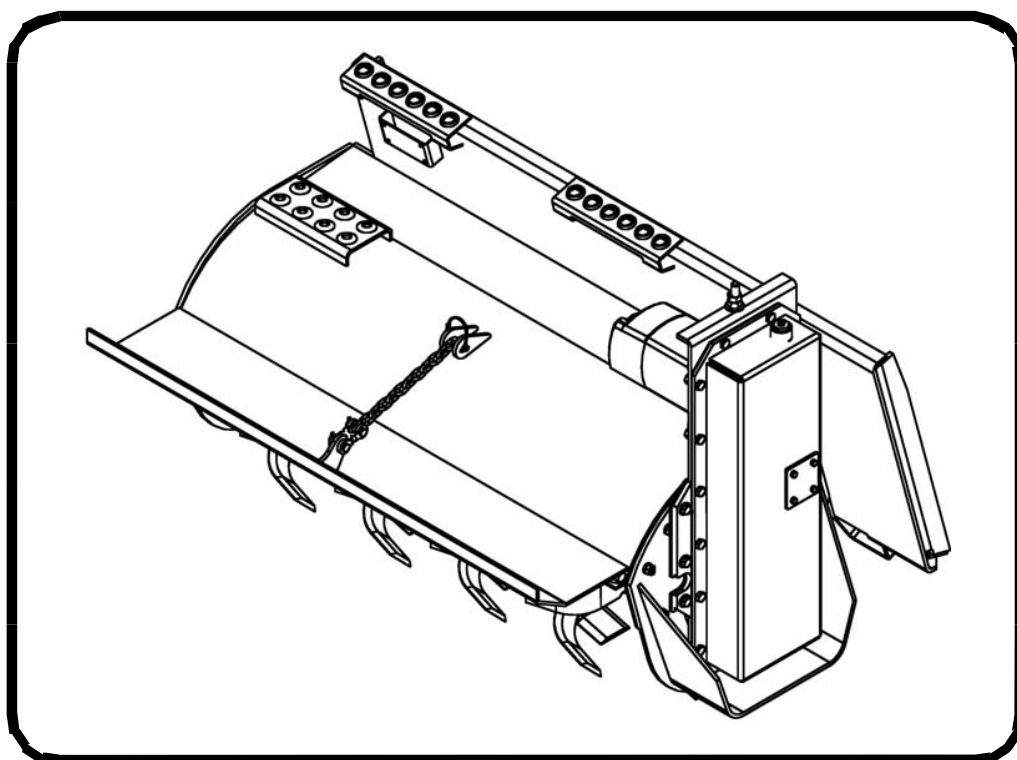



# MAINTENANCE SAFETY



## WARNING







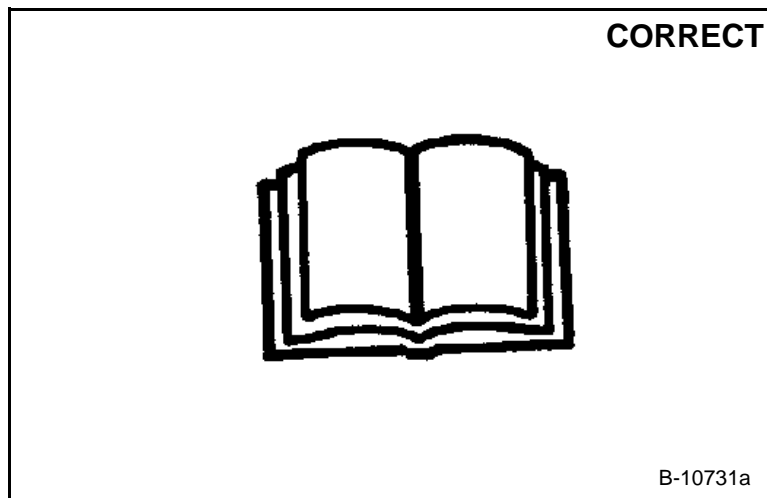

Instructions are necessary before operating or servicing machine. Read and understand the Operation & Maintenance Manual, Operator's Handbook and signs (decals) on machine. Follow warnings and instructions in the manuals when making repairs, adjustments or servicing. Check for correct function after adjustments, repairs or service. Untrained operators and failure to follow instructions can cause injury or death.

W-2003-0903



**Safety Alert Symbol:** This symbol with a warning statement, means: "Warning, be alert! Your safety is involved!" Carefully read the message that follows.



-  Never service attachments / implements without instructions. See Operation & Maintenance Manual and Attachment / Implement Service Manual.
-  Cleaning and maintenance are required daily.
-  Never service or adjust attachment / implement with the engine running unless instructed to do so in manual.
-  Always lower the attachment / implement to the ground before lubricating or servicing.
-  Avoid contact with leaking hydraulic fluid or diesel fuel under pressure. It can penetrate skin or eyes.
-  Stop, cool and clean engine of flammable materials before checking fluids.
-  Keep body, loose objects and clothing away from moving parts, electrical contacts, hot parts and exhaust.
-  Safety glasses are needed for eye protection from electrical arcs, battery acid, compressed springs, fluids under pressure and flying debris or when tools are used. Use eye protection approved for type of welding.



**Bobcat®**

## ALPHABETICAL INDEX

ATTACHMENT STORAGE AND RETURN TO SERVICE .	10-50-1
DELIVERY REPORT . . . . .	III
DRIVE CHAIN . . . . .	30-10-1
HYDRAULIC MOTOR . . . . .	20-10-1
IDENTIFICATION AND MACHINE SIGNS (DECALS) . . . . .	IV
INSPECTION. . . . .	10-20-1
REGULAR MAINTENANCE ITEMS . . . . .	10-30-1
REMOVAL AND INSTALLATION OF TINES . . . . .	10-40-1
SERIAL NUMBER LOCATION . . . . .	III
(TILLER 38) SPECIFICATIONS. . . . .	SPEC-10-1
TINE SHAFT BEARINGS AND SEALS . . . . .	30-20-1
TORQUE SPECIFICATIONS FOR BOLTS . . . . .	SPEC-20-1
TROUBLESHOOTING. . . . .	10-10-1



**Bobcat®**

# CONTENTS

**PREVENTIVE  
MAINTENANCE**

**HYDRAULIC  
SYSTEM**

**MAIN  
FRAME**

**SPECIFICATIONS  
AND  
SCHEMATICS**

SERIAL NUMBER LOCATION ..... III  
DELIVERY REPORT ..... III  
IDENTIFICATION AND MACHINE SIGNS (DECALS) ..... IV  
PREVENTIVE MAINTENANCE ..... 10-01  
HYDRAULIC SYSTEM ..... 20-01  
MAIN FRAME ..... 30-01  
SPECIFICATIONS AND SCHEMATICS ..... SPEC-01

## REFERENCE INFORMATION

Write the correct information for YOUR 38 inch tiller attachment in the spaces below.  
Always use these numbers when referring to your 38 inch tiller.

38 Inch Tiller Serial Number

---

---

---

---

NOTES:

---

---

---

---

YOUR BOBCAT® DEALER:

ADDRESS:

PHONE:

Bobcat Company  
P.O. Box 128  
Gwinner, ND 58040-0128

Bobcat Company Europe  
Drève Richelle 167  
B-1410 WATERLOO  
Belgium



**Bobcat®**



## SERIAL NUMBER LOCATION

Figure 1

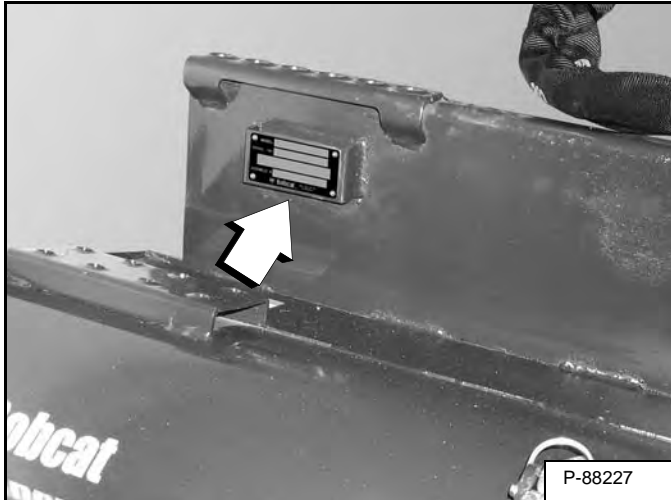

Always use the serial number of the 38 inch tiller when requesting service information or when ordering parts. Early or later models (identification made by serial number) may use different parts, or it may be necessary to use a different procedure in doing a specific service operation [Figure 1].

## DELIVERY REPORT

Figure 2

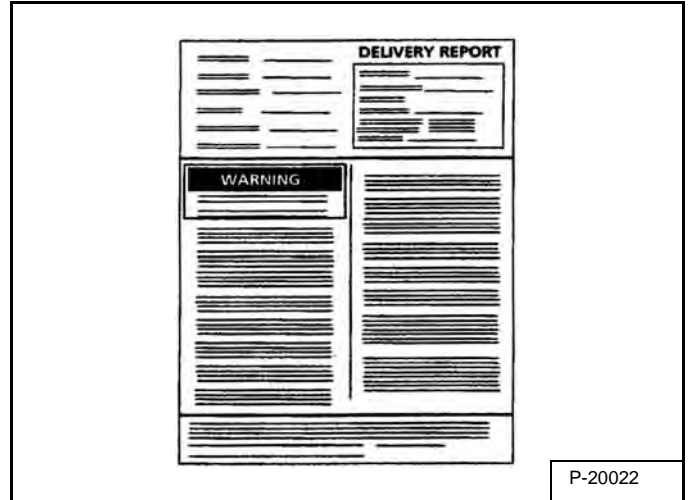

The delivery report must be filled out by the dealer and signed by the owner or operator when the 38 inch tiller is delivered. An explanation of the form must be given to the owner. Make sure it is filled out completely [Figure 2].

**IDENTIFICATION AND MACHINE SIGNS (DECALS)**

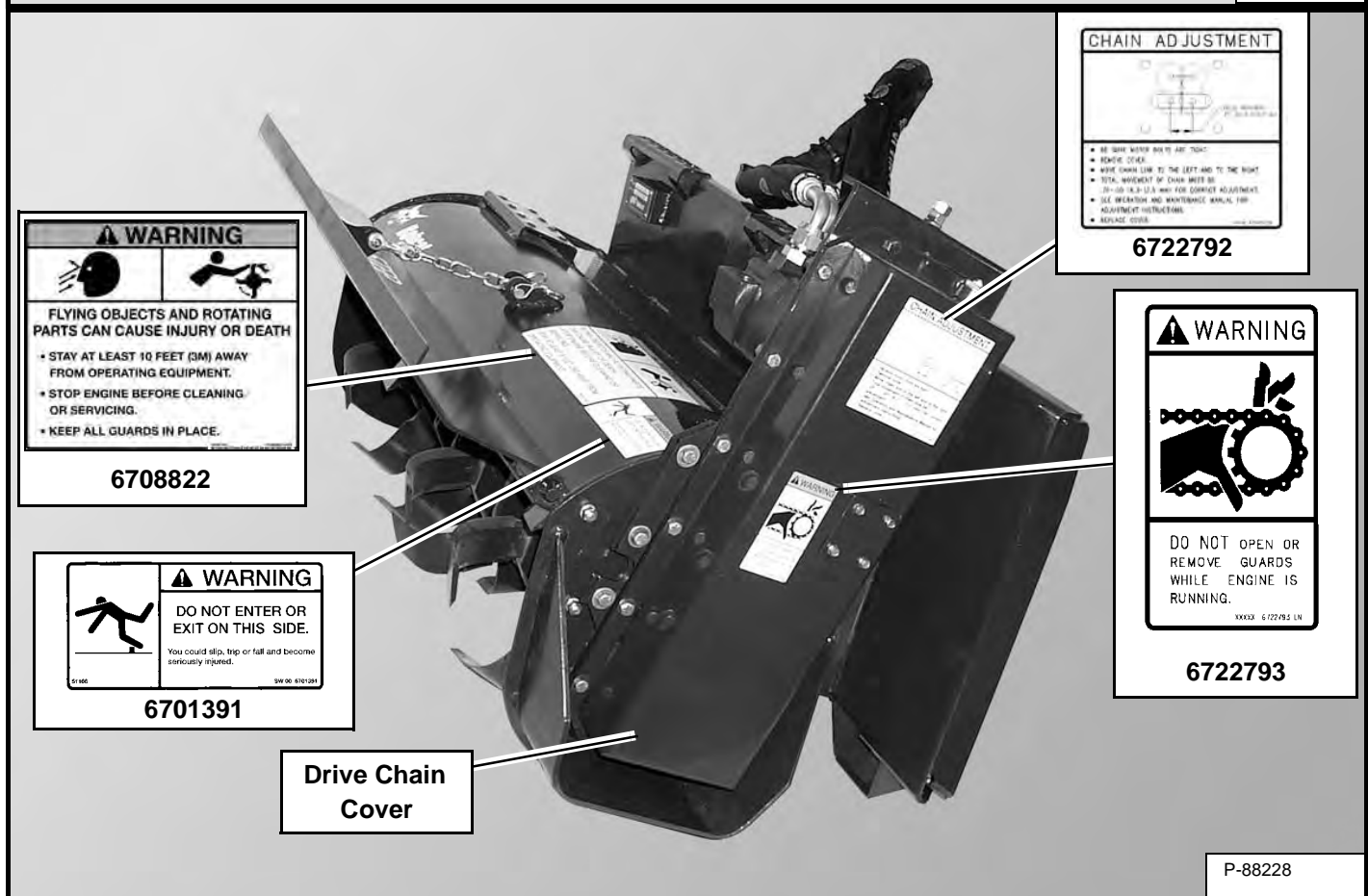
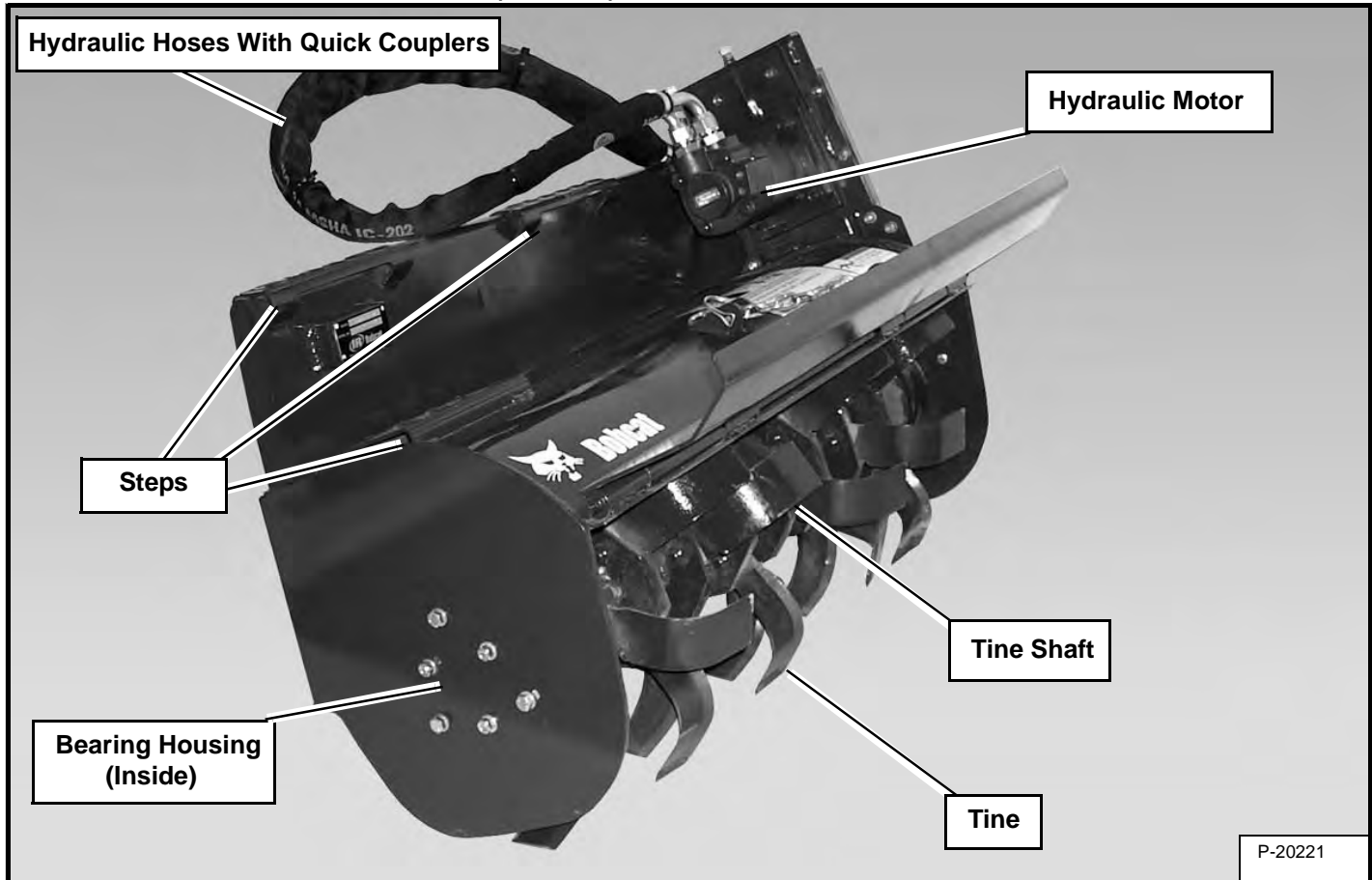

**PREVENTIVE MAINTENANCE**

ATTACHMENT STORAGE AND RETURN TO SERVICE . . . 10-50-1  
    Return to Service . . . . . 10-50-1  
    Storage . . . . . 10-50-1

INSPECTION . . . . . 10-20-1  
    Attachment Mounting Frame . . . . . 10-20-1  
    Bob-Tach . . . . . 10-20-1

REGULAR MAINTENANCE ITEMS . . . . . 10-30-1  
    300 Hour Inspection. . . . . 10-30-1  
    Adjusting the Drive Chain . . . . . 10-30-1

REMOVAL AND INSTALLATION OF TINES. . . . . 10-40-1  
    Procedure . . . . . 10-40-1

TROUBLESHOOTING . . . . . 10-10-1  
    Chart . . . . . 10-10-1



**Bobcat®**

## TROUBLESHOOTING

### Chart

PROBLEM	CAUSE	CORRECTION
Tiller does not mount properly on the Bob-Tach.	Bob-Tach wedges are not fully retracted before installation.	Retract Bob-Tach wedges before installation.
	Mud, dirt or stones are lodged between the Bob-Tach and the tiller mount.	Remove debris between Bob-Tach and tiller mount.
Tiller tines do not rotate.	No hydraulic flow.	Activate loader front auxiliary hydraulics.
		Check quick couplers connection. Check for damaged hose ends and fittings.
Tiller is performing poorly.	Tines may be worn.	Replace tines as needed.



**Bobcat®**

## INSPECTION

### Attachment Mounting Frame

Figure 10-20-1

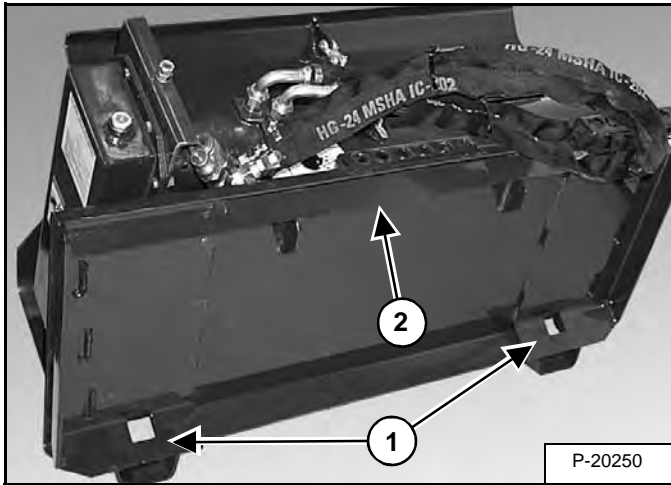

Inspect the Bob-Tach wedge mounts (Item 1), mounting flange (Item 2) [Figure 10-20-1] and all welds on the 38 inch tiller for wear and damage each time the 38 inch tiller is removed from the machine.

Look for cracked welds. Contact your Bobcat dealer for repair or replacement parts.

## Bob-Tach

### Hand Lever Bob-Tach



Bob-Tach wedges must extend through the holes in attachment. Lever(s) must be fully down and locked. Failure to secure wedges can allow attachment to come off and cause injury or death.

W-2102-0497

Figure 10-20-2

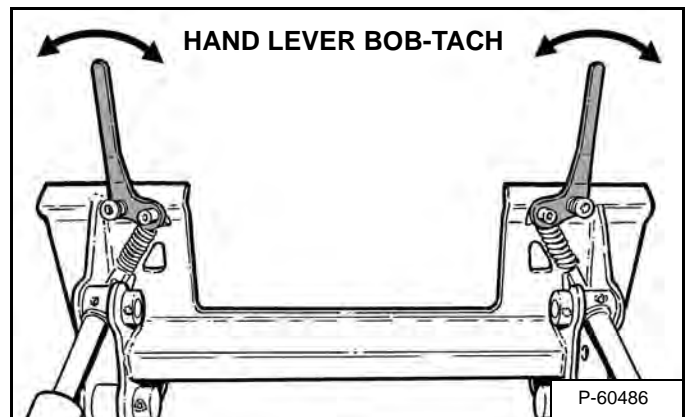

Move the Bob-Tach levers to engage and disengage the wedges [Figure 10-20-2]. The levers and wedges must move freely.

Figure 10-20-3

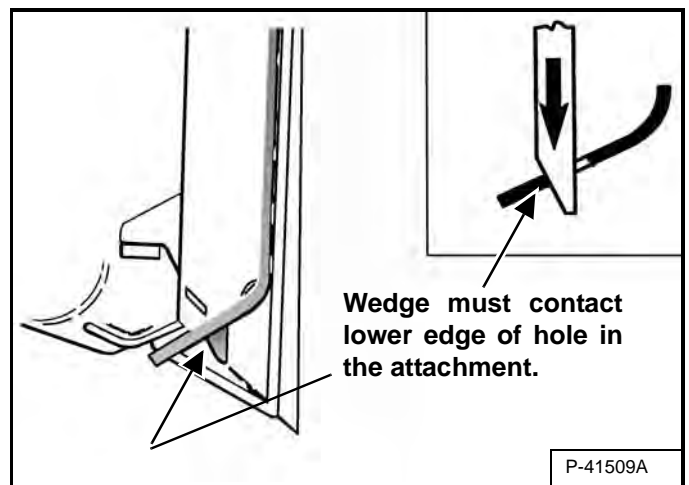

The wedges must extend through the holes in the attachment mounting frame [Figure 10-20-3].

If the wedge does not contact the lower edge of the hole [Figure 10-20-3], the attachment will be loose and can come off the Bob-Tach.

## INSPECTION (CONT'D)

### Bob-Tach (Cont'd)

#### Hand Lever Bob-Tach (Cont'd)

Figure 10-20-4

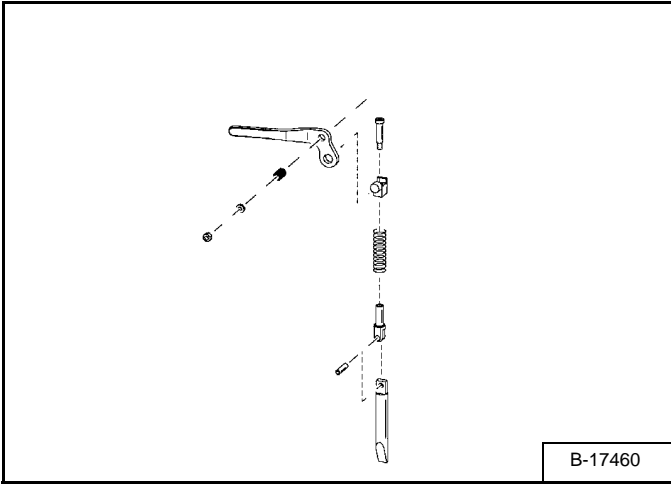

Inspect the mounting frame on the attachment and the Bob-Tach, linkages and wedges for excessive wear or damage [Figure 10-20-4]. Replace any parts that are damaged, bent or missing. Keep all fasteners tight.

Look for cracked welds. Contact your Bobcat dealer for repair or replacement parts.

Lubricate the wedges. (See the correct machine's Operation & Maintenance Manual for lubrication procedure.)

## Power Bob-Tach

# ! WARNING

Bob-Tach wedges must extend through the holes in attachment. Lever(s) must be fully down and locked. Failure to secure wedges can allow attachment to come off and cause injury or death.

W-2102-0497

Figure 10-20-5

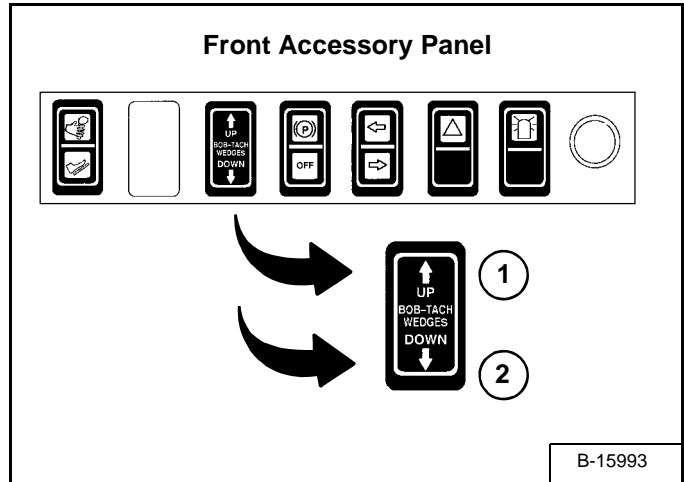
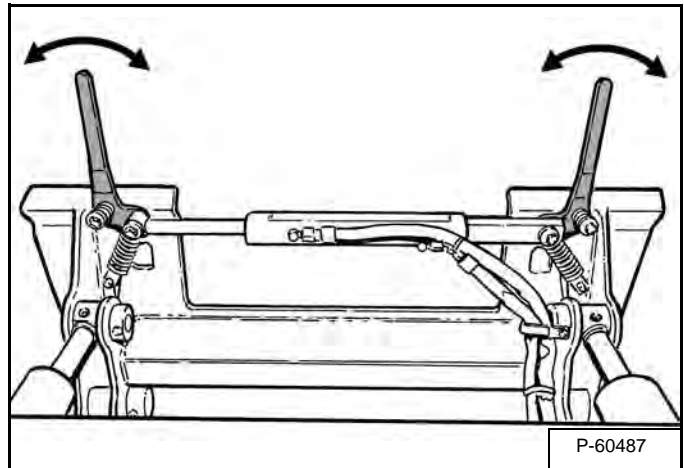

Figure 10-20-6



Push and hold the BOB-TACH WEDGES UP switch (Item 1) until the wedges are fully raised. Push and hold the BOB-TACH WEDGES DOWN switch (Item 2) [Figure 10-20-5] until the wedges are fully lowered.

The levers and wedges must move freely [Figure 10-20-6].



## INSPECTION (CONT'D)

### Bob-Tach (Cont'd)

#### Power Bob-Tach (Cont'd)

Figure 10-20-7

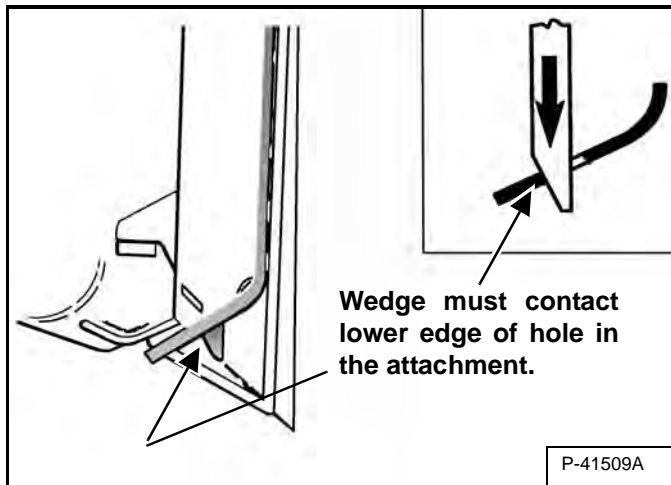

The wedges must extend through the holes in the attachment mounting frame **[Figure 10-20-7]**.

If the wedge does not contact the lower edge of the hole **[Figure 10-20-7]**, the attachment will be loose and can come off the Bob-Tach.

Figure 10-20-8

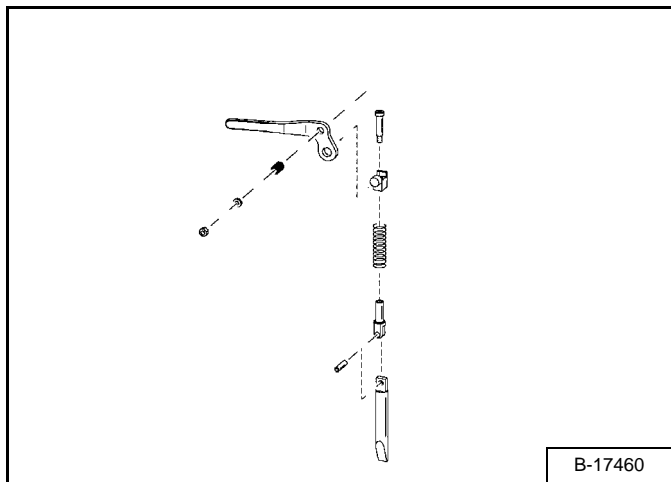

Inspect the mounting frame on the attachment and the Bob-Tach, linkages and wedges for excessive wear or damage **[Figure 10-20-8]**. Replace any parts that are damaged, bent or missing. Keep all fasteners tight.

Look for cracked welds. Contact your Bobcat dealer for repair or replacement parts.

Lubricate the wedges. (See the correct machine's Operation & Maintenance Manual for lubrication procedure.)



**Bobcat®**

**Dear**

**Thanks very much for your visiting and  
patience.**

**Want to get more information,**

**Please click here, Go back to the page.**

**After your payment, you will have instant access to  
your download.**

**The Download Link will also be sent to your e-mail.**

**You will get the complete manual**

**Have any questions**

**please write to me**

**[admin@servicemanualperfect.com](mailto:admin@servicemanualperfect.com)**