

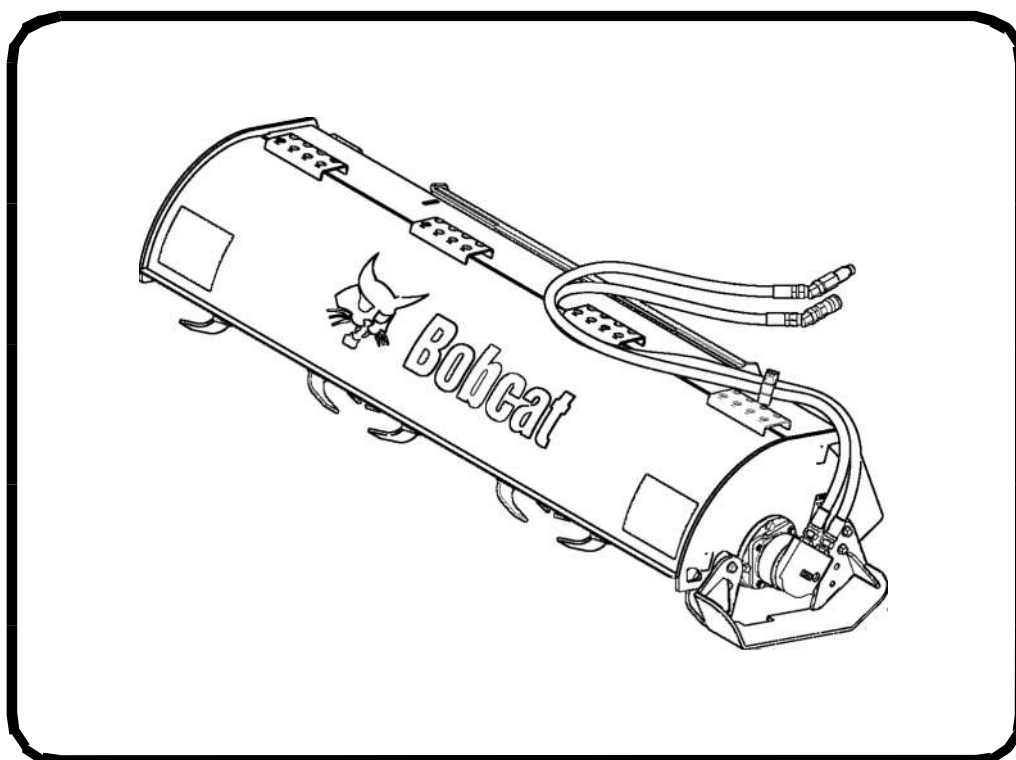

Service Manual

Tiller

(62 In.) S/N 055200855 & Below
(62 In.) S/N 055200856 & Above
(76 In.) S/N 055100947 & Below
(76 In.) S/N 055100948 & Above



MAINTENANCE SAFETY



WARNING

Instructions are necessary before operating or servicing machine. Read and understand the Operation & Maintenance Manual, Operator's Handbook and signs (decals) on machine. Follow warnings and instructions in the manuals when making repairs, adjustments or servicing. Check for correct function after adjustments, repairs or service. Untrained operators and failure to follow instructions can cause injury or death.

W-2003-0903











Safety Alert Symbol: This symbol with a warning statement, means: "Warning, be alert! Your safety is involved!" Carefully read the message that follows.

CORRECT



B-10731a

-  Never service attachments without instructions. See Operation & Maintenance Manual and Attachment Service Manual.
-  Cleaning and maintenance are required daily.
-  Never service or adjust attachment with the engine running unless instructed to do so in manual.
-  Always lower the attachment to the ground before lubricating or servicing.
-  Avoid contact with leaking hydraulic fluid or diesel fuel under pressure. It can penetrate skin or eyes.
-  Stop, cool and clean engine of flammable materials before checking fluids.
-  Keep body, loose objects and clothing away from moving parts, electrical contacts, hot parts and exhaust.
-  Safety glasses are needed for eye protection from electrical arcs, battery acid, compressed springs, fluids under pressure and flying debris or when tools are used. Use eye protection approved for type of welding.



Bobcat®

ALPHABETICAL INDEX

DAILY INSPECTION	10-20-1
DELIVERY REPORT	III
HYDRAULIC MOTOR (S/N 055200855 & BELOW, S/N 055100947 & BELOW)	20-10-1
HYDRAULIC MOTOR (S/N 055200856 & ABOVE, S/N 055100948 & ABOVE)	20-11-1
HYDRAULIC SCHEMATIC	SPECS-20-1
SERIAL NUMBER LOCATION	III
SPECIFICATIONS	SPECS-10-1
TINES	30-20-1
TINE SHAFT BEARING	30-10-1
TROUBLESHOOTING	10-10-1

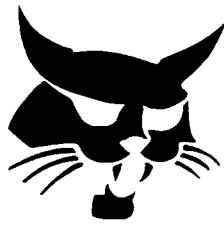

Bobcat®

CONTENTS

DELIVERY REPORT.....	III
IDENTIFICATION AND MACHINE SIGNS (DECALS)	IV
SERIAL NUMBER LOCATION	III
SAFETY & MAINTENANCE	10-01
HYDRAULIC SYSTEM	20-01
MAIN FRAME	30-01
SPECIFICATIONS AND SCHEMATICS	SPEC-01

**SAFETY &
MAINTENANCE**

**HYDRAULIC
SYSTEM**

**MAIN
FRAME**

**SPECIFICATIONS
AND
SCHEMATICS**

CALIFORNIA PROPOSITION 65 WARNING

Diesel engine exhaust and some of its constituents are known to the state of California to cause cancer, birth defects and other reproductive harm.



SERIAL NUMBER LOCATION

Figure 1

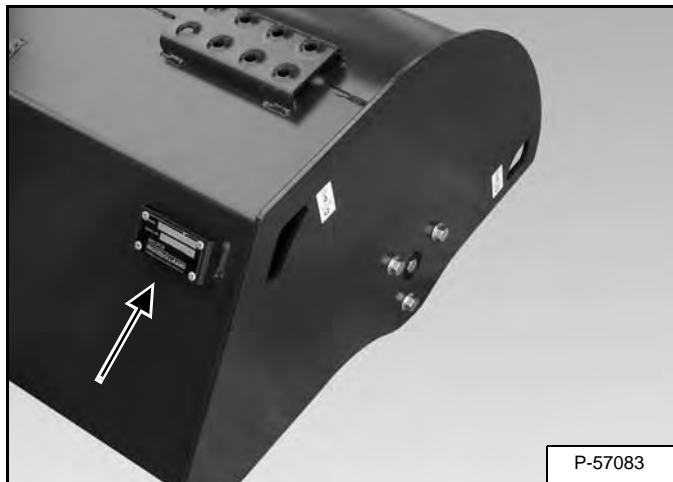

Always use the serial number of the tiller when requesting service information or when ordering parts. Early or later models (identification made by serial number) may use different parts, or it may be necessary to use a different procedure in doing a specific service operation **[Figure 1]**.

DELIVERY REPORT

Figure 2

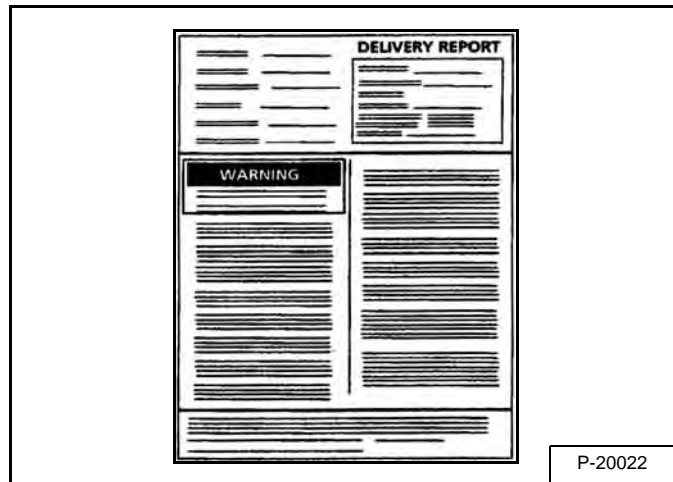

The delivery report must be filled out by the dealer and signed by the owner or operator when the tiller is delivered. An explanation of the form must be given to the owner. Make sure it is filled out completely **[Figure 2]**.

IDENTIFICATION AND MACHINE SIGNS (DECALS)

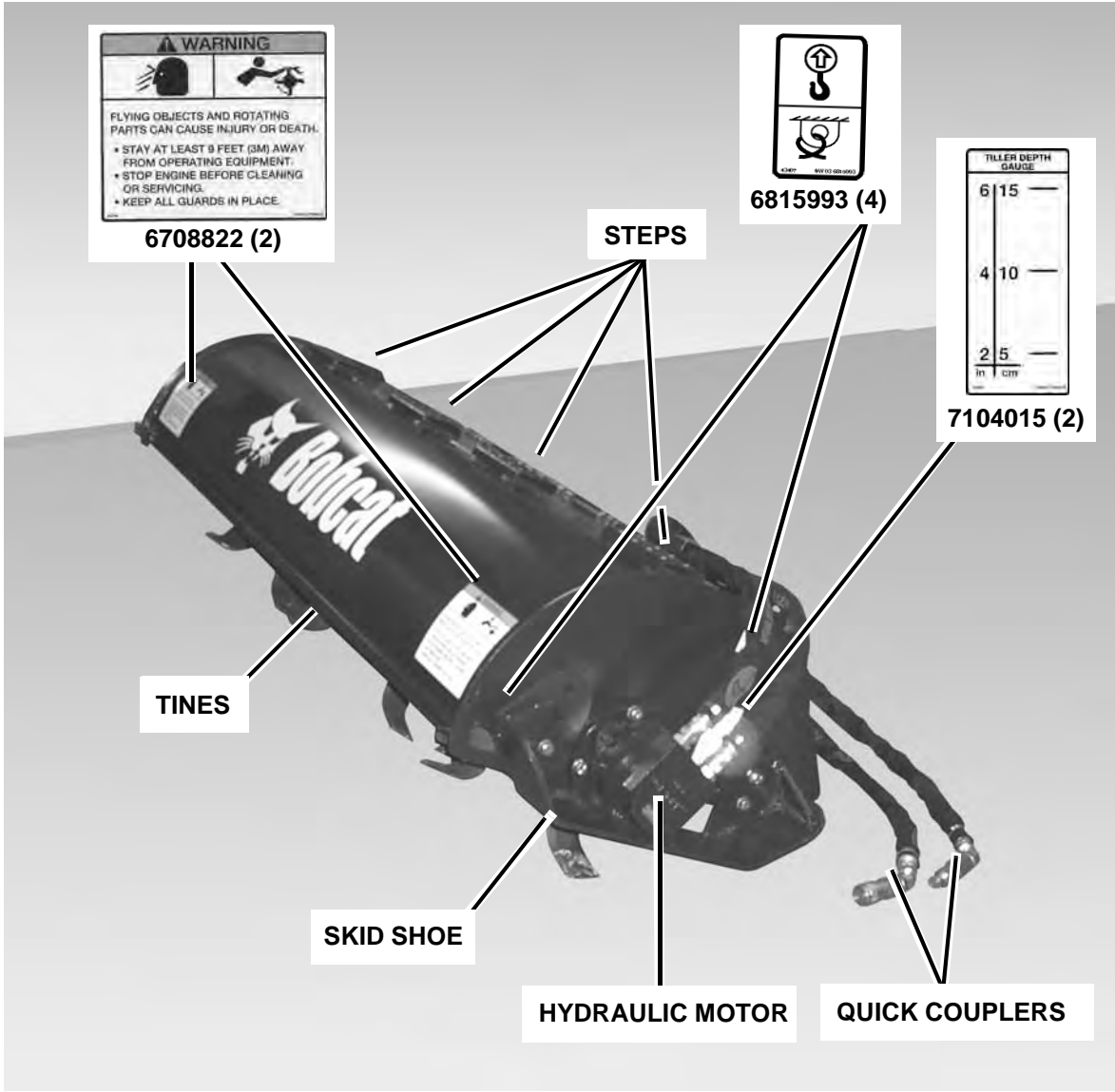

SAFETY & MAINTENANCE

DAILY INSPECTION 10-20-1

 Bob-Tach 10-20-1

 Attachment Mounting Frame 10-20-1

TRUBLESHOOTING 10-10-1



TROUBLESHOOTING

PROBLEM	CAUSE	CORRECTION
Tiller will not function.	Hydraulic hoses improperly connected.	Check the hydraulic quick couplers to make sure they are connected properly.
	Auxiliary Hydraulics not engaged.	Engage Auxiliary Hydraulics.
Tiller leaves an uneven finish (half smooth, half rough).	Tiller tines are either missing, or are worn.	Replace broken tines. Be sure all tines are present.
Tiller leaves a rough finish.	Tiller is being operated at low RPM's.	Increase loader RPM's.
	Tiller tines are either missing, or are worn.	Replace broken tines. Be sure all tines are present.
	Tiller is traveling too fast.	Decrease the rate of travel.
Tiller operation causes the loader to vibrate roughly.	Tiller is operating in the wrong direction.	Check to make sure tiller shaft is rotating in the opposite direction of travel.
	Tiller is traveling too fast.	Decrease the rate of travel.
	Loader arms not positioned in cradle.	Lower loader arms fully.



DAILY INSPECTION

Attachment Mounting Frame

Figure 10-20-1

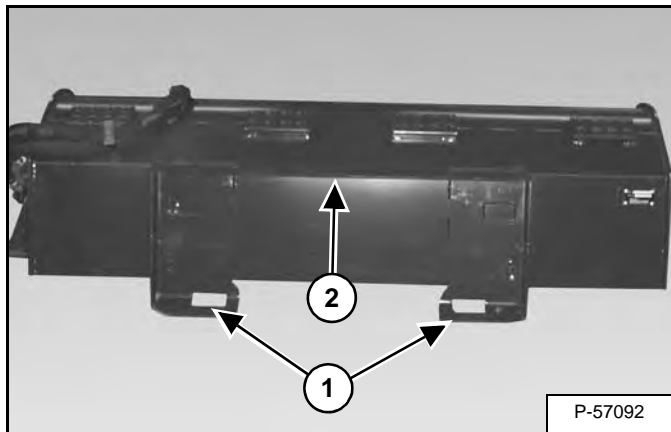

Inspect the Bob-Tach wedge mounts (Item 1), mounting flange (Item 2) [Figure 10-20-1] and all welds on the tiller for wear and damage each time the tiller is removed from the machine.

Bob-Tach

Hand Lever Bob-Tach



WARNING

Bob-Tach wedges must extend through the holes in attachment. Lever(s) must be fully down and locked. Failure to secure wedges can allow attachment to come off and cause injury or death.

W-2102-0497

Figure 10-20-2

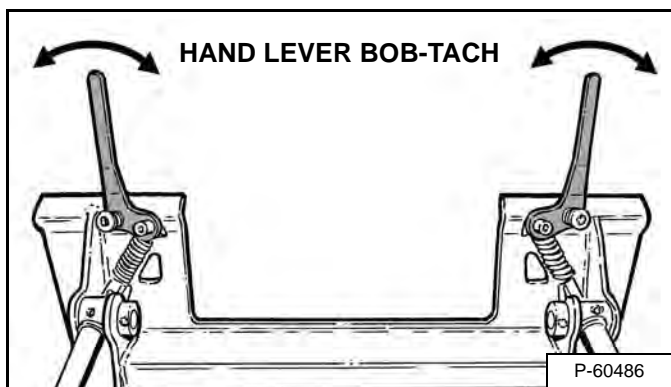

Move the Bob-Tach levers to engage and disengage the wedges [Figure 10-20-2]. The levers and wedges must move freely.

Figure 10-20-3

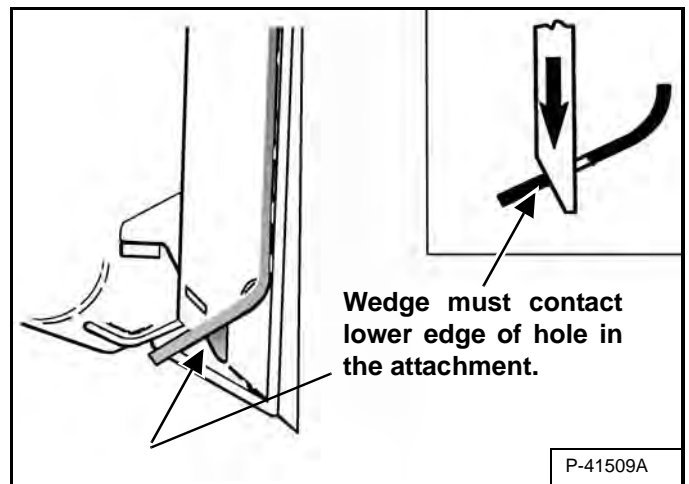

The wedges must extend through the holes in the attachment mounting frame [Figure 10-20-3].

If the wedge does not contact the lower edge of the hole [Figure 10-20-3], the attachment will be loose and can come off the Bob-Tach.

Figure 10-20-4

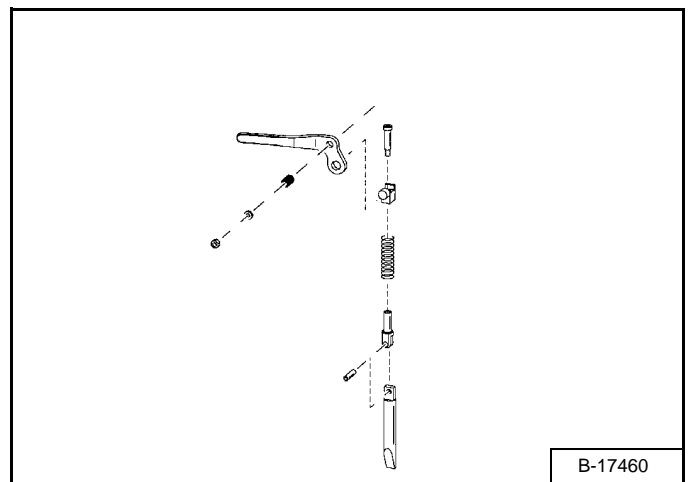

Inspect the mounting frame on the attachment and the Bob-Tach, linkages and wedges for excessive wear or damage [Figure 10-20-4]. Replace any parts that are damaged, bent or missing. Keep all fasteners tight.

Look for cracked welds. Contact your Bobcat dealer for repair or replacement parts.

Lubricate the wedges. (See the correct machine's Operation & Maintenance Manual for lubrication procedures.)

DAILY INSPECTION (CONT'D)

Bob-Tach (Cont'd)

Power Bob-Tach Option

! WARNING

Bob-Tach wedges must extend through the holes in attachment. Lever(s) must be fully down and locked. Failure to secure wedges can allow attachment to come off and cause injury or death.

W-2102-0497

Figure 10-20-5

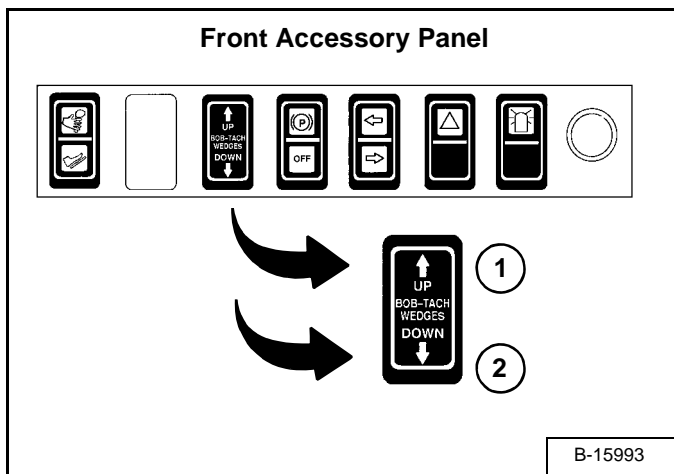
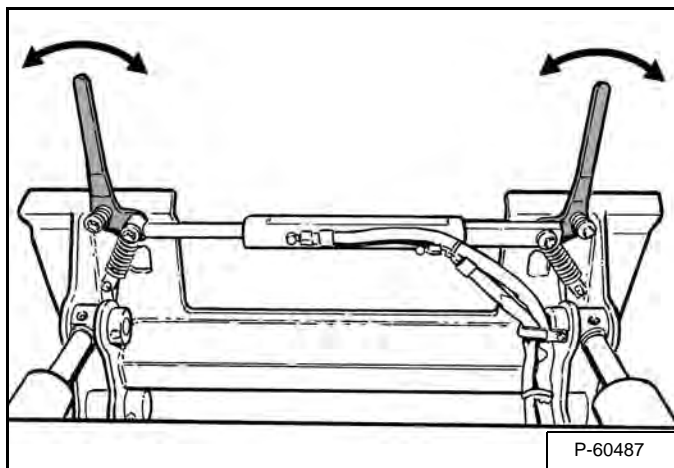

Figure 10-20-6



Push and hold the BOB-TACH WEDGES UP switch (Item 1) until the wedges are fully raised. Push and hold the BOB-TACH WEDGES DOWN switch (Item 2) [Figure 10-20-5] until the wedges are fully lowered.

The levers and wedges must move freely [Figure 10-20-6].

Figure 10-20-7

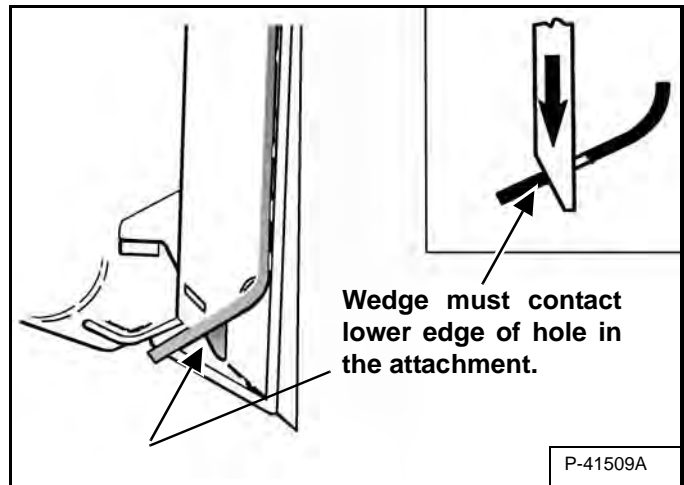

The wedges must extend through the holes in the attachment mounting frame [Figure 10-20-7].

If the wedge does not contact the lower edge of the hole [Figure 10-20-7], the attachment will be loose and can come off the Bob-Tach.

Figure 10-20-8

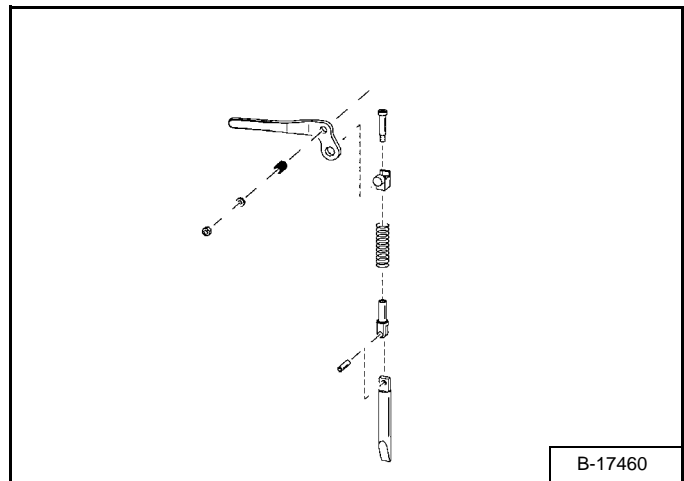

Inspect the mounting frame on the attachment and the Bob-Tach, linkages and wedges for excessive wear or damage [Figure 10-20-8]. Replace any parts that are damaged, bent or missing. Keep all fasteners tight.

Look for cracked welds. Contact your Bobcat dealer for repair or replacement parts.

Lubricate the wedges. (See the correct machine's Operation & Maintenance Manual for lubrication procedures.)

HYDRAULIC SYSTEM

HYDRAULIC SYSTEM

HYDRAULIC MOTOR (S/N 055200855 & BELOW, S/N 055100947 & BELOW)	20-10-1
Assembly	20-10-9
Disassembly	20-10-4
Inspection	20-10-8
Parts Identification	20-10-3
Removal and Installation	20-10-1
 HYDRAULIC MOTOR (S/N 055200856 & ABOVE, S/N 055100948 & ABOVE)	20-11-1
Assembly	20-11-5
Disassembly	20-11-3
Inspection	20-11-4
Parts Identification	20-11-2
Removal and Installation	20-11-1



Dear

**Thanks very much for your visiting and
patience.**

Want to get more information,

Please click here, Go back to the page.

**After your payment, you will have instant access to
your download.**

The Download Link will also be sent to your e-mail.

You will get the complete manual

Have any questions

please write to me

admin@servicemanualperfect.com