

**Seeder**

**72 Inch**



**Bobcat®**

# **Service Manual**

**(72 In) S/N 018000101 & Above**

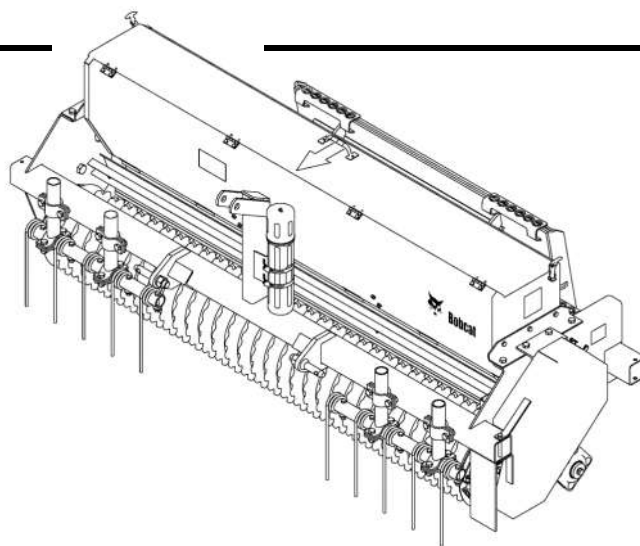



## CONTENTS

ATTACHMENT DELIVERY REPORT .....	III
IDENTIFICATION AND MACHINE SIGNS (DECALS) .....	IV
SERIAL NUMBER LOCATION .....	III
SAFETY AND MAINTENANCE.....	10-01
MAIN FRAME .....	20-01
SPECIFICATIONS.....	SPEC-01

**SAFETY AND  
MAINTENANCE**

**MAIN  
FRAME**

**SPECIFICATIONS  
AND  
SCHEMATICS**



**Bobcat®**

## SERIAL NUMBER LOCATION

Figure 1

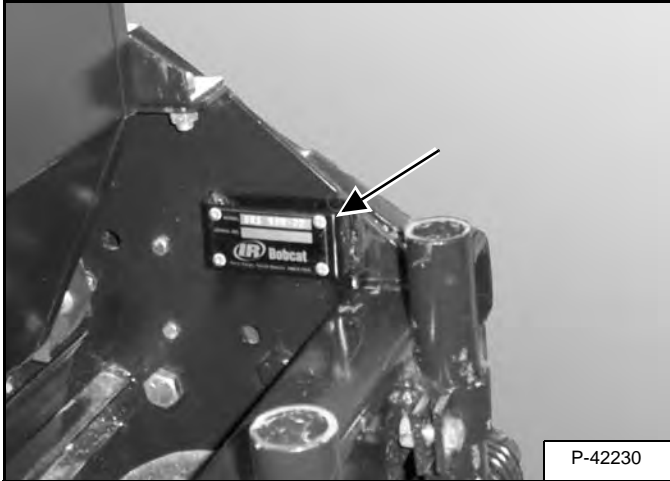

Always use the serial number of the Seeder when requesting service information or when ordering parts. Early or later models (identification made by serial number) may use different parts, or it may be necessary to use a different procedure in doing a specific service operation [Figure 1].

## ATTACHMENT DELIVERY REPORT

Figure 2

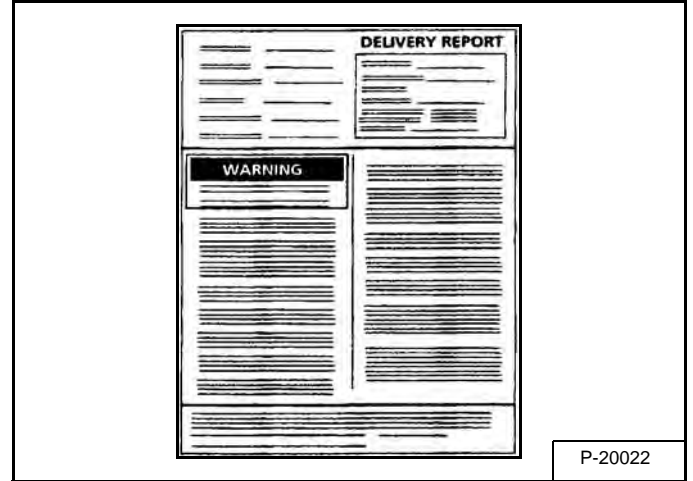

The Attachment Delivery Report must be filled out by the dealer and signed by the owner or operator when the Seeder is delivered. An explanation of the form must be given to the owner. Make sure it is filled out completely [Figure 2].

# IDENTIFICATION AND MACHINE SIGNS (DECALS)

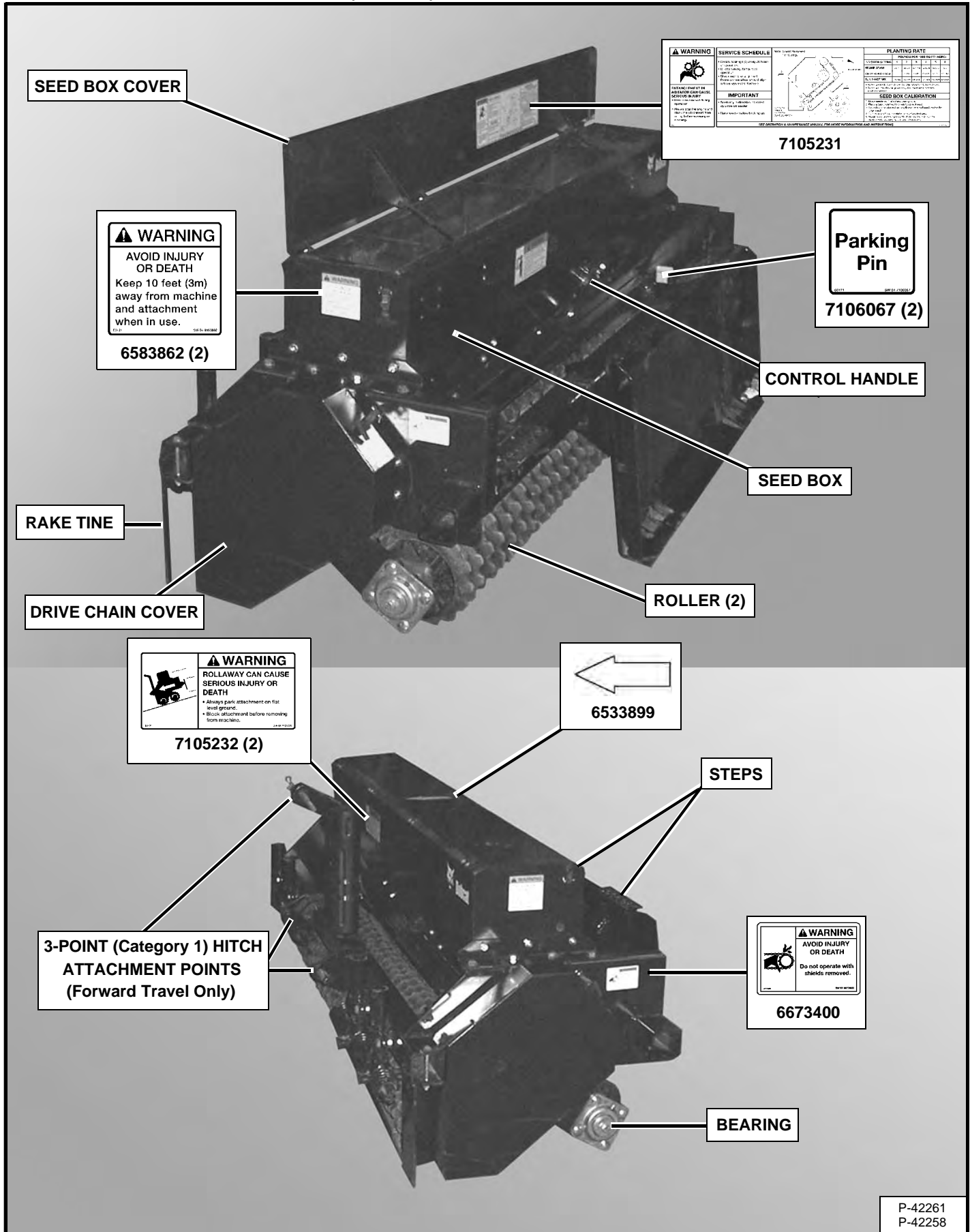

P-42261  
 P-42258

## SAFETY AND MAINTENANCE

## SAFETY AND MAINTENANCE

DRIVE CHAIN .....	10-30-1
Adjusting Chain Tension .....	10-30-1
Procedure .....	10-30-1
INSPECTION .....	10-20-1
Hand Lever Bob-Tach Inspection .....	10-20-1
Power Bob-Tach Inspection .....	10-20-2
Seeder Inspection .....	10-20-3
RAKE TINES .....	10-50-1
Removal And Installation .....	10-50-1
ROLLER ALIGNMENT .....	10-60-1
Adjusting Rollers .....	10-60-1
LUBRICATION .....	10-40-1
TROUBLESHOOTING .....	10-10-1



**Bobcat®**



## TROUBLESHOOTING

<b>PROBLEM</b>	<b>CAUSE</b>	<b>CORRECTION</b>
Planting rate is too heavy or not heavy enough.	Seeder not calibrated to seed type.	Calibrate seeder.
	26 tooth sprocket installed. (This doubles rate.)	Install 13 tooth sprocket.
No seed dropping from seeder.	Front roller not turning.	Seeder not contacting the ground.
		Tines are contacting the drum.
	Seed box agitator not turning.	Broken chain or sprocket roll pin.
Seeder difficult to attach with 3-point hitch.	Parking pins not engaged.	Engage parking pins.



**Bobcat®**

## INSPECTION

### Hand Lever Bob-Tach Inspection



Bob-Tach wedges must extend through the holes in attachment. Lever(s) must be fully down and locked. Failure to secure wedges can allow attachment to come off and cause injury or death.

W-2102-0497

Figure 10-20-1

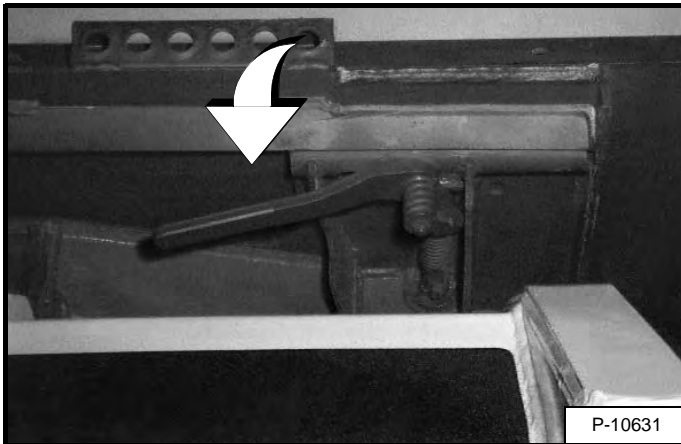

Move the Bob-Tach levers down to engage the wedges [Figure 10-20-1].

The levers and wedges must move freely.

Figure 10-20-2

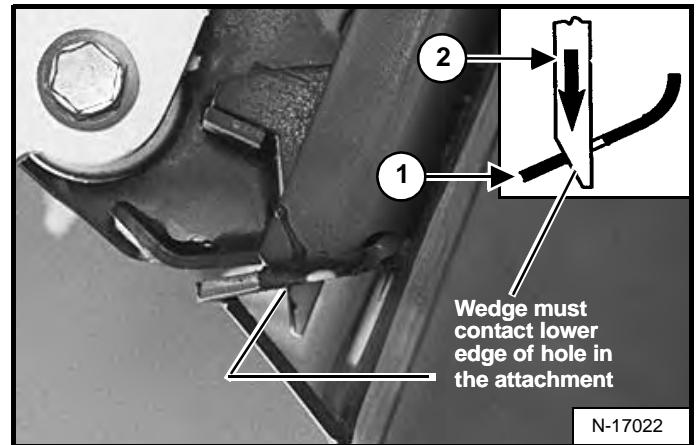

The wedges must extend through the holes in the attachment mounting frame (Item 1) [Figure 10-20-2].

The spring loaded wedge (Item 2) must contact the lower edge of the hole in the attachment (Item 1) [Figure 10-20-2].

If the wedge does not contact the lower edge of the hole the attachment will be loose and can come off the Bob-Tach.

Figure 10-20-3

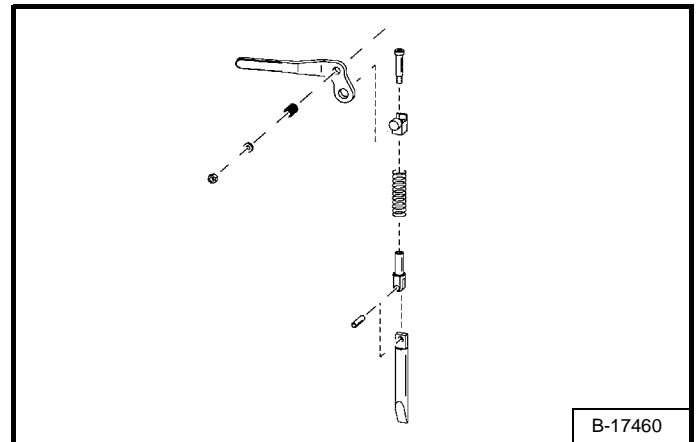

Inspect the mounting frame on the attachment and the Bob-Tach, linkages and wedges for excessive wear or damage. Replace any parts that are damaged, bent, or missing [Figure 10-20-3].

Keep all fasteners tight.

Look for cracked welds. Contact your Bobcat dealer for repair or replacement parts.

Lubricate the wedges. (See the correct Loader Operation & Maintenance Manual for *LUBRICATION OF THE BOBCAT MACHINE.*)

## INSPECTION (CONT'D)

### Power Bob-Tach Inspection

# ! WARNING

Bob-Tach wedges must extend through the holes in attachment. Lever(s) must be fully down and locked. Failure to secure wedges can allow attachment to come off and cause injury or death.

W-2102-0497

Figure 10-20-4

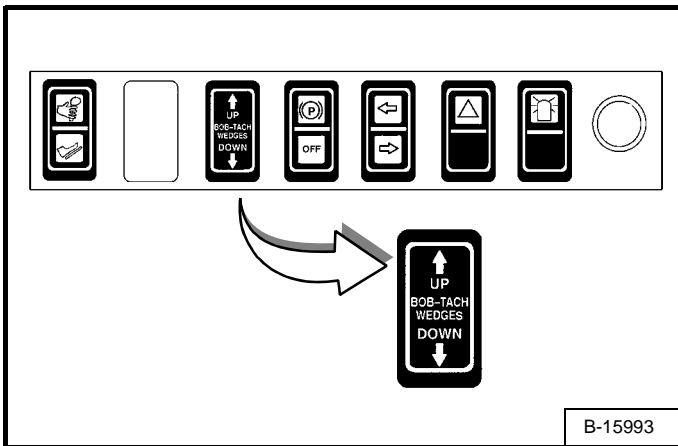

B-15993

Push and hold the *BOB-TACH WEDGES UP* switch until wedges are fully raised. Push and hold the *BOB-TACH WEDGES DOWN* switch until the wedges are fully down [Figure 10-20-4].

The wedges must move freely.

**NOTE:** The Power Bob-Tach system has continuous pressurized oil to keep the wedges in the engaged position and prevent attachment disengagement. Because the wedges can slowly lower, the operator may need to reactivate the switch (*WEDGES UP*) before installing an attachment to be sure both wedges are fully raised before installing the attachment.

Figure 10-20-5

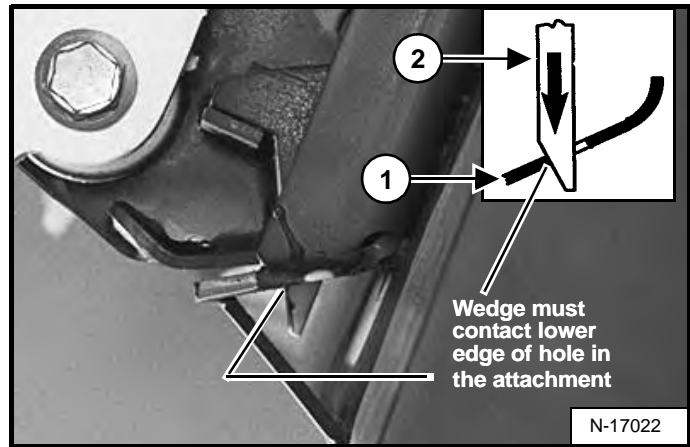

The wedges must extend through the holes in the attachment mounting frame (Item 1) [Figure 10-20-5].

The spring loaded wedge (Item 2) must contact the lower edge of the hole in the attachment (Item 1) [Figure 10-20-5].

If the wedge does not contact the lower edge of the hole [Figure 10-20-5] the attachment will be loose and can come off the Bob-Tach.

Figure 10-20-6

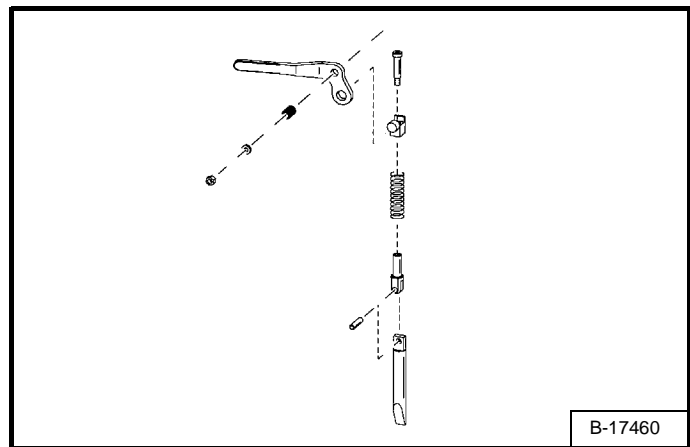

Inspect the mounting frame on the attachment and the Bob-Tach, linkages and wedges for excessive wear or damage [Figure 10-20-6].

Replace any parts that are damaged, bent, or missing. Keep all fasteners tight. Inspect the hoses and fittings for leaks.

Look for cracked welds. Contact your Bobcat dealer for repair or replacement parts.

Lubricate the wedges. (See the correct loader Operation & Maintenance Manual for *LUBRICATION OF THE BOBCAT LOADER*.)

## INSPECTION (CONT'D)

### Seeder Inspection

Figure 10-20-7

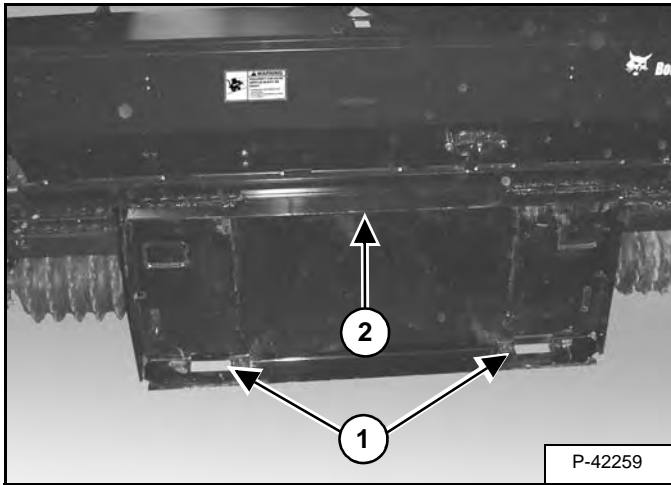

Inspect the Bob-Tach wedge mounts (Item 1), mounting flange (Item 2) and all welds on the seeder for wear and damage each time the seeder is removed from the loader/utility work machine [Figure 10-20-7].

Figure 10-20-8

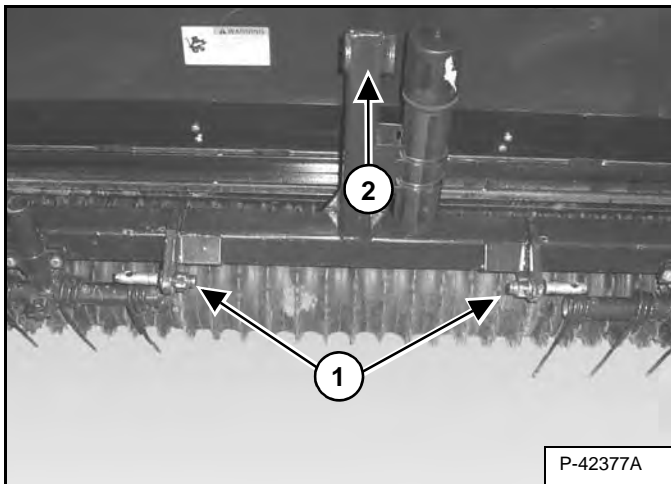

Inspect the upper 3-point mount (Item 1), lower 3-point mounts (Item 2) and all welds on the seeder for wear and damage each time the seeder is removed from the tractor/machine [Figure 10-20-8].

Figure 10-20-9

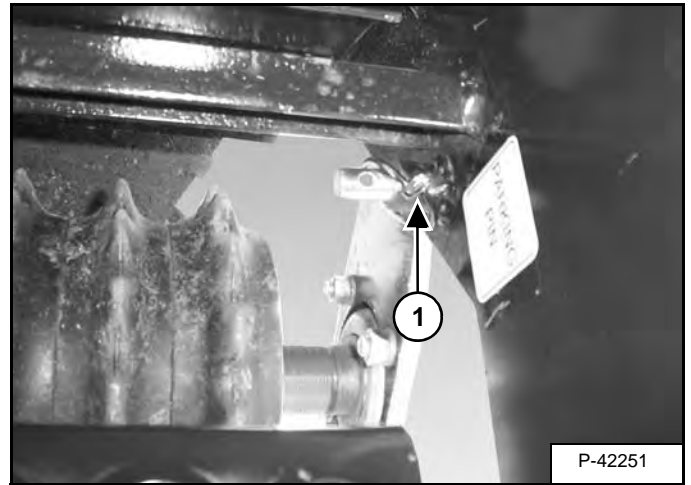

Inspect the parking pin mount welds (Item 1) [Figure 10-20-9] on both sides of the seeder for wear and damage each time the seeder is removed from the machine.



**Bobcat®**

## DRIVE CHAIN

### Adjusting Chain Tension

Figure 10-30-1

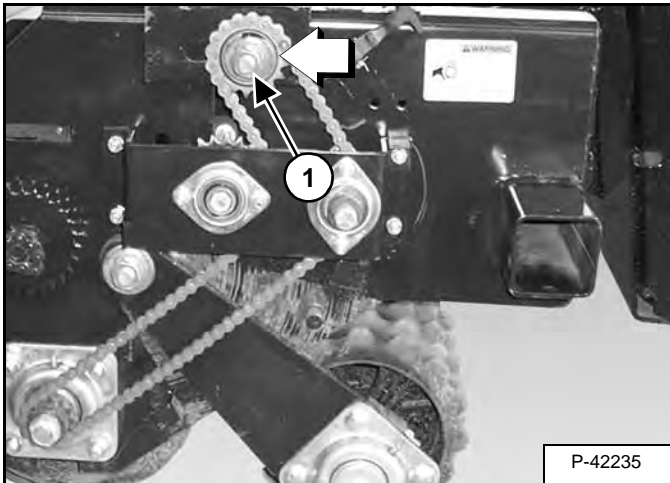

**NOTE:** Drive chain cover shown open for picture clarity.

Loosen the nut (Item 1) [Figure 10-30-1], then move the sprocket to the left to increase chain tension.

## Procedure

Figure 10-30-2

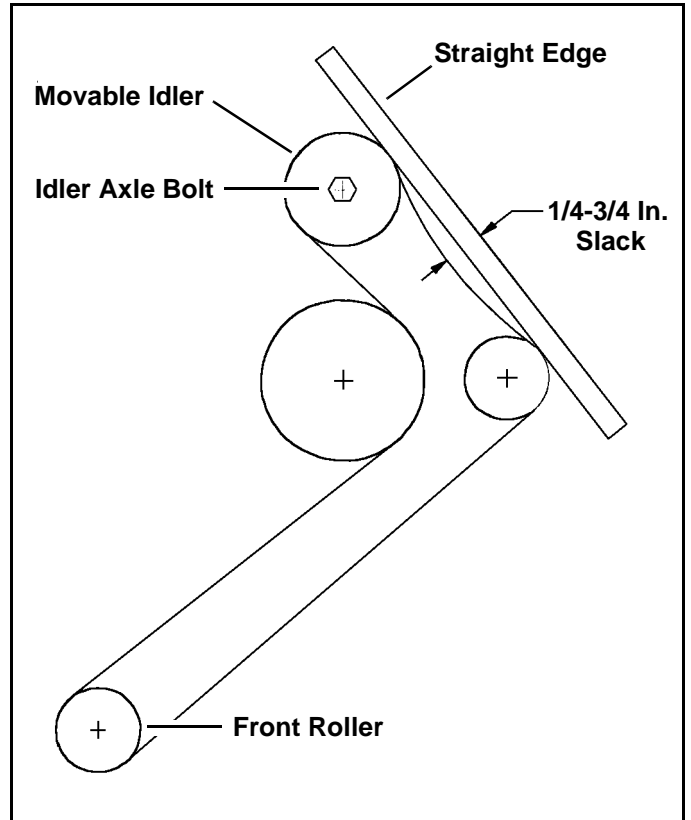

1. Loosen the 5/8" idler axle bolt.
2. Place a straight edge along the edges of the idler sprocket and the upper 13-tooth sprocket.
3. Use the bolt to obtain about 1/4"-3/4" of slack in the chain.
4. Re-tighten idler bolt. Tighten bolt to 125-140 ft.-lb. (170-190 N•m) torque.

**NOTE:** Be careful not to over tighten the chain.



**Bobcat®**



## LUBRICATION

Always use a good quality Lithium base grease when lubricating the seeder. Apply the lubricant until extra grease shows.

Grease the bearings every 20 hours;

**Figure 10-40-1**

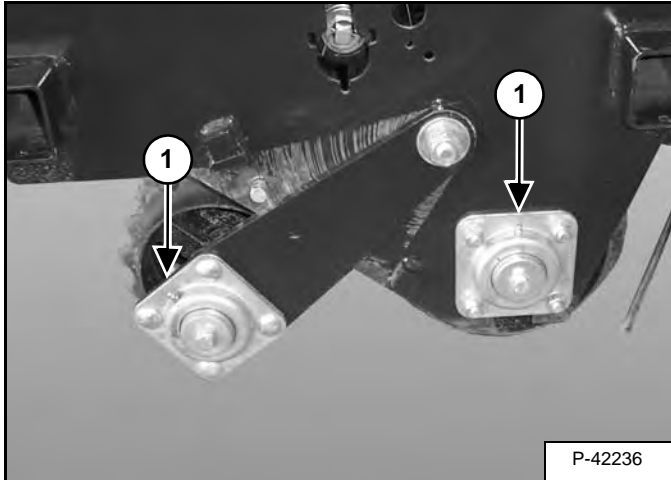

Apply grease to the bearing fittings (Item 1) [Figure 10-40-1].

**Figure 10-40-2**

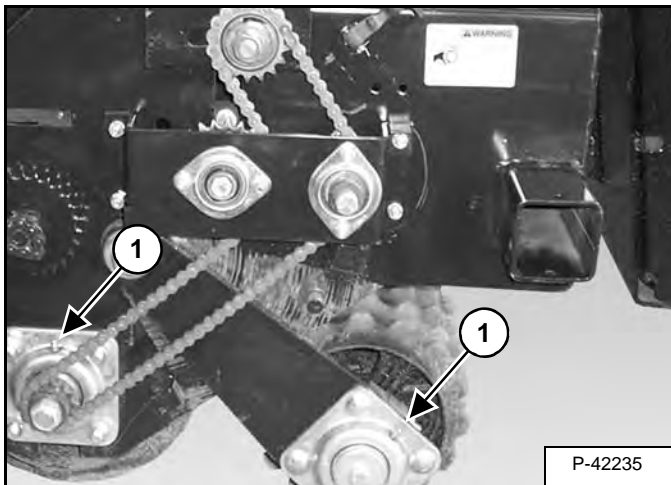

Apply grease to the bearing fittings (Item 1) [Figure 10-40-2].

**Figure 10-40-3**

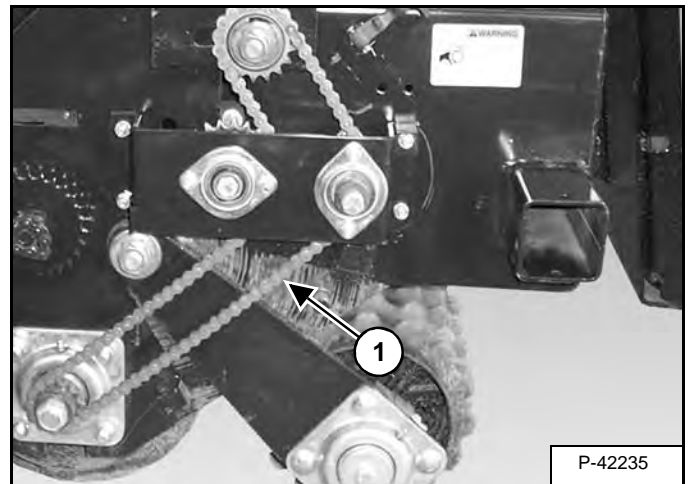

Oil chain (Item 1) [Figure 10-40-3] every 20 hours of operation.



**Bobcat®**

**Dear**

**Thanks very much for your visiting and  
patience.**

**Want to get more information,**

**Please click here, Go back to the page.**

**After your payment, you will have instant access to  
your download.**

**The Download Link will also be sent to your e-mail.**

**You will get the complete manual**

**Have any questions**

**please write to me**

**[admin@servicemanualperfect.com](mailto:admin@servicemanualperfect.com)**