

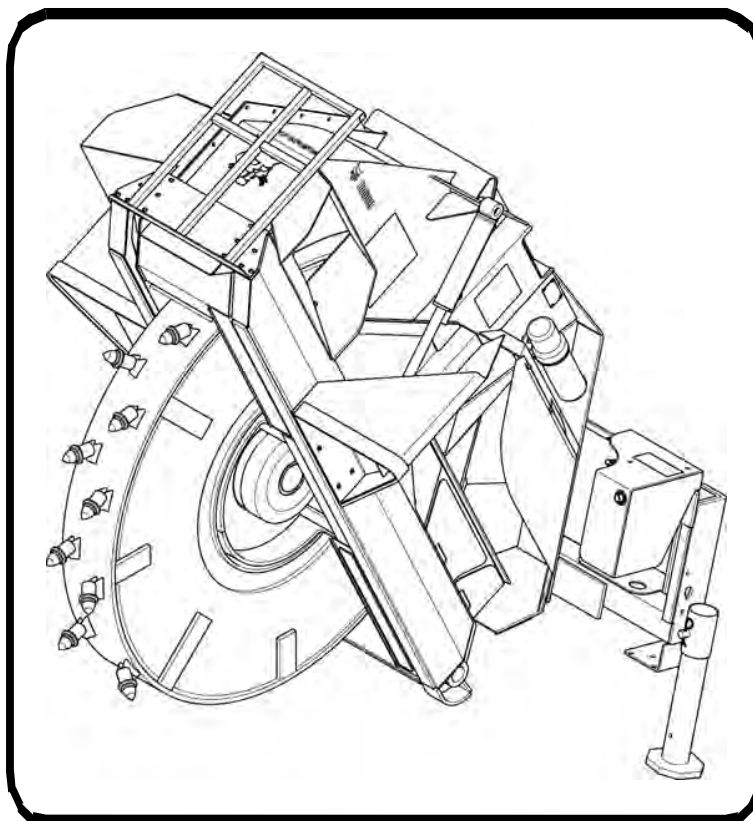

Service Manual

Wheel Saw

(WS32) S/N AR2K00101 & Above



MAINTENANCE SAFETY



WARNING

Instructions are necessary before operating or servicing machine. Read and understand the Operation & Maintenance Manual, Operator's Handbook and signs (decals) on machine. Follow warnings and instructions in the manuals when making repairs, adjustments or servicing. Check for correct function after adjustments, repairs or service. Untrained operators and failure to follow instructions can cause injury or death.

W-2003-0807







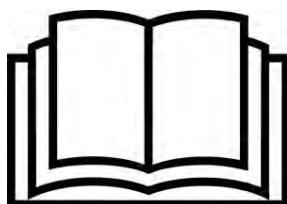



Safety Alert Symbol: This symbol with a warning statement, means: "Warning, be alert! Your safety is involved!" Carefully read the message that follows.

CORRECT



P-90216

-  Never service attachments / implements without instructions. See Operation & Maintenance Manual and Attachment / Implement Service Manual.
-  Cleaning and maintenance are required daily.
-  Never service or adjust attachment / implement with the engine running unless instructed to do so in manual.
-  Always lower the attachment / implement to the ground before lubricating or servicing.
-  Avoid contact with leaking hydraulic fluid or diesel fuel under pressure. It can penetrate skin or eyes.
-  Stop, cool and clean engine of flammable materials before checking fluids.
-  Keep body, loose objects and clothing away from moving parts, electrical contacts, hot parts and exhaust.
-  Safety glasses are needed for eye protection from electrical arcs, battery acid, compressed springs, fluids under pressure and flying debris or when tools are used. Use eye protection approved for type of welding.

Dealer Copy -- Not for Resale

MSW30-0409

**Thanks very much for your reading,
Want to get more information,
Please click here, Then get the complete
manual**

JustClickHere 

NOTE:

**If there is no response to click on the link above,
please download the PDF document first, and then
click on it.**

**Have any questions please write to me:
admin@servicemanualperfect.com**



CONTENTS

SAFETY & MAINTENANCE	10-01
HYDRAULIC SYSTEM	20-01
HYDROSTATIC SYSTEM	30-01
SPECIFICATIONS	SPEC-01
ALPHABETICAL INDEX	INDEX-01



FOREWORD

SERIAL NUMBER LOCATION 1-7

Attachment Serial Number 1-7

ATTACHMENT DELIVERY REPORT 1-7

MANUAL STORAGE LOCATION 1-7

IDENTIFICATION AND ATTACHMENT SIGNS (DECALS) 1-8

Dealer Copy -- Not for Resale



SERIAL NUMBER LOCATION

Always use the serial number (Item 1) [Figure 1] and [Figure 2] of the wheel saw when requesting service information or when ordering parts. Early or later models (identification made by serial number) may use different parts, or it may be necessary to use a different procedure in doing a specific service operation.

Attachment Serial Number

Figure 1

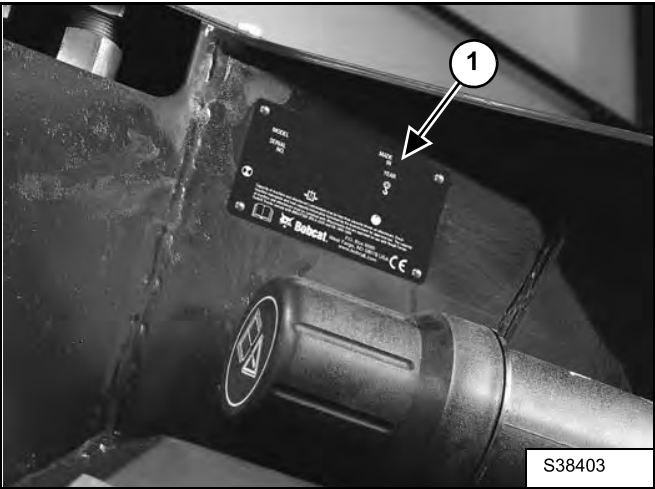

Figure 2



The serial number plate (Item 1) [Figure 1] and [Figure 2] is located on the left side of the wheel saw.

ATTACHMENT DELIVERY REPORT

Figure 3

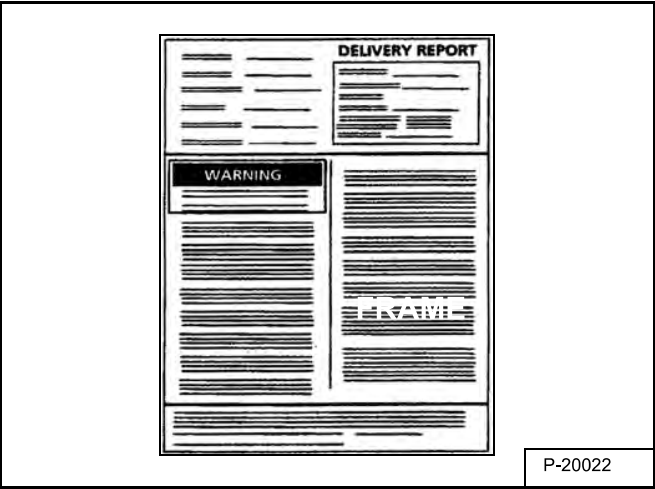

The Attachment Delivery Report must be completed by the dealer and signed by the owner or operator when the wheel saw is delivered. An explanation of the form must be given to the owner. Make sure it is complete [Figure 3].

MANUAL STORAGE LOCATION

Figure 4

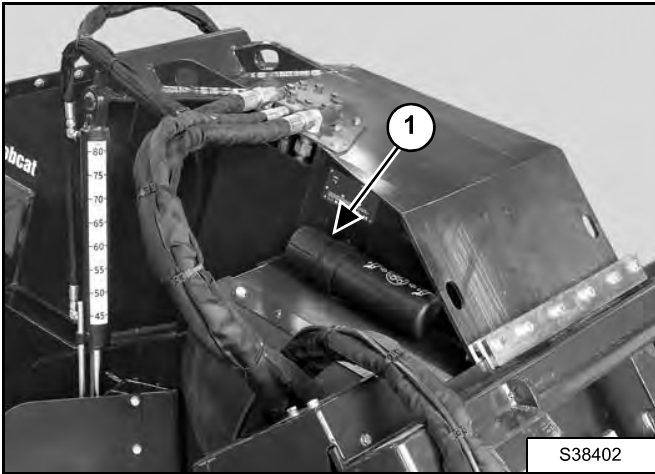

The manual storage container (Item 1) [Figure 4] is located on the left side of the wheel saw.

Dealer Copy -- Not for Resale

IDENTIFICATION AND ATTACHMENT SIGNS (DECALS)

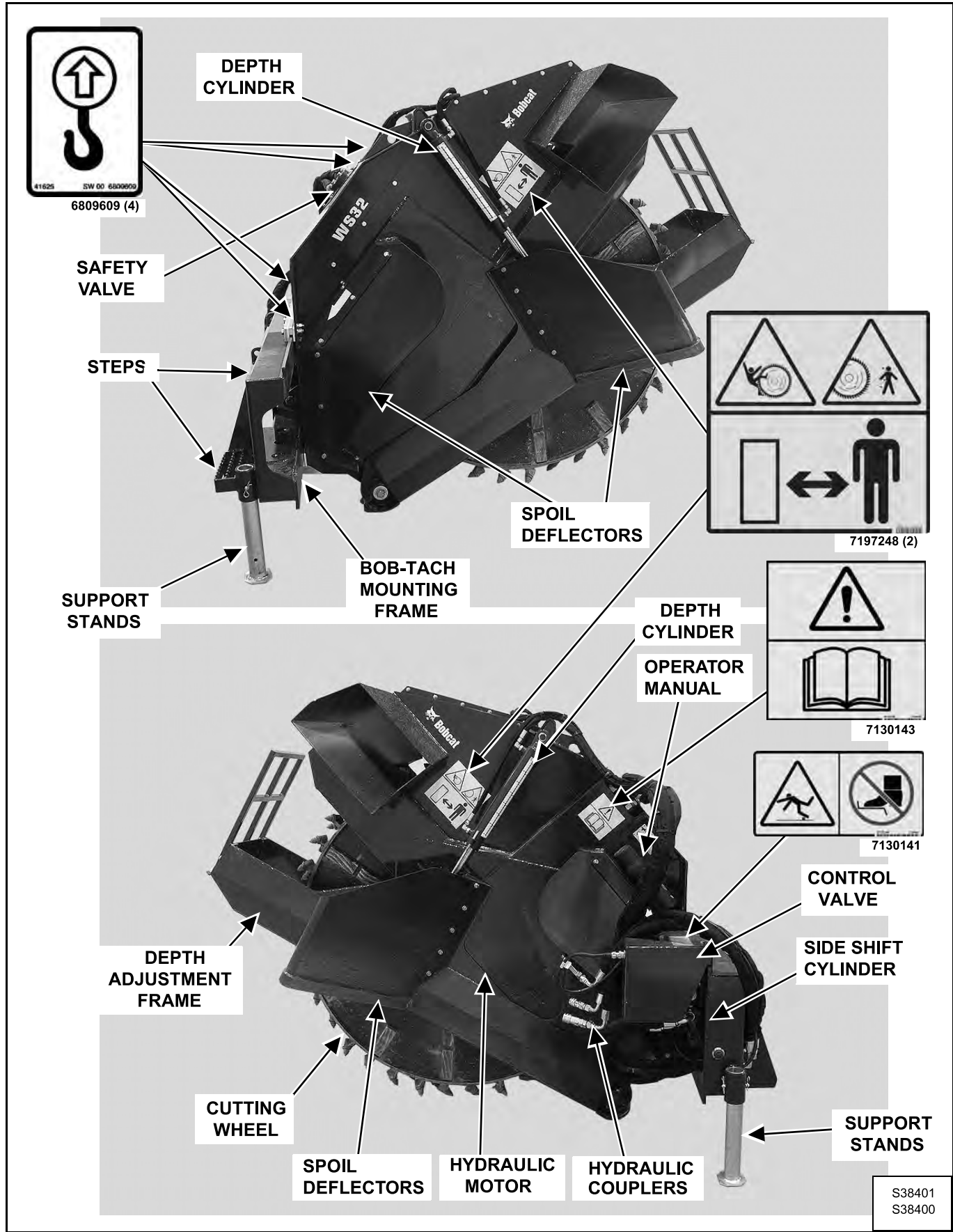

Dealer Copy -- Not for Resale

SAFETY & MAINTENANCE

TROUBLESHOOTING	10-10-1
Chart	10-10-1
DAILY INSPECTION	10-20-1
Attachment Mounting Frame	10-20-1
Bob-Tach	10-20-2
SERVICE SCHEDULE	10-30-1
Description	10-30-1
REGULAR MAINTENANCE ITEMS	10-40-1
Tool Bit Inspection And Replacement	10-40-1
REGULAR MAINTENANCE ITEMS	10-40-2
Hardening The Wheel And Carbide Holders	10-40-3
Wear Plates Inspection And Replacement	10-40-3
Spoil Deflector Inspection And Replacement	10-40-4
Safety Cap Checking And Replacement	10-40-5



TROUBLESHOOTING



AVOID INJURY OR DEATH

Instructions are necessary before operating or servicing machine. Read and understand the Operation & Maintenance Manual, Operator's Handbook and signs (decals) on machine. Follow warnings and instructions in the manuals when making repairs, adjustments or servicing. Check for correct function after adjustments, repairs or service. Untrained operators and failure to follow instructions can cause injury or death.

W-2003-0807

If the wheel saw is not working correctly, check the hydraulic system of the loader thoroughly before making any repairs on the wheel saw. Wheel saw problems can be affected by a hydraulic system that is not operating to specifications.

If the loader operation is found to be correct, use the following troubleshooting chart to locate and correct problems with the wheel saw.

Chart

PROBLEM	CAUSE	CORRECTION
Wheel saw will not rotate.	Auxiliary hydraulics not activated.	Activate auxiliary hydraulics.
	Hydraulic couplers not fully connected.	Check hydraulic connections.
	Wheel saw bits are contacting the ground when start-up is attempted.	Raise the wheel saw off ground before engaging auxiliary hydraulics.
	Electrical solenoids on wheel saw disconnected or defective.	Check all electrical connections. Repair and/or replace solenoids.
	Control Valve on wheel saw damaged or defective.	Repair and/or replace control valve.
Wheel saw loses power.	Travel speed is too fast.	Move loader at a slower rate.
	Loss of hydraulic flow.	Make sure High Flow hydraulics are activated.
	Loader relief valve not set to specification.	Check loader relief valve setting.
	Hydraulic pump flow insufficient.	Check hydraulic pump flow.
Wheel saw will not side shift.	Debris obstructing side shift function.	Check area around side shift cylinder for any obstructions.
	Electrical solenoids on wheel saw disconnected or defective.	Check all electrical connections. Repair and/or replace solenoids.
	Control Valve on wheel saw damaged or defective.	Repair and/or replace control valve.
	Bolts on side shift carriage are overtightened.	Torque bolts to specification, then back-off a quarter turn.
Wheel saw depth frame will not lower or raise.	Debris obstructing depth frame movement.	Clean all areas around depth frame.
	Electrical solenoids on wheel saw disconnected or defective.	Check all electrical connections. Repair and/or replace solenoids.
Tool bits wear unevenly.	Bits are not rotating in their housings.	(See Tool Bit Inspection And Replacement on Page 10-40-1.)
Wheel saw vibrates.	Wheel saw frame not positioned firmly on work surface.	The wheel saw frame should be fully on the work surface.
	Not enough loader weight on the wheel saw.	Raise loader front wheels slightly off of the ground to add additional weight.
Wheel saw jams.	Too much material feeded into the wheel saw.	Turn off the wheel saw. Back off (move forward). Turn on the wheel saw and proceed with the cut at a lower travel speed.

Dealer Copy -- Not for Resale



DAILY INSPECTION

Attachment Mounting Frame

Figure 10-20-1

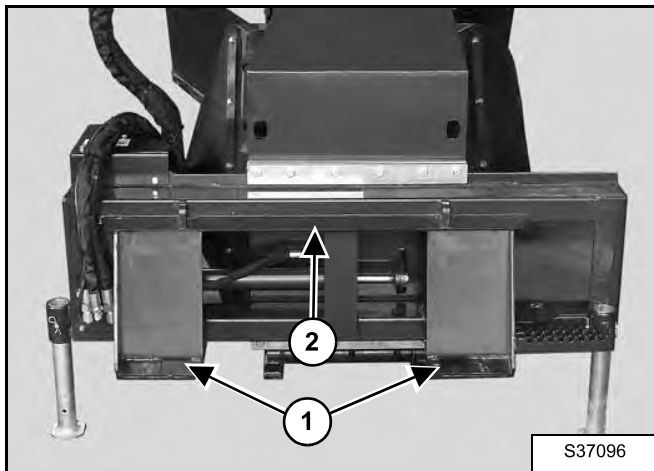

Inspect the Bob-Tach wedge mounts (Item 1), mounting flanges (Item 2) [Figure 10-20-1] and all welds on the attachment mounting frame for wear or damage each time the attachment is removed from the machine.

Check the following items every hour of operation:

- The integrity of the tool bits.
- The integrity of the cutting wheel.

DAILY INSPECTION (CONT'D)

Bob-Tach

Hand Lever Bob-Tach

**WARNING**

AVOID INJURY OR DEATH

The Bob-Tach wedges must extend through the holes in the attachment mounting frame. Levers must be fully down and locked. Failure to secure wedges can allow attachment to come off.

W-2715-0208

Figure 10-20-2

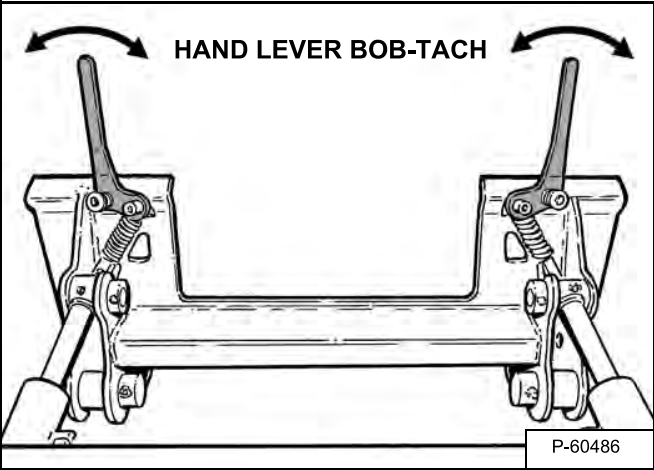

Move the Bob-Tach levers to engage and disengage the wedges [Figure 10-20-2]. The levers and wedges must move freely.

Figure 10-20-3

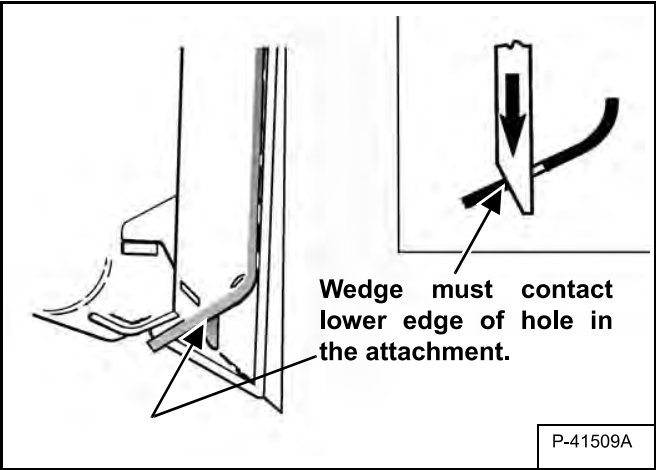

The wedges must extend through the holes in the attachment mounting frame [Figure 10-20-3].

If the wedge does not contact the lower edge of the hole [Figure 10-20-3], the attachment will be loose and can come off the Bob-Tach.

Figure 10-20-4

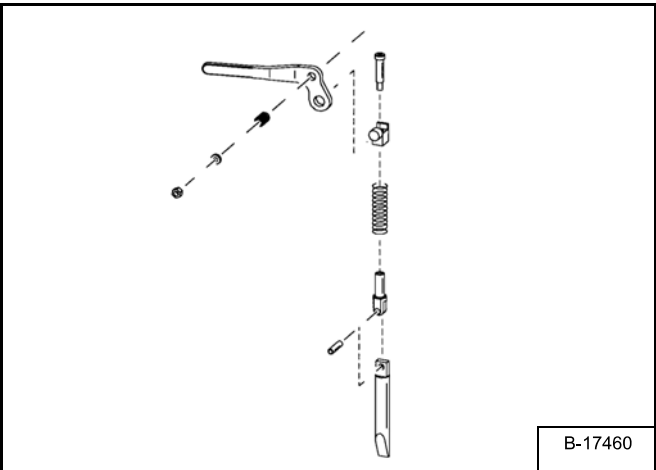

Inspect the mounting frame on the attachment and the Bob-Tach, linkages and wedges for excessive wear or damage [Figure 10-20-4]. Replace any parts that are damaged, bent or missing. Keep all fasteners tight.

Look for cracked welds.

Lubricate the wedges. (See the machine's Operation & Maintenance Manual for correct lubrication procedures.)

Dealer Copy -- Not for Resale

DAILY INSPECTION (CONT'D)

Bob-Tach (Cont'd)

Power Bob-Tach

! WARNING

AVOID INJURY OR DEATH

The Bob-Tach wedges must extend through the holes in the attachment mounting frame. Levers must be fully down and locked. Failure to secure wedges can allow attachment to come off.

W-2715-0208

Figure 10-20-5

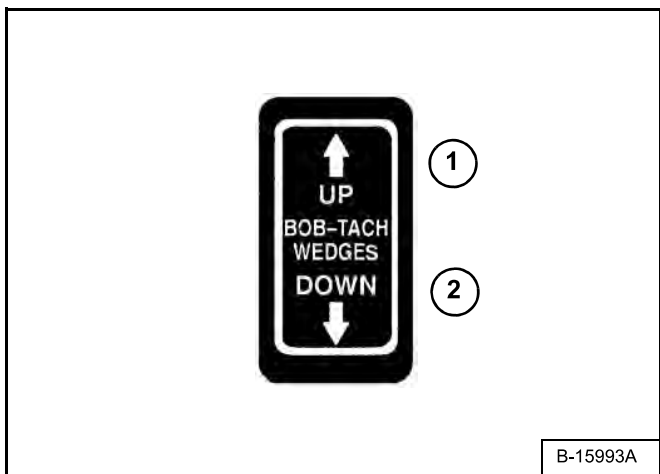
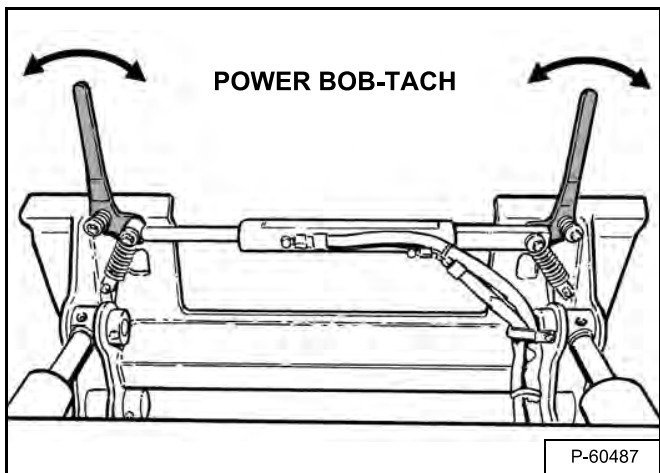

Figure 10-20-6



Push and hold the BOB-TACH WEDGES UP switch (Item 1) until the wedges are fully raised. Push and hold the BOB-TACH WEDGES DOWN switch (Item 2) [Figure 10-20-5] until the wedges are fully lowered.

The levers and wedges must move freely [Figure 10-20-6].

Figure 10-20-7

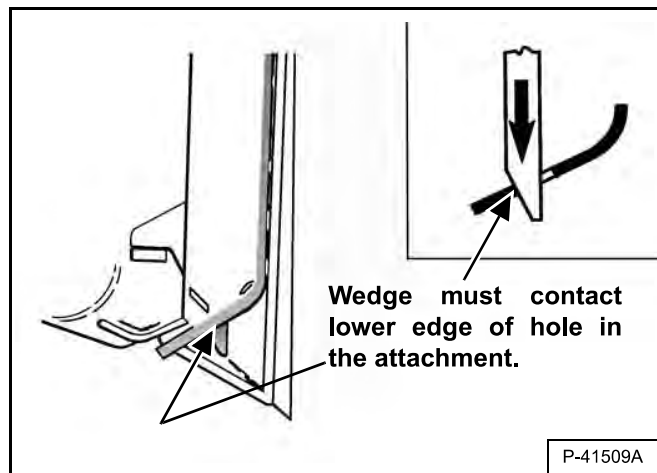

The wedges must extend through the holes in the attachment mounting frame [Figure 10-20-7].

If the wedge does not contact the lower edge of the hole [Figure 10-20-7], the attachment will be loose and can come off the Bob-Tach.

Figure 10-20-8

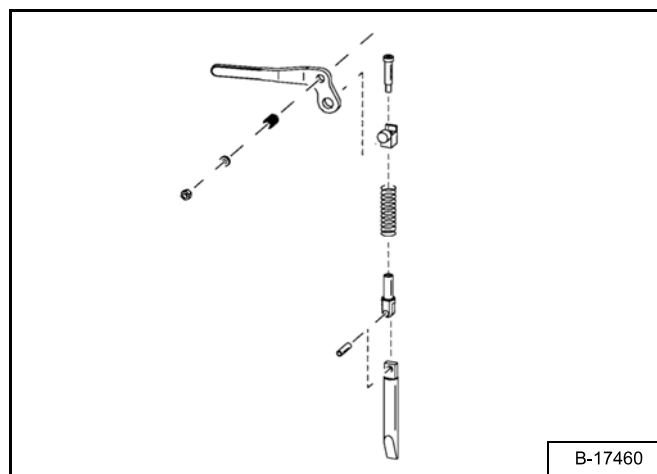

Inspect the mounting frame on the attachment and the Bob-Tach, linkages and wedges for excessive wear or damage [Figure 10-20-8]. Replace any parts that are damaged, bent or missing. Keep all fasteners tight.

Look for cracked welds.

Lubricate the wedges. (See the machine's Operation & Maintenance Manual for correct lubrication procedures.)

