

# BOBCAT CHIPPER



**Bobcat®**

# Service Manual

**WC-5A (S/N 912900101 & Above)**

**WC-8A (S/N 739500101 & Above)**

**WC-8B (S/N A02B00101 & Above)**

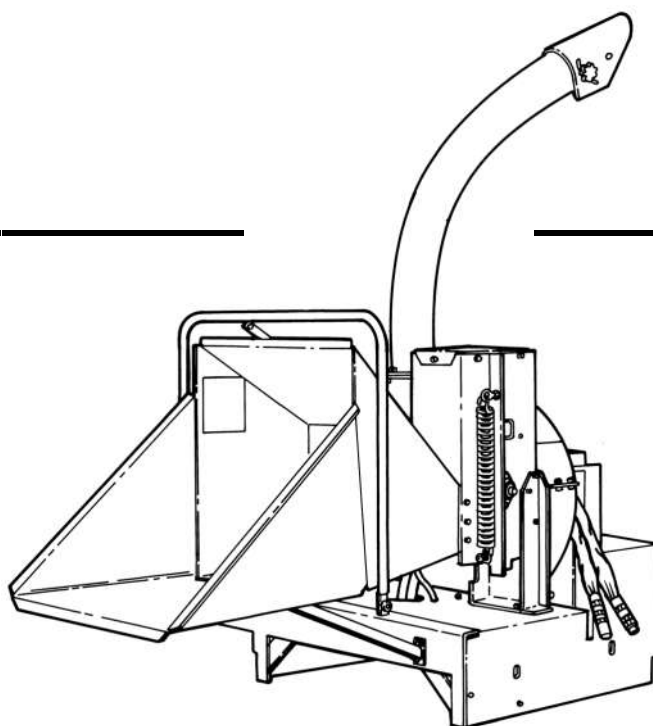



# MAINTENANCE SAFETY



## WARNING

Instructions are necessary before operating or servicing machine. Read and understand the Operation & Maintenance Manual, Operator's Handbook and signs (decals) on machine. Follow warnings and instructions in the manuals when making repairs, adjustments or servicing. Check for correct function after adjustments, repairs or service. Untrained operators and failure to follow instructions can cause injury or death.

W-2003-0903











**Safety Alert Symbol:** This symbol with a warning statement, means: "Warning, be alert! Your safety is involved!" Carefully read the message that follows.

CORRECT



B-10731a

-  Never service attachments without instructions. See Operation & Maintenance Manual and Attachment Service Manual.
-  Cleaning and maintenance are required daily.
-  Never service or adjust attachment with the engine running unless instructed to do so in manual.
-  Always lower the attachment to the ground before lubricating or servicing.
-  Avoid contact with leaking hydraulic fluid or diesel fuel under pressure. It can penetrate skin or eyes.
-  Stop, cool and clean engine of flammable materials before checking fluids.
-  Keep body, loose objects and clothing away from moving parts, electrical contacts, hot parts and exhaust.
-  Safety glasses are needed for eye protection from electrical arcs, battery acid, compressed springs, fluids under pressure and flying debris or when tools are used. Use eye protection approved for type of welding.



**Bobcat®**

## ALPHABETICAL INDEX

ATTACHMENT STORAGE AND RETURN TO SERVICE .....	10-60-1
CHIPPER BLADES .....	10-50-1
CHIPPER BLADES (WC-8A & WC-8B) .....	30-20-1
CHIPPER BLADES (WC-5A) .....	30-10-1
CHIPPER WHEEL .....	30-30-1
FEED ROLLER CONTROL .....	30-40-1
DISCHARGE CHUTE .....	30-50-1
FEED ROLLER .....	30-60-1
ELECTRICAL SCHEMATIC .....	SPEC-20-1
ELECTRICAL SCHEMATIC .....	SPEC-22-1
FEED TABLE .....	30-70-1
GLOSSARY OF HYDRAULIC SYMBOLS .....	SPEC-30-1
HYDRAULIC CONTROL VALVE (WC-5A & WC-8A) .....	20-10-1
HYDRAULIC CONTROL VALVE (WC-8B) .....	20-11-1
SHUT-OFF VALVE (WC-8B) .....	20-12-1
HYDRAULIC MOTOR (CHIPPER WHEEL) (WC-5A & WC-8A) .....	20-20-1
HYDRAULIC MOTOR (FEED ROLLER) (S/N 912900101 & ABOVE AND S/N 739500164 & ABOVE) .....	20-21-1
HYDRAULIC MOTOR (FEED ROLLER) (S/N 739500163 & BELOW) .....	20-22-1
HYDRAULIC MOTOR (CHIPPER WHEEL) (WC-8B) .....	20-23-1
HYDRAULIC PUMP (WC-8B) .....	20-24-1
HYDRAULIC SCHEMATIC (WC-5A & WC-8A) .....	SPEC-31-1
HYDRAULIC SCHEMATIC (WC-8B) .....	SPEC-32-1
INSPECTION .....	10-20-1
LOADER REMOTE ATTACHMENT CONTROL ELECTRICAL SCHEMATIC .....	SPEC-21-1
LUBRICATION .....	10-30-1
REMOTE ATTACHMENT CONTROL .....	30-80-1
SERVICE SCHEDULE .....	10-40-1
SPECIFICATIONS .....	SPEC-10-1
TROUBLESHOOTING .....	10-10-1



## CONTENTS

SERIAL NUMBER LOCATION .....	I
PREVENTATIVE MAINTENANCE .....	10-01
HYDRAULIC SYSTEM .....	20-01
MAIN FRAME .....	30-01
SPECIFICATIONS AND SCHEMATICS .....	SPEC-01

**PREVENTATIVE  
MAINTENANCE**

**HYDRAULIC  
SYSTEM**

**MAIN FRAME**

**SPECIFICATIONS  
AND SCHEMATICS**

This Attachment is **ONLY** approved for use on Bobcat Skid Steer Loaders equipped with the Bobcat Interlock Control system (BICS™). On loaders equipped with the forward pivot seat bar, the loader must also be equipped with a Remote Attachment Control Harness Kit.

**CALIFORNIA  
PROPOSITION 65 WARNING**

Diesel engine exhaust and some of its constituents are known to the State of California to cause cancer, birth defects and other reproductive harm.



## SERIAL NUMBER LOCATION

Figure 1



Always use the serial number of the chipper when requesting service information or when ordering parts. Early or later models (identification made by serial number) may use different parts, or it may be necessary to use a different procedure in doing a specific service operation **[Figure 1]**.

IDENTIFICATION AND MACHINE SIGNS (DECALS)

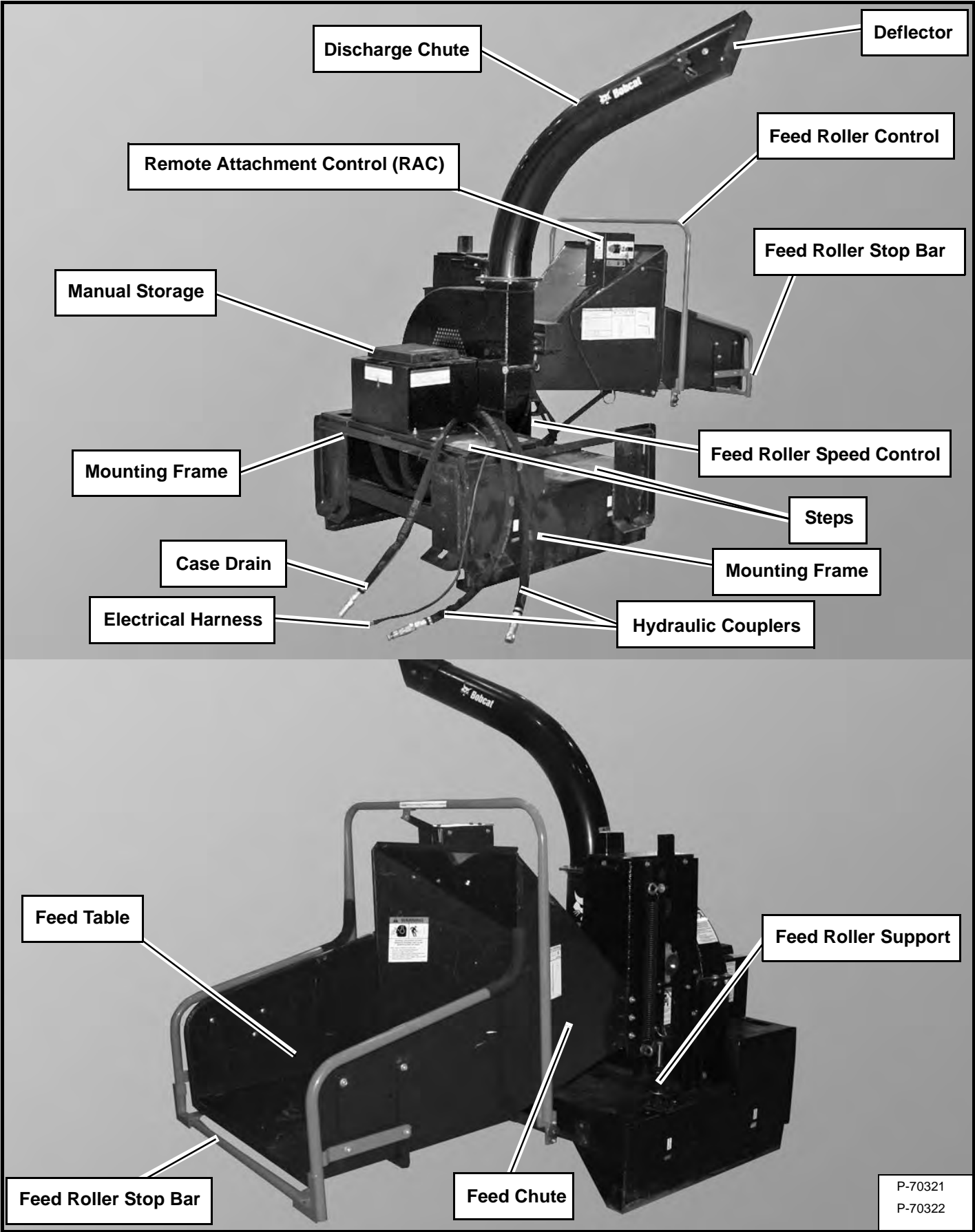

[illegible]



## PREVENTATIVE MAINTENANCE

## PREVENTATIVE MAINTENANCE

ATTACHMENT STORAGE AND RETURN TO SERVICE . . .	10-60-1
Return to Service . . . . .	10-60-1
Storage . . . . .	10-60-1
CHIPPER BLADES . . . . .	10-50-1
Setting Chipper Blade Clearance. . . . .	10-50-1
Sharpening The Chipper Blades . . . . .	10-50-2
FEED ROLLER STOP BAR ACTIVATION POINT . . . . .	10-80-1
Adjustment. . . . .	10-80-1
Description. . . . .	10-80-1
FEED ROLLER SUPPORT. . . . .	10-70-1
Procedure . . . . .	10-70-1
INSPECTION . . . . .	10-20-1
Attachment Mounting Frame . . . . .	10-20-3
Bob-Tach Inspection . . . . .	10-20-1
Feed Roller Stop Bar Activation Point . . . . .	10-20-3
Power Bob-Tach Inspection . . . . .	10-20-2
LUBRICATION . . . . .	10-30-1
Lubrication Locations. . . . .	10-30-1
SERVICE SCHEDULE . . . . .	10-40-1
5A & 8A Chipper . . . . .	10-40-1
8B Chipper. . . . .	10-41-1
TROUBLESHOOTING . . . . .	10-10-1
Chart . . . . .	10-10-1



**Bobcat®**

## TROUBLESHOOTING

### Chart



## WARNING

Instructions are necessary before operating or servicing machine. Read and understand the Operation & Maintenance Manual, Handbook and signs (decals) on machine. Follow warnings and instructions in the manuals when making repairs, adjustments or servicing. Check for correct function after adjustments, repairs or service. Untrained operators and failure to follow instructions can cause injury or death.

W-2003-0199

TROUBLESHOOTING THE CHIPPER		
PROBLEM	CAUSE	CORRECTION
Chipper does not seat properly on the Bob-Tach.	Bob-Tach wedges are not fully retracted.	Retract Bob-Tach wedges.
	Mud, dirt or stones are lodged between the Bob-Tach and the Chipper.	Remove debris between Bob-Tach and Chipper.
Loader will not start with Chipper removed. (Early models only)	Connector not installed on remote attachment control harness on the loader lift arm.	Install connector on wire harness
Loader will not start with loader key switch with Chipper installed.	Engine stop switch on Remote Attachment Control engaged.	Turn the engine stop switch clockwise to release the switch.
	Key switch on Remote Attachment Control in the run position.	Turn the key switch to the OFF position.
Loader will not start with the Remote Attachment Control key switch.	Engine stop switch on Remote Attachment Control engaged.	Turn the engine stop switch clockwise to release the switch.
	Loader key switch in the run position.	Turn the loader key switch to the OFF position.
Chipper does not turn.	No hydraulic flow	Check quick couplers connection. Check for damaged hose ends and fittings.
		Press RAC attachment ON switch.
Chipper vibrates excessively.	Chipper not correctly attached to Bob-Tach.	Check for correct mounting of the Chipper to the Bob-Tach.
	Damaged Chipper blades.	Replace damaged blades.
Chipper hard to feed	Plugged discharge chute.	Clear discharge chute.
	Dull Chipper blades.	Sharpen blades.
	Damaged Chipper blades.	Replace damaged blades.
	Improper blade clearance.	Adjust clearance.
Feed roller does not engage	Low hydraulic flow due to low engine RPM.	Move loader engine speed control lever to high engine RPM position.



## INSPECTION

### Bob-Tach Inspection

#### Hand Lever Bob-Tach

## ! WARNING

Bob-Tach wedges must extend through the holes in attachment. Levers must be fully down and locked. Failure to secure wedges can allow attachment to come off and cause injury or death.

W-2102-0588

Figure 10-20-1

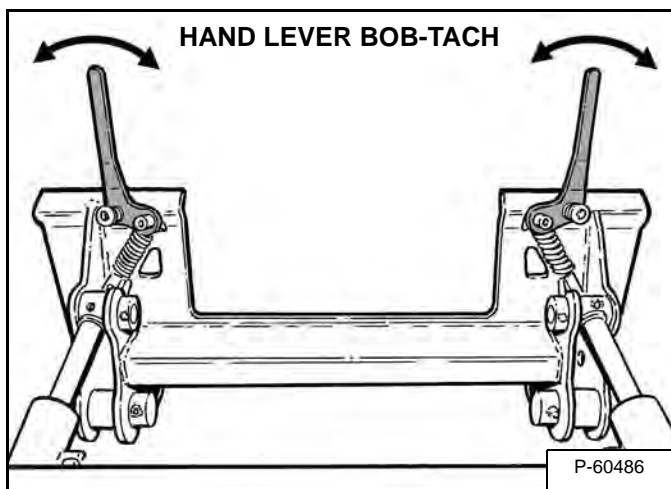

Move the Bob-Tach levers to engage and disengage the wedges [Figure 10-20-1]. The levers and wedges must move freely.

Figure 10-20-2

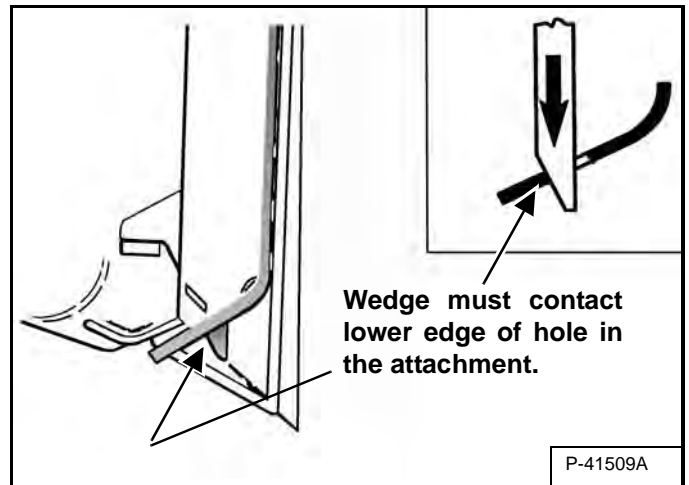

The wedges must extend through the holes in the attachment mounting frame [Figure 10-20-2].

If the wedge does not contact the lower edge of the hole [Figure 10-20-2], the attachment will be loose and can come off the Bob-Tach.

Figure 10-20-3

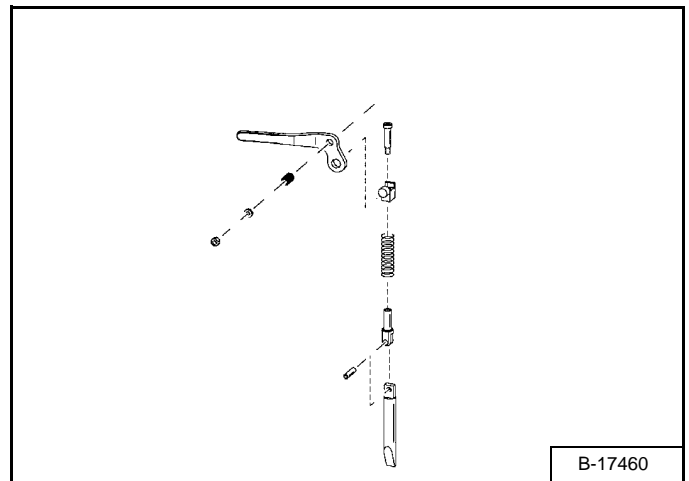

Inspect the mounting frame on the attachment and the Bob-Tach, linkages and wedges for excessive wear or damage [Figure 10-20-3]. Replace any parts that are damaged, bent or missing. Keep all fasteners tight.

Look for cracked welds. Contact your Bobcat dealer for repair or replacement parts.

Lubricate the wedges. (See the correct loader Operation & Maintenance Manual for *LUBRICATION OF THE BOBCAT LOADER*.)

## INSPECTION (CONT'D)

### Power Bob-Tach Inspection

*Power Bob-Tach Option*

# ! WARNING

Bob-Tach wedges must extend through the holes in attachment. Levers must be fully down and locked. Failure to secure wedges can allow attachment to come off and cause injury or death.

W-2102-0588

Figure 10-20-4

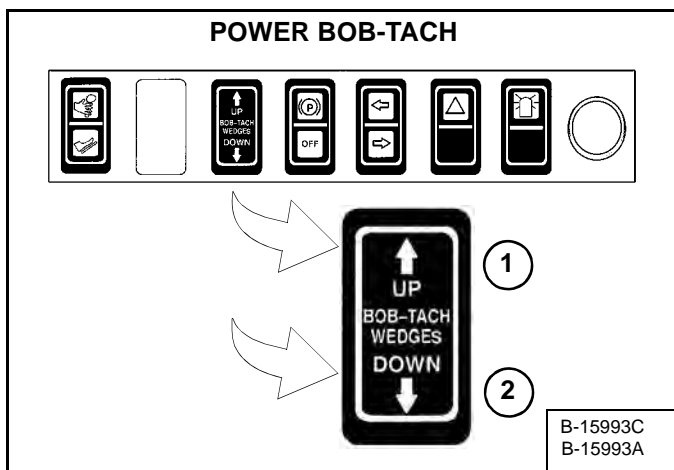
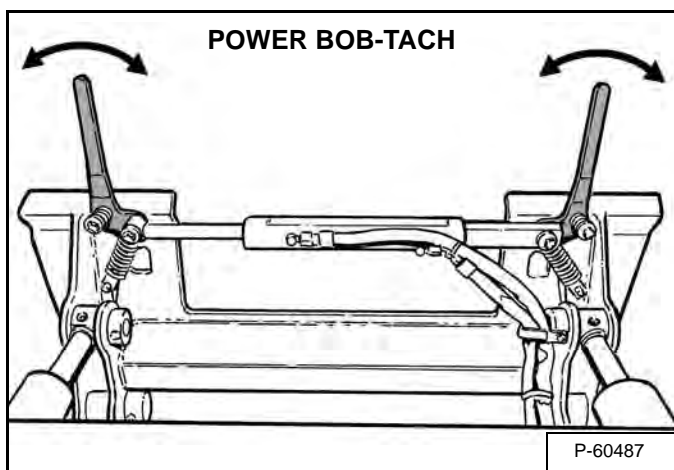

Figure 10-20-5



Push and hold the BOB-TACH WEDGES UP switch (Item 1) until the wedges are fully raised. Push and hold the BOB-TACH WEDGES DOWN switch (Item 2) [Figure 10-20-4] until the wedges are fully lowered.

The levers and wedges must move freely [Figure 10-20-5].

Figure 10-20-6

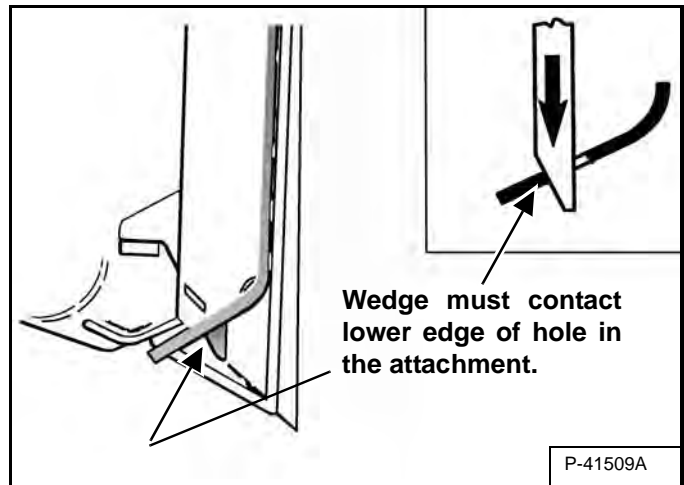

The wedges must extend through the holes in the attachment mounting frame [Figure 10-20-6].

If the wedge does not contact the lower edge of the hole [Figure 10-20-6], the attachment will be loose and can come off the Bob-Tach.

Figure 10-20-7

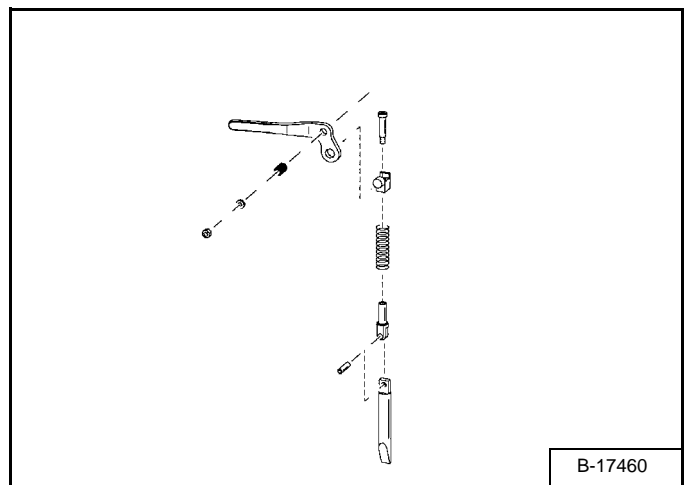

Inspect the mounting frame on the attachment and the Bob-Tach, linkages and wedges for excessive wear or damage [Figure 10-20-7]. Replace any parts that are damaged, bent or missing. Keep all fasteners tight.

Look for cracked welds. Contact your Bobcat dealer for repair or replacement parts.

Lubricate the wedges. (See the correct loader Operation & Maintenance Manual for *LUBRICATION OF THE BOBCAT LOADER*.)

**Dear**

**Thanks very much for your visiting and  
patience.**

**Want to get more information,**

**Please click here, Go back to the page.**

**After your payment, you will have instant access to  
your download.**

**The Download Link will also be sent to your e-mail.**

**You will get the complete manual**

**Have any questions**

**please write to me**

**[admin@servicemanualperfect.com](mailto:admin@servicemanualperfect.com)**